

Integrated Acute Services Building Addition

The NSW Government is partnering with UNSW Sydney to strengthen the Randwick Hospitals Campus through the integration of health education, training and research with acute healthcare services.

Under the latest partnership initiative, the recently approved Prince of Wales Acute Services Building is proposed to be extended over Hospital Road. This will enable clinical innovation and research, biomedical engineering, and clinical translational research laboratories to be collocated directly alongside clinical staff providing acute healthcare services.



Artist's Impression of the IASB Addition looking south

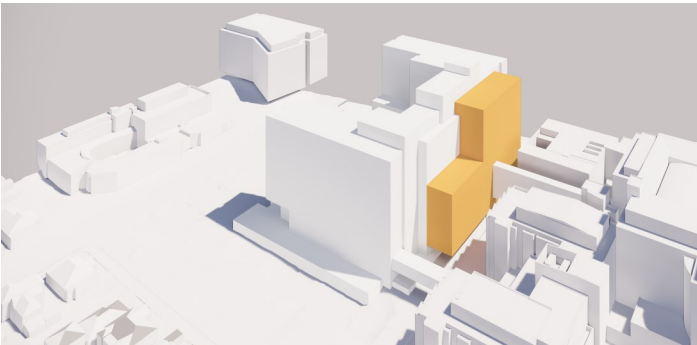

Acute Services Building with Addition highlighted in yellow looking northwest

Delivering for the future

We operate in a dynamic environment in which the healthcare needs of our community continue to change and evolve. The past 20 years has seen the complexity and range of health services delivered at our hospitals continue to grow.

The IASB Addition will expand our capacity to innovate by providing collaborative spaces that will drive innovative approaches to patient assessment and treatment, and respond to the needs of our community now and into the future.

Why integrate education, training and research with health services?

The proposed Integrated Acute Services Building (IASB) Addition provides around 5,000 square metres of additional space over ten floors. The IASB Addition is approximately ten per cent of the size of the approved Acute Services Building and would accommodate clinical research, education and training alongside health services.

Significant planning between the Randwick Health and Education Precinct partners has informed the IASB Addition and will deliver significant new health research and education outcomes that require the direct collocation of education, research and training with the clinical functions in the new hospital building.

The IASB Addition project includes the lowering of Hospital Road which will facilitate future developments to the north and set up the first stage of a broad pedestrian zone linking Botany Street, High Street and the existing Randwick Hospitals Campus.



For more information:



randwickcampusredevelopment.health.nsw.gov.au



randwickcampusredevelopment@health.nsw.gov.au



1800 571 866

The Integrated Acute Services Building Addition will contribute to positioning the Precinct at the forefront of clinical research and innovation, benefiting patients, staff and the community

Improving patient care and delivering benefits to the local community

The IASB Addition will benefit patients, their families and the local community through embedding education, training and research initiatives with health services and strengthening links between clinicians and researchers. These interactions will provide important insights into the way healthcare is delivered as well as an opportunity to learn and improve the way healthcare is provided.

Holistic, multidisciplinary collaboration will facilitate the rapid translation of clinically informed research, innovation and education excellence to patient care; leading to better approaches to assessment, treatment planning, therapies and care coordination.

As well as improving health services to our local communities, the seamless physical and working integration between the hospitals and UNSW will enable us to compete at the forefront of health research and education internationally. This will attract outstanding clinicians, health professionals and academics, drive better healthcare outcomes for patients and generate economic benefits for the community.

More opportunities for staff and students

By strengthening the health, research and education presence at the Randwick Hospitals Campus, the IASB Addition will enable more collaboration with UNSW in an environment that is evolving, innovative and forward thinking, attracting global experts and giving staff and students more immediate insights and access to research and education.

In turn, this will expand opportunities for career and academic advancement, providing further opportunities for staff and students to learn and improve skills, enhancing the education experience for the next generation of healthcare professionals.

This will allow the Campus to attract and retain a highly skilled and engaged workforce, provide effective and meaningful learning experiences for staff and students and deliver education and research units for a number of clinical disciplines.



For more information:

 randwickcampusredevelopment.health.nsw.gov.au

 randwickcampusredevelopment@health.nsw.gov.au

 1800 571 866