

Integrated Acute Services Building Addition

The NSW Government is partnering with UNSW Sydney to strengthen the Randwick Hospitals Campus through the integration of health education, training and research with acute healthcare services.

Under the latest partnership initiative, the recently approved Prince of Wales Acute Services Building is proposed to be extended over Hospital Road. This will enable clinical innovation and research, biomedical engineering, and clinical translational research laboratories to be colocated directly alongside clinical staff providing acute healthcare services.

This extension will bring clinicians, researchers, educators and public health together and will drive the rapid translation of clinically informed research, innovation and educational excellence to improve patient care at Randwick.

Changes to transport and access

Restricted access via Magill Street

A number of options have been considered to mitigate the potential traffic impacts of closing Hospital Road to through traffic. Traffic and transport investigations, modelling by independent experts and feedback from stakeholders support the reopening of Magill Street as the preferred solution to manage traffic volumes on Barker Street and provide an alternative for traffic access to Hospital Road, the hospitals car park and loading docks.

The proposed access via Magill Street would be supported by the installation of boom gates at the intersection of Magill Street and Hospital Road. The boom gates will block access to Hospital Road from Magill Street between 10pm and 7am and mitigate the potential impact of traffic noise on local residents. This change will be signposted at the entry to Magill Street from Botany Street.



Artist's Impression of the Integrated Acute Services Building looking south

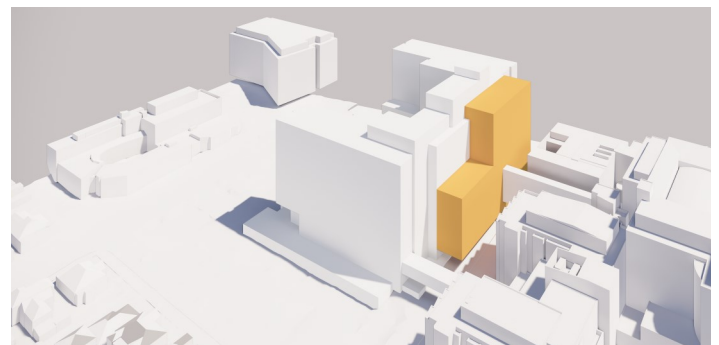

Acute Services Building with Addition highlighted in yellow

Lowering and closure of Hospital Road

To enable construction of the Integrated Acute Services Building (IASB) Addition as well as future-proofing for the recently announced Sydney Children's Hospital Stage 1, Comprehensive Children's Cancer Centre and the Health Translation Hub, in-ground engineering services will need to be diverted and around an 80 metre section of Hospital Road lowered and closed to through traffic.

Vehicle access to the hospitals car park would be maintained from the south via Barker Street and Magill Street during limited hours.

IASB Addition Traffic and Access Factsheet - August 2019

Artists impression looking north



The closure of Hospital Road would allow the creation of an extensive pedestrian zone that would extend through future buildings and is consistent with the vision for the Health and Education Precinct as an interconnected and seamless pedestrian environment

Parking

UNSW staff will work between the UNSW Campus and the IASB and will continue to park at the UNSW Campus. UNSW students will access the expanded Health and Education Precinct in line with UNSW's current active transport policies.

Pedestrian and vehicle access

As already approved for the Acute Services Building, vehicle access for drop-off and pick-up will be via the Acute Services Building's main entrance on Botany Street and will be connected by a new signalised intersection. A secondary entry point, providing direct pedestrian access to the IASB Addition, is proposed.

Pedestrians moving between the IASB and UNSW will use the pedestrian crossings included at the traffic lights. Pedestrian connection to the existing Randwick Hospitals Campus will be facilitated via new link bridges in two locations over Hospital Road as approved for the Acute Services Building.

Growing transport options

A key focus of all planning, including transport planning, for the Randwick Campus Redevelopment is putting patients and their families first. Randwick Health and Education Precinct partners continue to work with the NSW Government to ensure current and future transport and access needs are considered and managed in a coordinated way. This includes public transport, walking and cycling corridors and car parking.

The Randwick Hospitals Campus Green Travel Plan sets out strategies to meet future Campus travel demand. The Plan also leverages the growth in public transport that will result from the new integrated bus and light rail network as well as Campus initiatives to more effectively utilise existing car parking and grow staff carpooling, walking and cycling.

As part of the Redevelopment's commitment to growing transport options, additional bicycle parking and end of trip facilities will be delivered as part of the Acute Services Building and will be available to staff working in the IASB.

For more information:



randwickcampusredevelopment.health.nsw.gov.au



1800 571 866



randwickcampusredevelopment@health.nsw.gov.au