

Planning update

This information factsheet has been produced as a part of our commitment to provide proactive information to the local community and campus stakeholders about the new Acute Services Building and Randwick Campus Redevelopment. It is written to allow you to understand progress and to ask questions well in advance of construction activities. As planning progresses, further information will be made available across a range of topics.

We encourage you to get in touch if you have any questions or feedback.

Please call 1800 571 866 or email randwickcampusredevelopment@health.nsw.gov.au.

Planning progresses

Building a new hospital building takes many years. Expected to open in 2022, the new Acute Services Building will link into the heart of the four hospitals located at Randwick and to future buildings accommodating health-related education, training and research activities on campus.

Where are we up to?

Concept Design for the Acute Services Building was completed in June 2017 providing early information on the location of the new building and how it will share services with the current hospitals.

Schematic Design, which looks at how rooms and services within individual wards and departments relate to each other and how services 'flow' between new and existing infrastructure, is currently underway and is expected to be finalised in early 2018.

Project timeline:

Early 2015 to Mid 2017	• Early planning outlines the health needs of the campus into the future
June 2017	• Decision to expand the Randwick Hospitals' Campus west, \$720m funding commitment and Concept Design released
Mid 2017 to mid 2018 Ongoing planning	• Schematic Design phase commences • Utility and geotechnical investigations start • Preparation of planning documents • Ongoing engagement with clinicians and hospital staff, consumers and the community • Request for Secretary's Environmental Assessment Requirements (SEARs) to be made • Development Application for site preparatory works to be lodged
Mid 2018 Community consultation and early works	• Project information released for community consultation and planning assessment • Opportunity to have your say and talk with members of the project team at drop-in community information sessions • Early site preparatory works may commence
From late 2018 Construction	• Construction commences on the new Acute Services Building including direct links into existing hospital buildings • New Acute Services Building is expected to open in 2022

Planning assessment

A State Significant Development Application for the Acute Services Building will be lodged with NSW Department of Planning and Environment in 2018. As a part of the assessment process, an Environmental Impact Statement (EIS) will be published for community consultation.

Drop-in community information sessions will be held and you will be able to ask questions of the project team and provide feedback on the proposal.

The EIS will outline the proposal and provide the outcomes of the investigations into:

- Traffic and access
- Amenity
- Structural and civil engineering
- Air space considerations
- Building code and disability access
- Noise, dust, vibration, construction management
- Other environmental considerations.

For more information:

Call 1800 571 866 Email randwickcampusredevelopment@health.nsw.gov.au
 Visit www.randwickcampusredevelopment.health.nsw.gov.au

What facilities will be in the new Acute Service Building?

- An adult new emergency department, intensive care unit and medical assessment unit
- Extra beds and contemporary patient facilities
- New operating theatres for the campus
- Helipad, ambulance bays, loading dock and ED access and drop-off
- Multiple connections back into the Randwick Hospitals' Campus including a pedestrian bridge over Hospital Road and another multilevel bridge for internal patient movements and logistics
- Integrated education, training and research facilities and new retail spaces
- A new Hospital square with vehicle access from Botany Street and public drop-off area
- Upgraded road infrastructure at Magill Street and Botany Street
- Building services infrastructure and connections to utilities
- Stormwater drainage infrastructure including on-site detention
- Landscaping and outdoor areas.

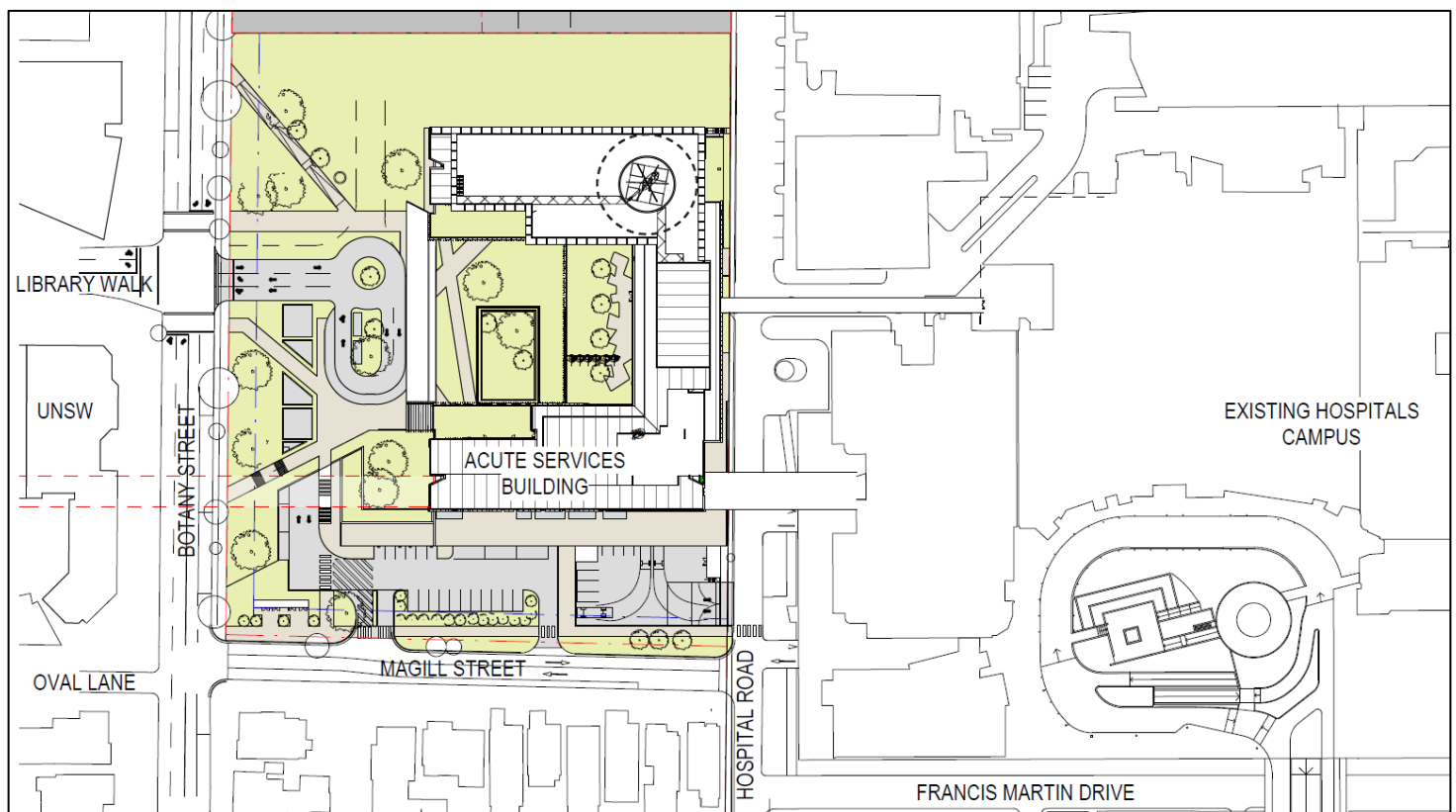

***Indicative draft for consultation purposes only.** **Feedback will be sought during the formal public consultation period

If you have any questions or feedback please call 1800 571 866 or email randwickcampusredevelopment@health.nsw.gov.au



For an interpreter, call 131 450 and ask them to call 02 9978 5402

If you need an interpreter, please call the Translating and Interpreting Service (TIS National) on 131 450 and ask them to phone Randwick Campus Redevelopment on 1800 571 866.

For more information:

Call 1800 571 866

Email randwickcampusredevelopment@health.nsw.gov.au

Visit www.randwickcampusredevelopment.health.nsw.gov.au