

## Newsfeed No. 42

October-November 2022



### We have the keys! Acute Services Building is 'handed over' to SESLHD



#### In this edition:

- ✓ Keys to the ASB handed over
- ✓ The first service to move into the ASB
- ✓ New medication tech a game-changer
- ✓ Early bird tours of the new End of Trip facility
- ✓ Sydney Children's Hospital redevelopment team attend 'Operation Art'
- ✓ An update on refurbishments at the Royal
- ✓ Faces of the Precinct

**On Thursday 6 October, the new Prince of Wales Hospital (POWH) Acute Services Building (ASB) was handed over to South Eastern Sydney Local Health District (SESLHD), in preparation to open to patients in early 2023.**

The ASB is the first stage of the Randwick Campus Redevelopment and the catalyst project for expanding world-class health, research and education facilities at the Randwick Health & Innovation Precinct.

SESLHD and POWH executives joined the project team to tour the building, which is undergoing a complex commissioning phase.

Construction works on the ASB commenced in 2018 and is the first major upgrade to POWH in 25 years.

The ASB will deliver state-of-the-art infrastructure to support new and innovative approaches to healthcare and provide staff with purpose designed and built facilities that support contemporary clinical practice.

POWH are now in the hospital operational commissioning phase, ahead of the building opening in early 2023. Activities over the coming months include installation of furniture, equipment and stock, training and orientation for staff, and clinical cleans.

*Pictured: POWH Executive in the ASB front entrance the day the keys were handed over*

For more information:

 [randwickcampusredevelopment.health.nsw.gov.au](https://randwickcampusredevelopment.health.nsw.gov.au)

 [randwickcampusredevelopment@health.nsw.gov.au](mailto:randwickcampusredevelopment@health.nsw.gov.au)

 1800 571 866



## THE COUNTDOWN IS ON

### PRINCE OF WALES HOSPITAL ACUTE SERVICES BUILDING

#### Acute Services Building is 'handed over' to SESLHD (continued)

##### Changed access to the ASB for POWH staff

Staff involved in hospital operational commissioning will now access the ASB through the new public link bridge on level 0 via the Royal Hospital for Women (RHW).

An ASB registration desk has been established near the RHW executive offices.

All staff accessing the ASB are required to sign in and out upon entry and exit. This measure is in place to maintain safety and security of staff and equipment while working within the building.

##### Book in a general staff tour!

Opportunities for all staff to book familiarisation tours ahead of opening is available throughout November 2022.

##### [Click here to register.](#)

Alongside commissioning activities, external landscaping and civil works continue on site, together with construction of the UNSW integrated extension on the eastern side of the ASB.

The 2022-23 NSW State Budget committed an additional \$82.5 million to fit out additional operating theatres and associated recovery spaces, an ICU pod and two additional inpatient units within the ASB. Planning for these additional works is underway, and related construction will continue into late 2024.

We thank you for your continued patience as we work to deliver this important facility for SESLHD, POWH and the local community.



*Pictured: SESLHD Chief Executive, Tobi Wilson with Health Infrastructure RCR Senior Project Director, Gavin Thompson; the team walk across the new public link bridge for the first time*

For more information:

 [randwickcampusredevelopment.health.nsw.gov.au](https://randwickcampusredevelopment.health.nsw.gov.au)

 [randwickcampusredevelopment@health.nsw.gov.au](mailto:randwickcampusredevelopment@health.nsw.gov.au)

 1800 571 866



## THE COUNTDOWN IS ON

### PRINCE OF WALES HOSPITAL ACUTE SERVICES BUILDING

#### Sterilising services team the first to move into the new building

**The Prince of Wales Hospital Central Sterilizing Services Department (CSSD) will be moving into its fresh new facility in the ASB on Monday 14 November, where the department will continue processing thousands of items every day to clean behind the scenes.**

With the busy task of keeping reusable medical equipment, instruments and tools clean, the service cleans and sterilises an impressive number of items every day. Using large instrument washers and steam sterilisers, the items go through a process of being cleaned, checked, documented, wrapped and then placed into the sterilising machines before being stored or reissued as required.

The new state-of-the-art CSSD will be the first department to go live in the ASB. This follows extensive design consultations and inspections with CSSD staff since mid-2017, making this a significant milestone for the service and staff members involved in project phases.

*Pictured: CSSD Production Coordinators, Nanuma Lipitua & Khathi Rathod setting up in their new and improved space in the ASB*

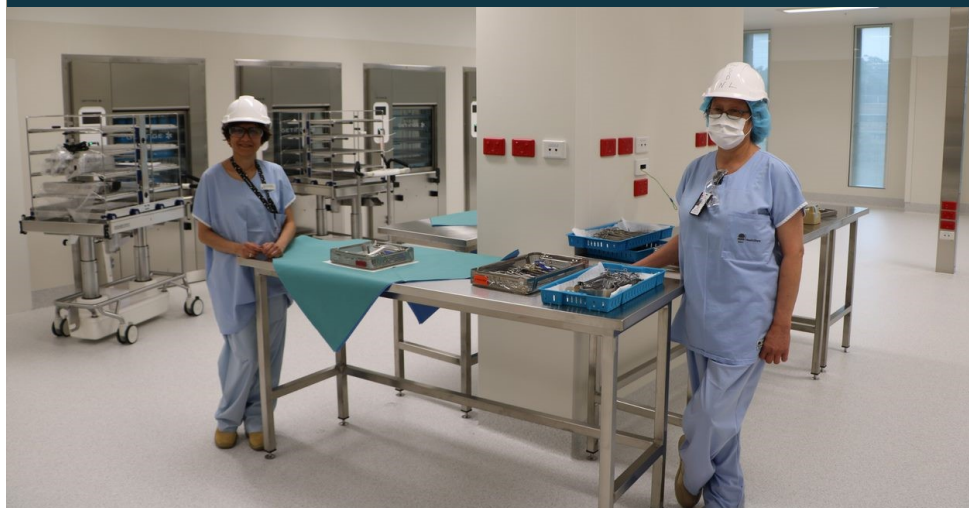

“The department has been designed with expansion as a central theme,” said Tim Cole, Manager, Randwick Campus Central Sterilizing Services Department.

“The new department is substantially larger and equipped with more technically advanced processing technologies and engineering infrastructure. This will enable the reprocessing of a far wider range of contemporary reusable medical equipment for the entire campus and off-campus affiliates.”

Having occupied one central location in the Campus Centre Building since July 1997, the existing CSSD has reprocessed more than 10 million sterile packages over the past 25 years.

“The new CSSD will be one of the largest and most advanced reusable medical equipment reprocessing departments in the southern hemisphere and will enable the Randwick Health & Innovation Precinct to align with international standards of best practice.”

Coupled with the use of new technology, is adoption of real-time electronic tracking of all registered reusable medical equipment, enabling active interfacing with electronic patient management systems, billing, and logistics platforms.

In the ASB, CSSD is located on level 2, just above theatres.

Connecting both departments is an internal hoist to make the transportation of instruments quick and easy.

For more information:

 [randwickcampusredevelopment.health.nsw.gov.au](http://randwickcampusredevelopment.health.nsw.gov.au)

 [randwickcampusredevelopment@health.nsw.gov.au](mailto:randwickcampusredevelopment@health.nsw.gov.au)

 1800 571 866





## THE COUNTDOWN **IS ON**

### PRINCE OF WALES HOSPITAL ACUTE SERVICES BUILDING

#### New medication technology saves time and improves patient safety

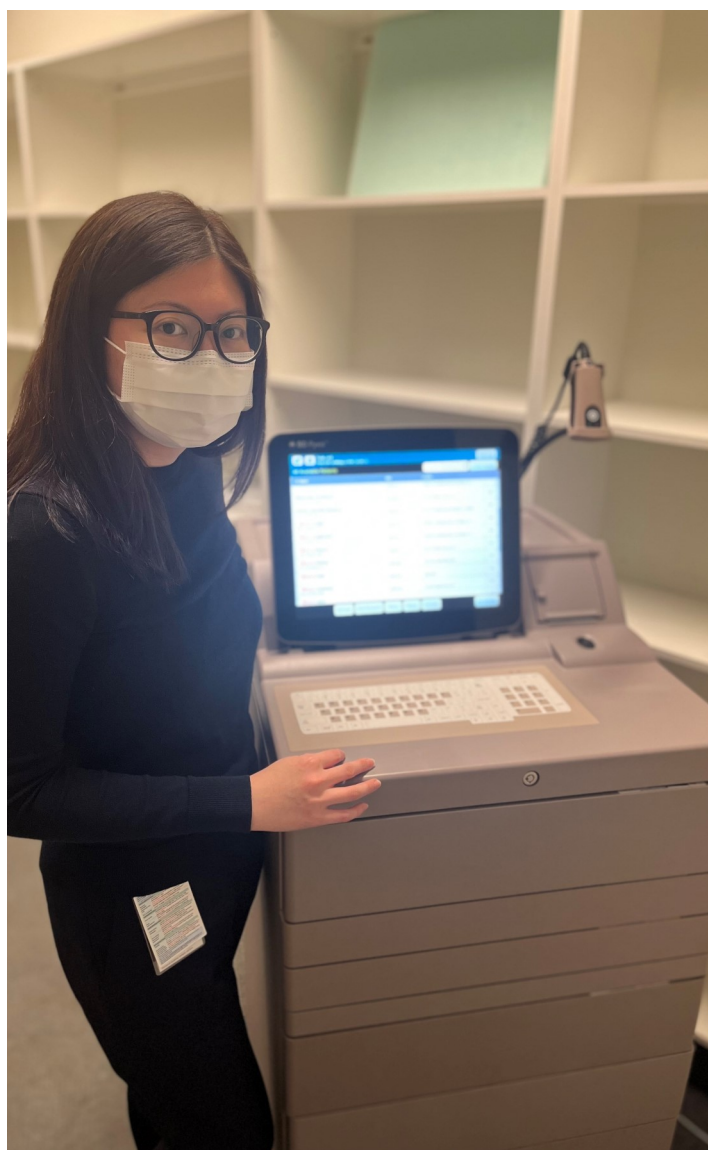

**The soon to open ASB brings an abundance of opportunities to Prince of Wales Hospital, with the introduction of new models of care, innovative new technology and new job opportunities.**

Meet Automation and Distribution Pharmacist, Sarah Lam, who has commenced in a newly created position responsible for embedding a game-changing medication distribution technology known as Automatic Dispensing Cabinets (ADCs).

Working closely with Prince of Wales Hospital nursing, pharmacy and medical staff, as well as the medical technology provider, Sarah and the team will pilot and then embed the ADCs in the ASB and parts of the existing hospital, driving efficiency and enhancing patient safety.

“The introduction of the ADCs will have such a positive impact on staff and patients,” said Sarah.

“ADCs provide better visibility of medication inventory on each ward and assist in getting the right medication to the right patient at the right time, freeing up our nurses and pharmacists to focus on patient-centric activities.”

Sarah Lam, Automation and Distribution Pharmacist at Prince of Wales Hospital

*Pictured: Sarah Lam with a prototype of the ADCs*

For more information:



[randwickcampusredevelopment.health.nsw.gov.au](https://randwickcampusredevelopment.health.nsw.gov.au)



[randwickcampusredevelopment@health.nsw.gov.au](mailto:randwickcampusredevelopment@health.nsw.gov.au)



1800 571 866



## THE COUNTDOWN IS ON

### PRINCE OF WALES HOSPITAL ACUTE SERVICES BUILDING

#### New medication technology saves time and improves patient safety (continued)

##### How do ADCs work?

Data-driven medication management allows real time tracking of stock levels of critical medications across the hospital.

The automated process allows staff to predict demand and prevent unnecessary stock-outs based on real time inventory.

ADCs support nurses in accurate medication selection via integration with eMR and patient profiling.

The time saved can be redirected into face-to-face patient care, making it invaluable and rewarding for nurses and patients alike.

“With the help of the ADCs, there's more time for bedside care because nurses spend less time tracking down medication or safe keys,” said Sarah.

Once the ADCs are rolled out, pharmacy will be responsible for ward imprest top-ups and ensuring wards have all their imprest stock on hand and accurately refilled.

ADCs provide a more efficient way to manage medication expiries and complement existing strategies in medication waste reduction.

ADCs also bolster the security of medication within locking bins, minimising the potential for diversion.

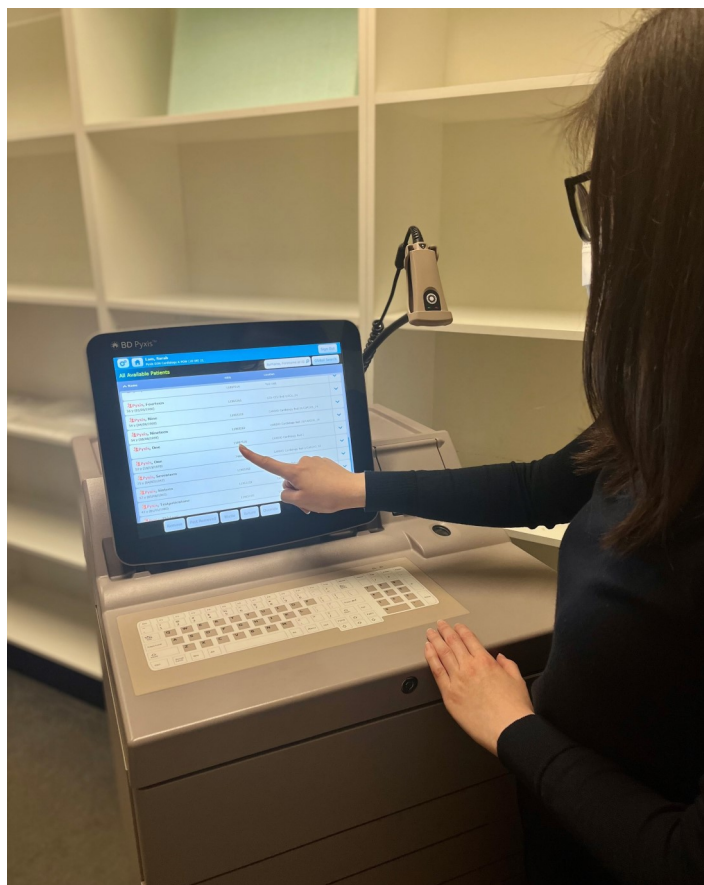

“I am looking forward to seeing how the new facilities and technology come together to support our multidisciplinary team in trialling innovative ideas which can advance and improve the way we deliver care to our patients,” said Sarah.

For more information:

 [randwickcampusredevelopment.health.nsw.gov.au](http://randwickcampusredevelopment.health.nsw.gov.au)

 [randwickcampusredevelopment@health.nsw.gov.au](mailto:randwickcampusredevelopment@health.nsw.gov.au)

 1800 571 866



## Avid cyclists check out the new End of Trip facility

**With construction of the Randwick campus End of Trip facility almost complete, staff who have registered to pilot the new facility were invited on a sneak peek tour.**

Approximately 50 staff from across SESLHD and the Sydney Children's Hospital Network will be trialling the facility as part of a pilot program over the next few months.

The End of Trip facility is located in the campus car park and has changerooms, showers, toilets, lockers, bike racks, airing cupboards and ironing facilities.

The long-awaited facility will improve the experience of staff who cycle or walk to and from work, and those who exercise before, after or during their shift.

The facility will become fully operational and open to all staff working at Randwick from 2023.

*Pictured: Members of the pilot program tour the facility; bike racks and lockers in the new facility*

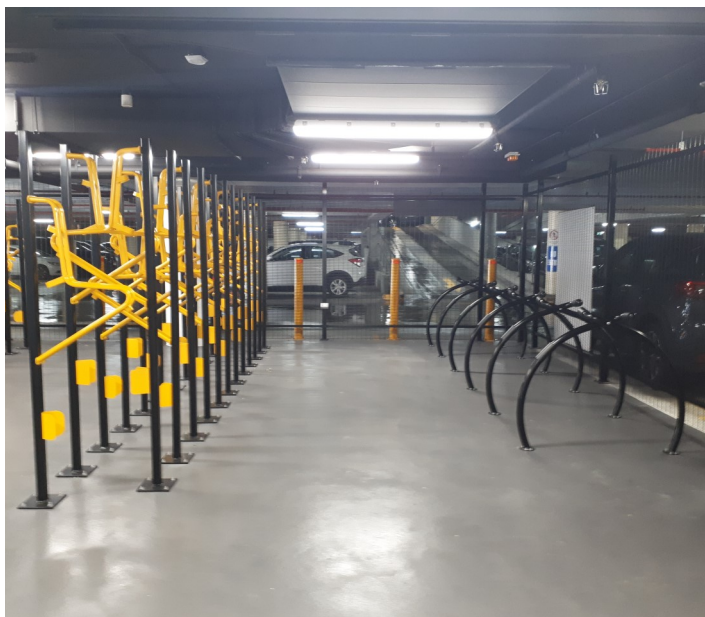

For more information:

 [randwickcampusredevelopment.health.nsw.gov.au](https://randwickcampusredevelopment.health.nsw.gov.au)

 [randwickcampusredevelopment@health.nsw.gov.au](mailto:randwickcampusredevelopment@health.nsw.gov.au)

 1800 571 866



## Sydney Children's Hospital redevelopment on show at art event

**Former patients and their families were among community members who visited the Sydney Children's Hospitals Network (SCHN) redevelopment stall at this year's Operation Art event.**

Every year, schools across NSW take part in Operation Art – an initiative of The Children's Hospital at Westmead (CHW) in association with the NSW Department of Education.

The artworks of children of all ages are displayed in an exhibition at the Armory Gallery at Sydney Olympic Park.

The SCHN redevelopment team raised awareness about the Westmead and Randwick construction projects to the 500+ people in attendance at the event – including Ally and her son Oscar. They spoke about what they're excited about for the new hospital buildings.

"Oscar was in hospital as a newborn and later as a baby," said Ally. "To have meaningful spaces and creating positive memories (during) a really hard time will be hugely beneficial."

*Pictured: The Operation Art event including CHW patient, Oscar with his family (top right)*

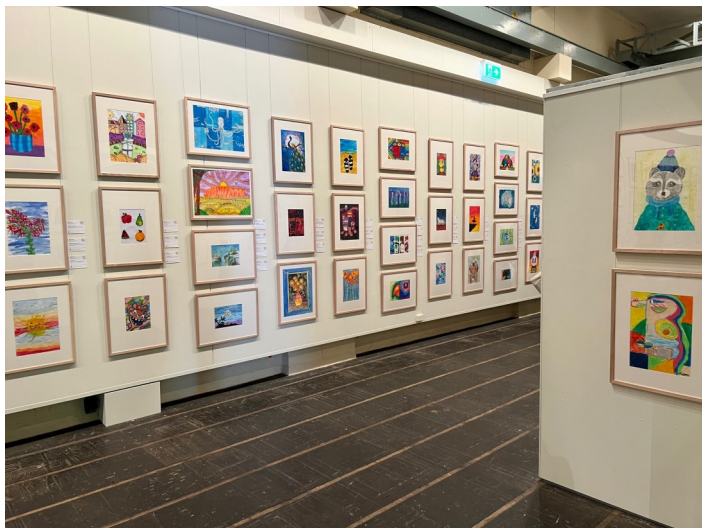

For more information:

 [randwickcampusredevelopment.health.nsw.gov.au](https://randwickcampusredevelopment.health.nsw.gov.au)

 [randwickcampusredevelopment@health.nsw.gov.au](mailto:randwickcampusredevelopment@health.nsw.gov.au)

 1800 571 866

### An update on refurbishments at the Royal Hospital for Women

**We're on the home stretch for construction on level 0 of the Royal Hospital for Women.**

The public link bridge connecting the campus to the ASB is now complete!

A refurbished, widened corridor provides direct access for staff entering the ASB for commissioning activities, while a separate entrance maintains public access to the Royal Hospital for Women's reception area.

Final touches on the refurbishment works include:

- ✓ A refurbishment of the Social Work department on level 3 including a new reception, larger meeting areas and office spaces
- ✓ Final finishes to the Maternity Outpatients Department consult rooms, dirty utility room and storeroom
- ✓ Installation of new signage in refurbished spaces, including the link bridge.

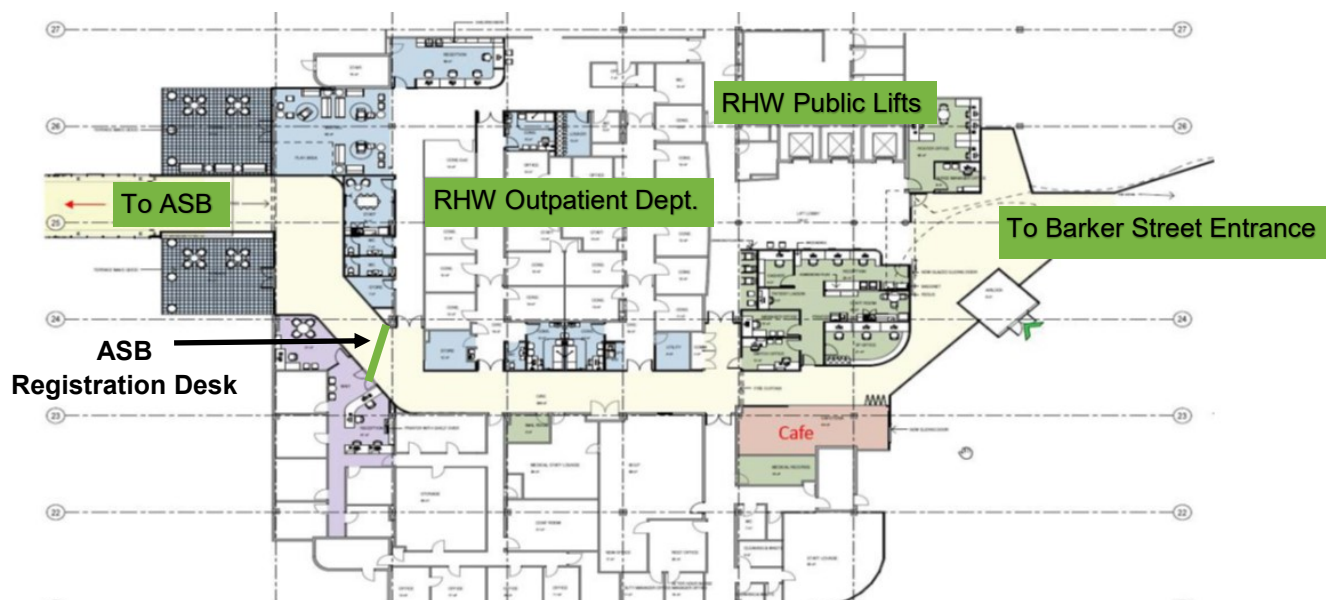

**Find out more about the construction activity happening at the  
Randwick Campus Redevelopment  
through the monthly construction notice**



The Randwick Campus Redevelopment team publishes a monthly construction notice summarising activities underway across the broader redevelopment.

**Scan the QR code or access the notices from the project website at:**

[www.randwickcampusredevelopment.health.nsw.gov.au/notices](http://www.randwickcampusredevelopment.health.nsw.gov.au/notices)



For more information:

 [randwickcampusredevelopment.health.nsw.gov.au](http://randwickcampusredevelopment.health.nsw.gov.au)

 [randwickcampusredevelopment@health.nsw.gov.au](mailto:randwickcampusredevelopment@health.nsw.gov.au)

 1800 571 866



### Faces of the Precinct: Five minutes with Brooke Selby

#### Q: What is your role in the Randwick Health & Innovation Precinct (RHIP) team?

**A:** As the Precinct Program Manager, my role is to lead and monitor the delivery of projects across the precinct. In practice, this involves:

- ✓ Attending a number of meetings and working groups to ensure I have oversight of projects and activities happening across the precinct
- ✓ Supporting project leads to initiate and scope new projects
- ✓ Identifying and escalating issues and risks
- ✓ Identifying strategic opportunities for service development and innovation
- ✓ Facilitating the annual strategic planning process.

Whilst I manage and oversee a number of projects across the precinct, I will play a more active role within the virtual health and clinical services portfolios over the coming months.

#### Q: What attracted you to this type of work?

**A:** Throughout my career in health, I have observed how a siloed approach to healthcare ultimately creates disjointed work processes, increased costs and adverse outcomes for patients.

In order to deliver high value patient centred care we must leverage opportunities and partner with organisations to maximise our efforts.

I was attracted to this work because I really believe the Randwick Health & Innovation Precinct demonstrates how best to integrate health, research and education to improve the health outcomes of our community.

#### Q: What excites you most about the precinct?

**A:** What excites me most about the precinct is the sheer number of opportunities to collaborate and solve real life health issues, both current and emerging.



#### Q: What do the next six months look like?

**A:** Over the next six months the team will continue to execute the projects in the 22/23 operational plan as well as participate in a number of workshops to plan and prioritise work for the next financial year.

For me personally, I am hoping to establish strong professional relationships with the partners and key stakeholders across the precinct. In terms of projects, I'm looking forward to progressing work in the virtual health space as this is an area which I think has huge potential for each of the partners and the community.

*Pictured above: Brooke Selby, Precinct Program Manager for the Randwick Health & Innovation Precinct*

**The Randwick Health & Innovation Precinct brings together world-class education, research and healthcare organisations to address real-world problems across the lifespan, from newborns to centenarians.**