

**RANDWICK CAMPUS REDEVELOPMENT  
PRINCE OF WALES  
UNSW ADDITION & LOWERING HOSPITAL ROAD  
SSD NUMBER: 10339  
Construction Compliance Report  
Condition B29**



STRICTLY CONFIDENTIAL

Randwick Campus Redevelopment

Table 1 - Version Control

Rev	Date	Details / Description	
01	10/12/2020	Randwick Campus Redevelopment	Clare Hall (review RY)
02	23/3/21	Randwick Campus Redevelopment Update March 2021	Leah Cleary (review RY)

## Compliance Report Declaration Form

Compliance Report Declaration Form

Project Name	Randwick Campus Redevelopment
Project Application Number	SSDA 10339
Description of Project	Prince of Wales : Addition to ASB & Lowering of Hospital Road
Project Address	Prince of Wales Hospital Campus - Part Lots 4-11 DP 13995, Part Lot 1 DP870720
Proponent	Health Infrastructure
Title of Compliance Report	Construction Compliance Report : #2 : Dec 2020 to Mar 2021
Date	30th March 2021

I declare that I have reviewed relevant evidence and prepared the contents of the attached Compliance Report and to the best of my knowledge:

- the Compliance Report has been prepared in accordance with all relevant conditions of consent,
- the Compliance Report has been prepared in accordance with the Compliance Reporting Post Approval Requirements,
- the findings of the Compliance Report are reported truthfully, accurately and completely,
- due diligence and professional judgment have been exercised in preparing the Compliance Report, and
- the Compliance Report is an accurate summary of the compliance status of the development.

Notes:

- Under section 10.6 of the Environmental Planning and Assessment Act 1979 a person must not include false or misleading information (or provide information for inclusion in) a report of monitoring data or an audit report produced to the Minister in connection with an audit if the person knows that the information is false or misleading in a material respect. The proponent of an approved project must not fail to include information in (or provide information for inclusion in) a report of monitoring data or an audit report produced to the Minister in connection with an audit if the person knows that the information is materially relevant to the monitoring or audit. The maximum penalty is, in the case of a corporation, \$1 million and for an individual, \$250,000, and
- The Crimes Act 1900 contains other offences relating to false and misleading information: section 307B (giving false or misleading information – maximum penalty 2 years' imprisonment or 200 penalty units, or both).

Name of Authorised Reporting Officer	Richard Yarad
Title	Construction Manager
Signature	
Qualification	Bachelor of Engineering & Project Management
Company	Lendlease Building
Company Address	Lendlease - Level 14, Tower Three, International Towers Sydney, Exchange Place, 300 Barangaroo Avenue , Sydney 2000

## TABLE OF CONTENTS

1.0	INTRODUCTION .....	5
1.1	Context .....	5
1.2	Purpose of this Report.....	5
1.3	Background.....	6
	1.3.1 <i>Project Name and Application Number</i> .....	6
	1.3.2 <i>Project Address</i> .....	6
1.4	Project Description .....	6
	1.4.1 <i>Statutory Context</i> .....	7
	(1) <i>SSD9113</i> .....	7
	(2) <i>SSD10339</i> .....	8
	1.4.2 <i>Approval Documentation</i> .....	8
1.5	Project Phase.....	8
2.0	COMPLIANCE REPORTING.....	9
2.1	Reporting Timing .....	9
2.2	Key Project Personnel .....	10
2.3	Compliance Summary .....	10
	2.3.1 <i>Summary</i> .....	10
	2.3.2 <i>Compliance Status Descriptors</i> .....	11
	2.3.3 <i>Detail of Non-Compliance</i> .....	11
	2.4 <i>Previous Reports Actions</i> .....	19
3.0	INCIDENTS.....	20
4.0	COMPLAINTS.....	20
5.0	COMPLIANCE TABLE .....	25

## 1.0 INTRODUCTION

### 1.1 Context

The Construction Compliance Report (CCR) has been prepared for the work occurring under SSD10339 - Hospital Road Lowering and the UNSW Eastern Extension component of the Randwick Campus Redevelopment Project (the Project).

This Construction Compliance Report has been prepared to satisfy the ongoing Compliance Reporting for the Project. SSD10339: Schedule 2: Part B Conditions B29 to B31 requires the Development and submission of a Compliance Monitoring and Reporting Program Schedule, in accordance with Section 2.1 of the Compliance Reporting Post Approval Requirements (Department 2018 or as amended) to be submitted to the Planning Secretary and the Certifier.

The Report demonstrates that Construction requirements under the Consent have been satisfied.

A summary of the Project is provided in sections 1.3, 1.4 and 1.5. A summary on incidents and complaints is presented in Sections 3 and 4 respectively. Detailed findings of compliance can be found in the Compliance Table in Section 5.

### 1.2 Purpose of this Report

The CCR addresses all requirements needing to be satisfied during the Construction and in accordance with Compliance Reporting Post Approval Requirements (2018). The requirements of the CCR related to planning conditions B29 to B31 are provided below in Table .

Reporting Period is May 2020 to November 2020 for the purposes of this report.

Table 1 - Compliance Reporting

Condition	Condition Requirement	How Addressed
B29.	Compliance Reports of the development must be prepared in accordance with the Compliance Reporting Post Approvals Requirements (Department 2019, or as amended)	Record Keeping System for submission to Planning Secretary
B30.	Compliance Reports of the development must be submitted to the Planning Secretary in accordance with timing outlined in the Compliance Monitoring and Reporting Schedule.	Record Keeping System for submission to Planning Secretary
B31.	The Applicant must make each Compliance Report publicly available 60 days after submitting it to the Planning Secretary.	This Pre-Construction Compliance Report will be published to the Project website following submission to DPIE

## 1.3 Background

### 1.3.1 Project Name and Application Number

**Application Number**

SSDA 10339

**Project Name**

Prince of Wales Hospital Campus

Addition to the Acute Services Building & Lowering of Hospital Road

### 1.3.2 Project Address

**Site**

Prince of Wales Hospital Campus

Parts Lots 4-11 DP 13995

Part Lot 1 DP870720

## 1.4 Project Description

The Randwick Campus Redevelopment new Acute Services Building (ASB) is the first stage of a major expansion of Prince of Wales Hospital at Randwick, previously approved under SSD9113.

The works included in SSDA 10339 will comprise of a 10-storey addition to the eastern elevation of the ASB. The addition will accommodate an integrated clinical research, health and translation for the University of New South Wales (UNSW). The addition is approximately 5,000 m<sup>2</sup> floor area and the approved Development Application scope includes the following:

- Construction of a 10-storey addition to the eastern elevation and extending above Hospital Road.
- Lowering of Hospital Road and closure of access at the High Street intersection.
- Opening of Magill Street for through traffic access (between 7.00am – 10.00pm).
- Landscaping and public domain works.
- Utility services and stormwater infrastructure works.
- Excavation and site preparation work.

Figure 2 and 3 below provide an illustration of the works details above.

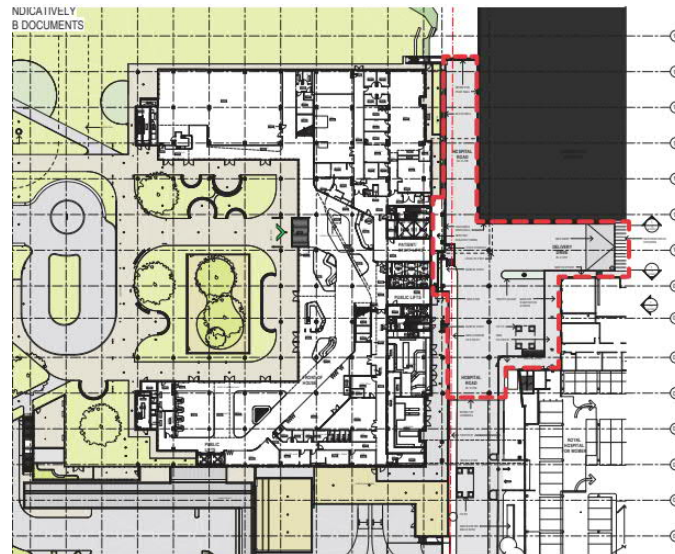

Figure 1 - Extent of Hospital Road Lowering (red dashed line)



Figure 2 - UNSW Eastern Extension

#### 1.4.1 Statutory Context

The Project is classified as a State Significant Development (SSD) by virtue of it exceeding the \$30 million threshold in Schedule 1 of the State Environmental Planning Policy (State and Regional Development) 2011 (SEPP SRD).

##### (1) SSD9113

An application for consent was lodged with the now NSW Department of Planning Industry and Environment (the Department) in 2018 along with an accompanying Environmental Impact Statement. Consent was granted on 27 February 2019 under Section 4.38 of the Environmental Planning and Assessment Act 1979 (EP&A Act), SSD9113, subject to a set of Conditions of Consent (CoCs).

Three modifications have been lodged since consent was granted. Documents relating to the assessment and determination of the Project and its modifications are located at the Department's major projects website, refer <https://www.planningportal.nsw.gov.au/major-projects/project/14326>

(2) SSD10339

An application for consent was lodged with the now NSW Department of Planning Industry and Environment (the Department) in 2019 along with an accompanying Environmental Impact Statement. Consent was granted on 18 December 2019 under Section 4.38 of the Environmental Planning and Assessment Act 1979 (EP&A Act), SSD10339, subject to a set of Conditions of Consent (CoCs).

One modification has been lodged since consent was granted. Documents relating to the assessment and determination of the Project and its modifications are located at the Department’s major projects website, refer <https://www.planningportal.nsw.gov.au/major-projects/project/13511>

1.4.2 Approval Documentation

Documentation relevant to SSD10339 CCR includes:

- Environmental Impact Statement (EIS) - State Significant Development Application SSD-10339 Prince of Wales Hospital - Addition to Approved Acute Services Building and other documentation referenced by Condition A2

1.5 Project Phase

Below is an indicative program for Staged Works in line with the Staging Report Titled “Randwick Campus Redevelopment Project Addition to approved Acute Services Building State Significant Development SSD 10339 Staging Report” :Dated 18<sup>th</sup> March 2021 2020 Rev 0.3.

Table 2 - Staged Works Program

Stage	Relevant Stage of Works – SSD10339	Target Start Dates
1	Diversion of in-ground Hospital Road services including trenching for: <ul style="list-style-type: none"> <li>• Sewer Water</li> <li>• Stormwater</li> <li>• Water Supply</li> <li>• Fire Mains</li> <li>• Medical Gas</li> <li>• Natural Gas</li> <li>• Data/Comms</li> <li>• Low voltage /electrical</li> </ul> Ancillary items: New fire hydrant booster pumps of Ainsworth Building and Royal <ul style="list-style-type: none"> <li>• Hospital for Women including associated enclosure and foundations/piling</li> </ul>	Pending completion
2	<ul style="list-style-type: none"> <li>• Bulk Excavation</li> <li>• Piling</li> <li>• Retention Structures</li> <li>• Ancillary items</li> <li>• Road/pedestrian footpath/steps</li> </ul>	Pending completion
3	Services & piling updates, Hospital Road (future SCH hospital-facilitation)	Nov/Dec 2020
4	IASB Structure & Services	June 2021
5	Ainsworth Plaza Slab	Nov 2021
6	Landscape Works	June/July 2021
6	IASB Façade & Fit Out / Services Balance	Nov 21



## 2.0 COMPLIANCE REPORTING

This Compliance Report has been carried out in accordance with the *Compliance Reporting Post Approval Requirements* (Department 2018, or as amended). Details and Status of Compliance to each of the Conditions of Consent are recorded in the Table of Compliance provided in Appendix A.

### 2.1 Reporting Timing

The Schedule of Compliance reporting is presented in Table below;

Construction Start Date: 23<sup>rd</sup> March 2020

Table 3 - Compliance Reporting Program

Report	Timing	Anticipated Lodgement Date
Pre-Construction Compliance Report (B28a)	No later than 48 hours prior to commencement of construction	No later than 18 <sup>th</sup> March 2020 <b>Lodged 15<sup>th</sup> May 2020</b>
Construction Compliance Report #1	26 weeks intervals from date of commencement of construction	No later than 16 <sup>th</sup> Sept 2020 <b>Lodged 11<sup>th</sup> December 2020</b>
Construction Compliance Report #2	26 weeks intervals from date of commencement of construction	No later than 18 <sup>th</sup> March 2021 extended to 31st March 2021 <b>This Report</b>
Construction Compliance Report #3	26 weeks intervals from date of commencement of construction	No later than 16 <sup>th</sup> Sept 2021
Construction Compliance Report #4	26 weeks intervals from date of commencement of construction	No later than 18 <sup>th</sup> March 2022
Pre-Operation Compliance Report (B28b)	Prior to the commencement of Operation	No later than 16 <sup>th</sup> Sept 2022.
Operations Compliance Reports	At intervals, no greater than 52 weeks from the date of commencement of operations	*Operation date to be confirmed.

**Note 1:** Condition B1: notification 48 hours prior to construction start is 21<sup>st</sup> March 2020

**Note 2:** Works are assumed to be completed 'target' program July 2022

**Note 3:** The anticipated date of Compliance Reporting is the approximate date nominated for lodgement of the Compliance Reports and may vary according to any changes in date of commencement of Construction and date of commencement of Operation.

**Note 4:** B32 provides that, notwithstanding the requirements of the Compliance Reporting Post Approval Requirements (2018), the Planning Secretary may approve a request for ongoing annual operational audits to be ceased, where it has been demonstrated to the Planning Secretary's satisfaction that an operational compliance report has demonstrated operational compliance.

## 2.2 Key Project Personnel

Table below provides a summary of key project personnel:

Table 4 - Key Project Personnel

Organisation	Position	Representative	Contact Details
<b>Health Infrastructure NSW</b>	Senior Project Director	Nick Brooker	Nick.brooker@health.nsw.gov.au
<b>Head Contractor Lendlease Building</b>	Senior Construction Manager	Richard Yarad	richard.yarad@lendlease.com
<b>Project Manager PwC</b>	Project Director	Christopher Mazza	christopher.l.mazza@pwc.com
<b>Certifying Authority</b>	McKenzie Group	Paul Curjack	Paul.curjack@mckenzie.com.au
<b>Phone</b>	24/7 Community Contact		1800 571 866
<b>Project Email</b>	randwickcampusredevelopment@health.nsw.gov.au		
<b>Project Website</b>	<a href="http://www.randwickcampusredevelopment.health.nsw.gov.au">www.randwickcampusredevelopment.health.nsw.gov.au</a>		
<b>Postal Address</b>	Randwick Campus Redevelopment Health Infrastructure PO BOX 1060 North Sydney NSW 2060		

All employees, contractors (and their sub-contractors) have been made aware of, and have been instructed to comply with, the conditions of consent relevant to activities they carry out in respect of the development as per Condition A23

## 2.3 Compliance Summary

### 2.3.1 Summary

Compliance to the Conditions of Approval for the Construction phase of the Project are using the definitions summarised in Table 6 with further details regarding status against each Condition being provided in Section 5: Compliance Table.

Table 5 – Status of Conditions

IA #1	Status Preconstruction June 20 IA#1	IA #2	CCR#1	Status June to Dec 2020 IA#2	CCR#2	Status Dec 2020 to March 2020
		A22		Open		Closed
		A29		Closed		Closed
B3	Open	B3		Open	B3	Open
			B5	Closed		Closed
		B30		Closed	B30	Closed
					B31	Open
		B35		Open		Closed
			C7	Closed		Closed
	Open 1			Open 3		Open 2

IA1 & IA2 – Independent Auditor's Findings

2.3.2 Compliance Status Descriptors

The status of each compliance requirement applicable during the reporting period has been recorded using the relevant descriptors in Table 6 below. No other terms are to be or have been used to describe the compliance status.

Table 6 - Summary of Status Descriptors

Status	Descriptor
Compliant	The proponent has collected sufficient verifiable evidence to demonstrate that all elements of the requirement have been complied with.
Non-Compliant	The proponent has identified a non-compliance with one or more elements of the requirement.
Not Triggered	A requirement has an activation or timing trigger that has not been met at the phase of the development when the compliance assessment is undertaken, therefore an assessment of compliance is not relevant.

2.3.3 Detail of Non-Compliance

Table 7.1 – Detail of non-compliance (this report)

CC ID	Condition Requirement	Reason for Non-Compliance	Action / recommendation
A22	At least 48 hours before the commencement of construction until the completion of all works under this consent, or such other time as agreed by the Planning Secretary, the Applicant must: (a) make the following information and documents (as they are obtained or approved) publicly available on its website: (i) the documents referred to in condition A2 of this consent; (ii) all current statutory approvals for the development; (iii) all approved strategies, plans and programs required under the conditions of this consent; (iv) regular reporting on the environmental performance of the development in accordance with the reporting arrangements in any plans or programs approved under the conditions of this consent; (v) a comprehensive summary of the monitoring results of the development, reported in accordance with the specifications in any conditions of this consent, or any approved plans and programs; (vi) a summary of the current stage and progress of the development; (vii) contact details to enquire about the development or to make a complaint; (viii) a complaints register, updated monthly; (ix) audit reports prepared as part of any independent audit of the development and the Applicant's response to the recommendations in any audit report; (x) any other matter required by the Planning Secretary; and	Independent Audit #2 draft report noted: The Mod 1 Conditions of Consent and Notice of Decision are not located on the project's website. The most recent version of the CEMP, CTPMP, CNVMP, CWMP, CSEMP were not available on the website" Monitoring reports are due to be uploaded every 6 months. No monitoring reports are available on the website. Monitoring results are uploaded 6-monthly. Only the monitoring report template is on the website. Note, the noise, dust and vibration monitoring being conducted for SSD 10339 are the same as for SSD 9113, which are available on the ASB website. The most recent version of the Conditions of Consent, Monitoring Reports and Management Plans were not available on the website	Action to be taken: Ensure up to date information about the project is maintained on the project's website, including management plans and monitoring reports.  CCR#2 Update: Items on the website uploaded 31/3/21  Non-Compliance Status: CLOSED

CC ID	Condition Requirement	Reason for Non-Compliance	Action / recommendation
	(b) keep such information up to date, to the satisfaction of the Planning Secretary.		
<b>B30</b>	Compliance Reports of the development must be submitted to the Planning Secretary in accordance with timing outlined in the Compliance Monitoring and Reporting Schedule.	Independent Audit #2 draft report noted: The Construction Compliance Report was not issued in accordance with the timeframe stipulated in the Schedule. The Construction Compliance Report was due in September 2020. An extension to time was requested from DPIE, which to date had not been granted. The CCR is currently in Final Draft and is intended to be submitted soon	<p>Actions: Compliance to be report issued</p> <p>Action Taken: Compliance report issued to Certifier and DPIE</p> <p>Non Compliance: Compliance Report 2 is issued later than scheduled. Ref Email PWC dated 17/3/21, filename: Re_ _EXT_ Re_ RCR - SSD10339 - Construction Compliance Report #2 confirming HI acceptance of a small extension for compassionate reasons.</p> <p>Non-Compliance Status: CLOSED</p>
<b>B31</b>	The Applicant must make each Compliance Report publicly available 60 days after submitting it to the Planning Secretary.	Non Compliance: CCR#1 has not been uploaded to the website.	<p>ACTION: Upload CCR#1 to project website</p> <p>Non-Compliance Status: OPEN</p>

CC ID	Condition Requirement	Reason for Non-Compliance	Action / recommendation
B35	<p>Prior to the commencement of earthworks, the Applicant must prepare an unexpected contamination procedure to ensure that potentially contaminated material is appropriately managed. The procedure must form part of the of the CEMP in accordance with condition B11 and must ensure any material identified as contaminated must be disposed off-site, with the disposal location and results of testing submitted to the Planning Secretary, prior to its removal from the site.</p>	<p>Independent Audit #2 draft report noted: Five unexpected contaminated finds have occurred since the start of construction (15/5/20, 29/7/20, 1/9/20, 30/9/20, 18/11/20). DPIE were notified of the UF 15/5 and issued with the waste classification report. However, subsequent UF's were not notified to DPIE.</p>	<p>Action to be undertaken: Notify DPIE of the disposal location and the test results for all unexpected contaminated finds.</p> <p>Action Undertaken: Documents received sent to Auditor for IA#2 final assessment.</p> <p>CCR#2 UPDATE: No unexpected finds in this period.</p> <p>Non-Compliance Status: CLOSED.</p>
B3	<p>Prior to the commencement of construction, the Applicant must submit to the satisfaction of the Certifier structural drawings prepared and signed by a suitably qualified practising Structural Engineer that demonstrates compliance with the relevant clauses of the BCA and this development consent.</p>	<p>Crown Certificate 1 was issued by the Certifier. CC1 included the Structural Drawings RCR-ENS-STR-50-DRW-000-00, RCR-ENS-STR-50-DRW-001-00, RCR-ENS-STR-50-DRW-003-37 and RCR-ENS-STR-50-SPC-00001, covering the foundation sections and details. These drawings were certified by James Reynolds from Enstruct as being in accordance with the BCA and Australian standards. The NER search validates James Reynolds as a suitably qualified practising Structural Engineer.</p> <p>Structural drawings for the remainder of the building have not yet been completed, and therefore have not been certified nor submitted to the Certifier</p>	<p>Notify DPIE of non-compliance. No further action required.</p> <p>DPIE to be notified of non-compliance by letter under Condition A26. Timing for compliance with Condition B3 also to be addressed in a Staging Report to be submitted for approval under Condition A11.</p> <p>CCR#2 UPDATE: Non compliance notification issued to PWC for condition A26 10th December 2020. Ref LL-GCOR-029584 Post approval document issued by DPIE reference: 201210 SSD10339 - A26 Non Compliance Notification Receipt - (SSD-10339-PA-16).pdf</p> <p>Staging report submitted 10th December 2020 in accordance with A9 and A10. Post approval document: reference: "Prince of Wales Hospital - Addition to ASB - SSD-10339-PA-19" Dated: 18th Dec 2020</p>

CC ID	Condition Requirement	Reason for Non-Compliance	Action / recommendation
			Non-Compliance Status: OPEN

Table 7.2 - Detail of Non-Compliance from CCR#1

CC ID	Condition Requirement	Reason for Non-Compliance	Action / recommendation
A22	<p>At least 48 hours before the commencement of construction until the completion of all works under this consent, or such other time as agreed by the Planning Secretary, the Applicant must:</p> <p>(a) make the following information and documents (as they are obtained or approved) publicly available on its website:</p> <ul style="list-style-type: none"> <li>(i) the documents referred to in condition A2 of this consent;</li> <li>(ii) all current statutory approvals for the development;</li> <li>(iii) all approved strategies, plans and programs required under the conditions of this consent;</li> <li>(iv) regular reporting on the environmental performance of the development in accordance with the reporting arrangements in any plans or programs approved under the conditions of this consent;</li> <li>(v) a comprehensive summary of the monitoring results of the development, reported in accordance with the specifications in any conditions of this consent, or any approved plans and programs;</li> <li>(vi) a summary of the current stage and progress of the development;</li> <li>(vii) contact details to enquire about the development or to make a complaint;</li> <li>(viii) a complaints register, updated monthly;</li> <li>(ix) audit reports prepared as part of any independent audit of the development and the</li> </ul>	<p>Independent Audit #2 draft report noted: The Mod 1 Conditions of Consent and Notice of Decision are not located on the project's website.</p> <p>The most recent version of the CEMP, CTPMP, CNVMP, CWMP, CSEMP were not available on the website"</p> <p>Monitoring reports are due to be uploaded every 6 months. No monitoring reports are available on the website. Monitoring results are uploaded 6-monthly. Only the monitoring report template is on the website. Note, the noise, dust and vibration monitoring being conducted for SSD 10339 are the same as for SSD 9113, which are available on the ASB website.</p> <p>The most recent version of the Conditions of Consent, Monitoring Reports and Management Plans were not available on the website</p>	<p>Action to be taken: Ensure up to date information about the project is maintained on the project's website, including management plans and monitoring reports.</p> <p>CCR#2 Update: Items on the website are up to date uploaded 31/3/21</p> <p>Non-Compliance Status: CLOSED</p>

CC ID	Condition Requirement	Reason for Non-Compliance	Action / recommendation
	<p>Applicant's response to the recommendations in any audit report;</p> <p>(x) any other matter required by the Planning Secretary; and</p> <p>(b) keep such information up to date, to the satisfaction of the Planning Secretary.</p>		
A29	<p>Within three months of:</p> <p>(a) the submission of a compliance report under condition B30;</p> <p>(b) the submission of an incident report under condition A25 ;</p> <p>(c) the submission of an Independent Audit under condition C41;</p> <p>(d) the approval of any modification of the conditions of this consent; or</p> <p>(e) the issue of a direction of the Planning Secretary under condition A2 which requires a review, the strategies, plans and programs required under this consent must be reviewed, and the Department and the Certifier must be notified in writing that a review is being carried out.</p> <p>If necessary, to either improve the environmental performance of the development, cater for a modification or comply with a direction, the strategies, plans and programs required under this consent must be revised, to the satisfaction of the Certifier. Where revisions are required, the revised document must be submitted to the Certifier for approval within six weeks of the review.</p> <p>Note: This is to ensure strategies, plans and programs are updated on a regular basis and to incorporate any recommended measures to improve the environmental performance of the development.</p>	<p>Independent Audit #2 draft report noted: Notification to the Department and PCA did not occur prior to any of the reviews conducted to date</p>	<p>No Action Required</p> <p>Non-Compliance Status: Closed.</p>
B30	<p>Compliance Reports of the development must be submitted to the Planning Secretary in accordance with timing outlined in the Compliance Monitoring and Reporting Schedule.</p>	<p>Independent Audit #2 draft report noted: The Construction Compliance Report was not issued in accordance with the timeframe stipulated in the Schedule. The Construction Compliance Report was due in September 2020. An extension to time was requested from DPIE, which to date had not been granted. The CCR is currently in Final Draft and is intended to be submitted soon</p>	<p>Actions: Compliance to be report issued</p> <p>Action Taken: Compliance report issued to Certifier and DPIE</p> <p>Non Compliance: Compliance Report 2 is issued later than scheduled. Ref Email PWC dated 17/3/21, filename: Re__EXT__Re_RCR - SSD10339 - Construction Compliance Report #2 confirming HI acceptance of a small extension for compassionate reasons.</p> <p>Non-Compliance Status: Closed</p>

CC ID	Condition Requirement	Reason for Non-Compliance	Action / recommendation
B35	<p>Prior to the commencement of earthworks, the Applicant must prepare an unexpected contamination procedure to ensure that potentially contaminated material is appropriately managed. The procedure must form part of the of the CEMP in accordance with condition B11 and must ensure any material identified as contaminated must be disposed off-site, with the disposal location and results of testing submitted to the Planning Secretary, prior to its removal from the site.</p>	<p>Independent Audit #2 draft report noted: Five unexpected contaminated finds have occurred since the start of construction (15/5/20, 29/7/20, 1/9/20, 30/9/20, 18/11/20). DPIE were notified of the UF 15/5 and issued with the waste classification report. However, subsequent UF's were not notified to DPIE.</p>	<p>Action to be undertaken: Notify DPIE of the disposal location and the test results for all unexpected contaminated finds.</p> <p>Action Undertaken: Documents received sent to Auditor for IA#2 final assessment.</p> <p>CCR#2 UPDATE: No unexpected finds in this period.</p> <p>Non-Compliance Status: CLOSED.</p>
B5	<p>The Applicant must provide a copy of the documentation given to the Certifier to the Planning Secretary within seven days after the Certifier accepts it.</p> <p>Referencing External Walls and Cladding</p>	<p>The Certifying Authority signed off on Crown Certificate 2 (CC2) for SSD10339 on 29 July 2020 (Certificate 20/124846-7). They issued this document to Lendlease via Aconex on 30 July 2020 (ref: MGC-GCOR-000529). However, upon review, it was noted that the issued CC contained some typographical errors in its document reference list. Specifically, some references to Management Plans were duplicates and the piling design compliance certificate referenced (document no. 18) was a superseded certificate dated 3 July 2020 rather than the current certificate dated 28 July 2020. The Crown Certificate was amended to make some corrections and reissued transmitted it via Aconex to Lendlease on the 3 August 2020 (ref: MGC-TRANSMIT-000023). However some of the errors remained. While the duplicate references were of little concern, the piling design certification reference was and it remained incorrect. The erroneous reference to the piling design certificate was rectified on 28 August 2020 by issued of an amended Crown Certificate via Aconex (ref: MGC-GCOR-000566). Thereafter the consolidated referenced documentation and CC2 were provided to PwC for issue to HI and ultimately the Secretary of Planning pursuant to Condition B5.</p>	<p>PWC/HI will issue the Crown Certificate (as amended) and referenced documentation to the Planning Secretary under Condition B5. No further action is proposed to be taken to address this potential non-compliance</p> <p>Issued 1/9/20 ACONEX LL-GCOR-024102 to PWC</p> <p>Non Compliance Status : Closed</p>



CC ID	Condition Requirement	Reason for Non-Compliance	Action / recommendation
		<p>It is noted that the scope of the CC did not relate to External Walls and Cladding, the heading under which Condition B5 falls. However due to the wording of the condition not specifically relating to "External Walls and Cladding" it could be read as relevant to anything the Certifier accepts.</p> <p>Additionally, Condition B5, could be read as requiring that the documentation that was correctly referenced in the initially issued Crown Certificate to be provided to Secretary of Planning within 7 days of the original certificate date (5 August 2020). Only a few document references required correction, but most did not change upon reissue of CC2. However, the approach taken was to issue the full set of referenced documentation upon issue of the corrected certificate however. Hence a potential non-compliance has been identified</p>	
C7	<p>Construction activities may be undertaken outside of the hours in condition C4, in accordance with the schedule of out of hours work nominated at section 3.4.2 and table 3.3 of the EIS to maintain operation of the hospital loading dock, unless directed otherwise by the Planning Secretary, and must be restricted to the following times and type of works:</p> <p>(a) Friday: 6:00 pm to 10:00 pm (limited to site establishment activities in preparation for weekend works).</p> <p>(b) Saturday: 5:00 pm to 10:00 pm (general construction activities excluding excavation, sawing of rock, jack hammers, pile drivers, vibratory rollers/compactors of the like).</p> <p>(c) Sunday: 8:00 am to 5:00 pm (general construction activities including excavation, sawing of rock, jack hammers, pile drivers, vibratory rollers/compactors of the like).</p> <p>(d) Sunday: 5:00 pm to 10:00 pm (general construction activities excluding excavation, sawing of rock, jack hammers, pile drivers, vibratory rollers/compactors of the like).</p>	<p>Bored piling works had been undertaken during the working hours on Saturday 01<sup>st</sup> August 2020 for the Retention piles and Foundation piles to Delivery Drive of the Prince of Wales Loading dock. At the completion of boring process, there was six (6) retention piles that required reinforcement cages to be lowered in and filled with concrete. There was one (1) foundation pile which included a steel sleeve for inground support. This was planned to be poured but not necessary as it has its own structural support with the steel sleeve.</p> <p>The pouring of concrete into the piles was scheduled to be completed by 9:00pm, which would have provided sufficient time to clean up and cease works by 10:00pm. A total of 20m<sup>3</sup> of concrete was required to complete the works. This was a total of 5 concrete trucks. As it was identified that the service of concrete from the plantyard was very slow and the supplier had only allocated two concrete trucks, Lendlease Foreman cancelled the pouring of the Foundation pile to minimise the remaining duration of works. However, the 6 retention piles needed to be poured to not compromise stability and potentially collapse if left unattended. The last concrete truck arrived at 9.50pm. This resulted in works ceasing at 11:30pm. Lighting provision was required to remain on until this time to enable the small crew of workers to complete work and secure the site and vacate.</p>	<p>Lendlease made contact with the resident on the following morning to provide information on the event. The resident did not identify and noise complaints with the works and was only concerned with lighting. Lendlease undertook the following measures on Sunday 02 August for the proceeding night work:</p> <ul style="list-style-type: none"> <li>• Realigned position of lighting tower to mitigate light spill to sensitive receivers</li> <li>• Due to the requirement to demobilise the piling platforms on Sunday evening, associated concrete works to piling was complete at 3:00pm.</li> <li>• All works were ceased by the approved hours of 10.00pm</li> </ul> <p>Lendlease has followed up with the Subcontractor and Concrete supplier to express their concerns about the poor supply of concrete on the</p>

CC ID	Condition Requirement	Reason for Non-Compliance	Action / recommendation
		Lendlease Community hotline was contacted at 10.50pm in regard to lighting associated with construction activity along Delivery Drive. The resident requested for an update when lighting would be turned off. After contact was made with the site team it was turned off at 11.30pm.	evening of Saturday 01 <sup>st</sup> August. A review of the daily activities for future scenarios will be undertaken to ensure there is contingency in timing of concrete deliveries to mitigate the risk of a potential time overruns and to comply with the approved working hours.  Non- Compliance Status: Closed

Table 7.3 - Detail of Non-Compliance from Independent Audit #1

CC ID	Condition Requirement	Reason for Non-Compliance	Action / recommendation
B3	Prior to the commencement of construction, the Applicant must submit to the satisfaction of the Certifier structural drawings prepared and signed by a suitably qualified practising Structural Engineer that demonstrates compliance with the relevant clauses of the BCA and this development consent.	Crown Certificate 1 was issued by the Certifier. CC1 included the Structural Drawings RCR-ENS-STR-50-DRW-000-00, RCR-ENS-STR-50-DRW-001-00, RCR-ENS-STR-50-DRW-003-37 and RCR-ENS-STR-50-SPC-00001, covering the foundation sections and details. These drawings were certified by James Reynolds from Enstruct as being in accordance with the BCA and Australian standards. The NER search validates James Reynolds as a suitably qualified practising Structural Engineer.  Structural drawings for the remainder of the building have not yet been completed, and therefore have not been certified nor submitted to the Certifier	Notify DPIE of non-compliance. No further action required.  DPIE to be notified of non-compliance by letter under Condition A26. Timing for compliance with Condition B3 also to be addressed in a Staging Report to be submitted for approval under Condition A11.  CCR#2 UPDATE: Non compliance notification issued to PWC for condition A26 10th December 2020. Ref LL-GCOR-029584 Post approval document issued by DPIE reference: 201210 SSD10339 - A26 Non Compliance Notification Receipt - (SSD-10339-PA-16).pdf

CC ID	Condition Requirement	Reason for Non-Compliance	Action / recommendation
			<p>Staging report submitted 10th December 2020 in accordance with A9 and A10.                      Post approval document: reference: "Prince of Wales Hospital - Addition to ASB - SSD-10339-PA-19"                      Dated: 18th Dec 2020</p> <p>Non-Compliance Status: OPEN</p>

*2..4 Previous Reports Actions*

Construction Compliance Report #1 issued on the 10<sup>th</sup> December 2020 (Ref LL-GCOR-029663). No further actions were requested by DPIE and the non-compliances are noted in the above section.

The Pre-Construction Compliance Report R4 dated 15/5/20 was issued on the 1<sup>st</sup> May 2020 for SSDA 10339 (Ref LL-GCOR-018645) as set out in Compliance Monitoring and Reporting Program with no non-compliances noted

### 3.0 INCIDENTS

A register of all incidents, as defined by the conditions of consent, is to be maintained with the following information:

- the cause and nature of the incident, the date it occurred and the date it was identified;
- location of the incident;
- how the incident was identified;
- the agency, or agencies to whom the incident was reported;
- details of any corrective and preventative action required by agencies and any undertaken by the proponent; and
- the response to the incident, including details of timing for undertaking such actions (i.e. that corrective and preventative action is not required, has commenced or is completed).

In this reporting period, please see below table for incident log

Table 8 - Detail of Incidents

Date	Description	Close Out
29 <sup>th</sup> March 2020	Stormwater discharge to council system following extreme rain event.	Notification issued to PWC & HI on 29-3-21 by Aconex LL-GCOR-034910

### 4.0 COMPLAINTS

A list or table of complaints received, as defined by the Conditions is to be maintained with the following information:

- the number of Complaints received; and
- a summary of the main areas of the complaint.

A statement must also be provided as to any emerging trends identified in complaints received and proposed action for addressing complaints or reducing the recurrence of complaints or that 'no further action is required'.

Date of Complaint	Date of Response	Method of Complaint	Nature of Complaint	Project Response	Complaint Status

In accordance with Condition A22 (a)(viii) – A complaints register will be maintained and updated monthly on the Project website

Table 9 Summary of complaints by month from December 2020 – February 2020

Month	No. of complaints	Nature of complaints
Dec 2020	2	<ul style="list-style-type: none"> <li>• 1 x Worker behaviours</li> <li>• 1 x Construction Impact</li> </ul>
Jan 2020	1	<ul style="list-style-type: none"> <li>• 1 x Traffic Impact</li> </ul>

Table 10 Complaints categories

Category	Definition
<b>Construction Impacts</b>	Complaints related to noise, dust and vibration generated by construction activity and any environmental impact.
<b>Community Impact</b>	Complaints related to disruption to continuity of operations and amenity for residents, community members and businesses.
<b>Traffic and Parking</b>	Complaints related to disruption of traffic and parking deemed attributable to project activity.
<b>Safety</b>	Complaints related to maintenance of safety for residents and community members.
<b>Worker behaviour</b>	Complaints related to the conduct of the project workforce when interacting with members of the community or conducting work outside of the project boundary.

All complaints have been deemed as actioned and resolved in accordance with the project Community Communication Strategy and complaints handling processes. There are no matters current or previous matters subject to independent investigation or mediation.

#### 4.2 Environmental Monitoring

Environmental monitoring is used to review potential environmental risks caused by project activity. It allows the project to assess and evaluate receiving environmental trends and ensure installed controls are appropriate and effective.

The Randwick Campus Redevelopment complies with strict environmental and planning controls.

As a condition of State Significant Development approval (SSD10339) the Randwick Campus Redevelopment has mitigation measures in place to manage noise, dust and vibration levels, through sensitive data receivers. Any exceedances in noise, dust and vibration levels are made publicly available on the project website.

Residents and project stakeholders are notified of construction activity in advance of potentially sensitive works occurring.

During the reporting period there has been a total of 15 occasions, where exceedances have been recorded and attributed to the project.

##### 4.2.1 Noise Monitoring

The focus of the monitoring is confirming predicted noise levels and monitoring in accordance with relevant Noise and Vibration Monitoring Programs as detailed in the Construction Noise and Vibration Management Sub Plan as per condition B12.

The following exceedance criteria is applied to the Randwick Campus Redevelopment project site:

- **Noise** – The noise criteria for the project is Noise Affected Levels between 46 dB(A) and 56 dB(A) and Highly Noise Affected goal of 75 dB(A).

There were 21no. instances where the measured value dB(A) was above the Highly Affected Noise goal dB(A) December 20 to March 21 inclusive. This was due to;

- 13 no instances associated with project works
- 2 no instances were contributable to isolated discrete events
- 6 no instances due to other noise sources (i.e. there was no construction associated with the Project occurring at the time of the monitoring)

#### 4.2.2 Vibration Monitoring

The focus of vibration monitoring is activities close to property and monitoring in accordance of vibration monitoring requirements.

The following exceedance criteria is applied to the Randwick Campus Redevelopment project site:

- **Vibration** – The precautionary vibration criteria for the project are 5mm/s peak velocity (PV) for residential buildings and 20mm/s peak velocity (PV) for UNSW and POW receivers.

There were no instances where the vibration exceeded the allowances December 20 to March 21 inclusive.

#### 4.2.3 Air Quality Monitoring

The focus of air quality monitoring are activities close to private property and surrounding facilities.

The following exceedance criteria is applied to the Randwick Campus Redevelopment project site:

- **Air Quality** - Under the National Environment Protection Measure for Ambient Air Quality (the Air NEPM) the national standard for particulate matter 10 microns or less (PM10) is 25µg/m<sup>3</sup> averaged over one day.

There were 0no. instances where the air quality exceeded the allowances.

➤

#### 4.2.4 Other

- There were no unexpected threated flora or fauna encountered during the reporting period.
- There were no unexpected heritage or aboriginal finds during the reporting period.
- independent Audit 2 also identified
  - the WW2 slit trenches that were noted in the EIS clause 7.7.2. The trenches have been monitored by Casey Lowe as the project progresses and the details have been noted.
  - Also the Noise Mitigation Strategy was suggested to be issued to DPIE along with notification that A30 is not triggered.

### 4.3 Stakeholder Engagement and Communications

#### Stakeholder Engagement and Communications

Throughout all stages of planning and construction the project remains committed to early, coordinated, proactive and transparent stakeholder engagement. Extensive planning and engagement have been undertaken to identify and develop collaborative and productive relationships with key stakeholders to support planning and delivery of the new Acute Services Building, and these have been and will continue to be leveraged throughout planning, design and delivery of the IASB.

The following principles underpin the project’s approach to stakeholder engagement and communication:

- **Purposeful:** Engagement is meaningful to stakeholders and provided in a clear and consistent manner.
- **Timely:** Information is provided, and available, to stakeholders at the appropriate time and in the appropriate format.
- **Inclusive:** Engagement activities are accessible to all relevant interested and impacted stakeholders.
- **Respectful:** Stakeholders diverse, needs and perspectives are acknowledged and respected.
- **Transparent:** Engagement is open and honest with expectations clearly set.

Across the reporting period the Randwick Campus Redevelopment has undertaken extensive engagement and communication with the following stakeholder groups – refer to Table 4.1 below

Table 11 RCR Engagement and Communication

Stakeholder Group	Communication objectives	Typical methods of engagement
<b>Hospital</b> - Prince of Wales Hospital Executive, Board, staff, patients, suppliers, visitors, unions, volunteers	<ul style="list-style-type: none"> <li>• Build awareness</li> <li>• Show staff they are valued partners</li> <li>• Ensure accurate and timely information to staff and other stakeholders, including regular updates, pop-up stalls and briefings where required</li> <li>• Highlight benefits and drivers for the IASB Addition, including future health, educational and employment opportunities</li> </ul>	<ul style="list-style-type: none"> <li>• Project Governance</li> <li>• Staff Forums, Ward updates, Pop-Up Stands</li> <li>• Communications materials – signage, newsletters, intranet, noticeboard, email</li> <li>•</li> </ul>
<b>Randwick Health and Education Precinct Executives</b> (UNSW, HI, SESLHD, SCHN)	<ul style="list-style-type: none"> <li>• Involved in project Governance</li> <li>• Actively participate in strategic development</li> <li>• Project and Precinct Champions - representing the vision and engaging other stakeholders to participate</li> </ul>	<ul style="list-style-type: none"> <li>• Project and Precinct Governance</li> <li>• Briefings – formal and informal</li> <li>• Collaboration workshops</li> <li>• Email</li> </ul>
<b>Randwick Hospitals Campus</b> - Royal Hospital for Women, Sydney Children’s Hospital, Randwick, Prince of Wales Hospital, Prince of Wales Private Hospital, Eastern Suburbs Mental Health Service, and other health and research institutions	<ul style="list-style-type: none"> <li>• Build project awareness</li> <li>• Ensure accurate and timely information to staff and other stakeholders, including regular updates</li> <li>• Highlight benefits and drivers for the IASB Addition, including future health, educational and employment opportunities</li> </ul>	<ul style="list-style-type: none"> <li>• Briefings - Staff Forums, Ward Updates</li> <li>• Communications materials – newsletters, intranet, noticeboard, email</li> <li>• Pop-Up information stands</li> </ul>
<b>University of New South Wales –</b> executives, other staff, students of UNSW	<ul style="list-style-type: none"> <li>• Build project awareness</li> <li>• Ensure accurate and timely information, including regular updates and briefings</li> <li>• Highlight role of UNSW as key IASB Addition proponent and funding source</li> <li>• Highlight benefits and drivers for the IASB, including future health, educational and employment opportunities</li> </ul>	<ul style="list-style-type: none"> <li>• Precinct Governance</li> <li>• Briefings – formal and informal</li> <li>• UNSW Newsletter</li> <li>• Pop up information stands</li> <li>• Signage</li> </ul>
<b>Randwick City Council –</b> General Manager, planning, traffic and	<ul style="list-style-type: none"> <li>• Build project awareness</li> </ul>	<ul style="list-style-type: none"> <li>• Formal and informal briefings</li> </ul>

Randwick Campus Redevelopment

engineering staff, Communication Manager, Councillors	<ul style="list-style-type: none"> <li>• Ensure accurate and timely information, especially around the planning process and potential impacts on Magill Street</li> <li>• Be available for briefings as required</li> <li>• Collaborate during planning to ensure feedback, technical requirements are adequately considered in building design and construction staging</li> </ul>	<ul style="list-style-type: none"> <li>• Written correspondence</li> </ul>
<b>Precinct</b> (other) – Transport for NSW CBD and South East Light Rail, community, local schools, bicycle users	<ul style="list-style-type: none"> <li>• Build project awareness</li> <li>• Collaborative approach to planning and vision</li> <li>• Regular meetings, focused on interface issues, traffic and access and construction management</li> </ul>	<ul style="list-style-type: none"> <li>• Briefings – formal and informal</li> <li>• Communications materials – newsletters, email, signage</li> </ul>
<b>NSW Government (Ministry of Health and Departments)</b>	<ul style="list-style-type: none"> <li>• Collaborative approach to planning and vision</li> <li>• Collaborate during planning to ensure feedback, technical requirements are adequately considered in building design and construction staging</li> </ul>	<ul style="list-style-type: none"> <li>• Project and Precinct Governance</li> <li>• Regular briefings – formal and informal</li> </ul>
<b>Consumers</b> – Members of the community, actively participating in planning for the Redevelopment	<ul style="list-style-type: none"> <li>• Build project awareness</li> <li>• Keep informed</li> <li>•</li> </ul>	<ul style="list-style-type: none"> <li>• Website, phone and email</li> <li>• Briefings – formal and informal</li> <li>• Signage, factsheets, project website</li> </ul>
<b>Indigenous community</b> – La Perouse Local Aboriginal Land Council	<ul style="list-style-type: none"> <li>• Engaged in planning throughout project development for ASB.0</li> </ul>	<ul style="list-style-type: none"> <li>• Briefings – formal Engaged regarding Aboriginal Archaeology</li> </ul>
<b>Community</b> – immediate neighbours	<ul style="list-style-type: none"> <li>• Build project awareness, keep regularly informed about developments</li> <li>• Understand key impacts and mitigations proposed as part of the project</li> <li>• Regular contact to discuss project developments</li> </ul>	<ul style="list-style-type: none"> <li>• Construction impact notifications</li> <li>• Regular community updates</li> <li>• Website, phone and email</li> <li>• Community information drop in session</li> </ul>
<b>Community</b> – commercial, business	<ul style="list-style-type: none"> <li>• Provide engaging and informative content that promotes accurate information and reiterates IASB Addition drivers and benefits</li> </ul>	<ul style="list-style-type: none"> <li>• Construction impact notifications</li> <li>• Regular community updates</li> <li>• Website, phone and email</li> <li>• Community information drop in session</li> </ul>
<b>Community</b> – wider community	<ul style="list-style-type: none"> <li>• Provide engaging and informative content that promotes accurate information and reiterates IASB Addition drivers and benefits</li> </ul>	<ul style="list-style-type: none"> <li>• Regular community updates</li> <li>• Website, phone and email</li> <li>• Community information drop in session</li> </ul>



## 5.0 COMPLIANCE TABLE

SSDA 10339: UNSW & LHR: Conditions							
PART A Administrative Conditions							
Obligation to Minimise Harm to the Environment							
ID NO. 2.2.1.1	Compliance Requirement 2.2.1.2	Timing for Compliance 2.2.13	Secretary Approval Required	Responsibility	Monitoring Methodology 2.2.1.4	Evidence/Comments 2.2.1.5	Compliance Status 2.3.2
A1	In addition to meeting the specific performance measures and criteria in this consent, all reasonable and feasible measures must be implemented to prevent, and, if prevention is not reasonable and feasible, minimise any material harm to the environment that may result from the construction and operation of the development.	At all times		Note	At all times - Note Environmental monitoring, inspection/s, internal and independent audits, Management Plan and Management Plan Reviews, training, Record keeping systems for communications with Certifier/ Planning Secretary and other relevant 3rd party groups	Contained within current <b>Management Plans and Sub-plans</b> . Commitment that Management plans and Sub-plans will be complied with throughout the duration of works under this Consent, Evidence to be provided throughout works such as: <ul style="list-style-type: none"> <li>Monitoring records,</li> <li>Site Inspection Records Environmental Action Registers, Incident reports,</li> <li>Management plan/s review tracking</li> <li>Audit results and close outs</li> </ul>	Compliant
Terms of Consent							
A2	The development may only be carried out: (a) in compliance with the conditions of this consent; (b) in accordance with all written directions of the Planning Secretary; (c) generally in accordance with the EIS and Response to Submissions; (d) in accordance with the approved plans in the table below:	At all times	In accordance with written directions of the Planning Secretary	Note	At all times - Note Environmental monitoring, inspection/s, internal and independent audits, Management Plan and Management Plan Reviews, training, Record keeping systems for communications with Certifier/ Planning Secretary and other relevant 3rd party groups	<p>a) <b>SSD 10339 – Additions to Approved Acute Services Building</b> Refer to details contained within this table for Compliance to Conditions</p> <p>b) <b>Record of written direction</b> PWCAU-PMI-000064 – Direction from HI to pursue Alternative ESD pathway in lieu of Greenstar.</p> <p>Refer DPIE letter dated 22/10/19 – Executive Director from Infrastructure Assessments Document Titled - ESD Framework and Guideline – Request for agreement of alternative framework.</p> <p>a) Impacts Condition B8</p>	Compliant

Randwick Campus Redevelopment

	<table border="1"> <thead> <tr> <th colspan="4">Architectural Plans prepared by BVN and Terroir</th> </tr> <tr> <th>Dwg No.</th> <th>Issue</th> <th>Name of Plan</th> <th>Date</th> </tr> </thead> <tbody> <tr><td>01A-NL0016</td><td>A</td><td>Site Plan</td><td>04.07.19</td></tr> <tr><td>01A-DA00510</td><td>A</td><td>Materials Board</td><td>04.07.19</td></tr> <tr><td>11B-0000003</td><td>D</td><td>General Arrangement Plan Level 00</td><td>04.07.19</td></tr> <tr><td>11B-0100003</td><td>D</td><td>General Arrangement Plan Level 01</td><td>04.07.19</td></tr> <tr><td>11B-0200003</td><td>D</td><td>General Arrangement Plan Level 02</td><td>04.07.19</td></tr> <tr><td>11B-0300003</td><td>D</td><td>General Arrangement Plan Level 03</td><td>04.07.19</td></tr> <tr><td>11B-0400003</td><td>D</td><td>General Arrangement Plan Level 04</td><td>04.07.19</td></tr> <tr><td>11B-0500003</td><td>D</td><td>General Arrangement Plan Level 05</td><td>04.07.19</td></tr> <tr><td>11B-0600003</td><td>D</td><td>General Arrangement Plan Level 06</td><td>04.07.19</td></tr> <tr><td>11B-0700003</td><td>D</td><td>General Arrangement Plan Level 07</td><td>04.07.19</td></tr> <tr><td>11B-0800003</td><td>D</td><td>General Arrangement Plan Level 08</td><td>04.07.19</td></tr> <tr><td>11B-0900003</td><td>D</td><td>General Arrangement Plan Level 09</td><td>04.07.19</td></tr> <tr><td>11B-1000003</td><td>C</td><td>General Arrangement Plan Level 10</td><td>04.07.19</td></tr> <tr><td>11B-B100003</td><td>D</td><td>General Arrangement Plan Level -01</td><td>04.07.19</td></tr> <tr><td>11C-NL10001</td><td>G</td><td>North Elevation</td><td>23.10.19</td></tr> <tr><td>11C-NL10002</td><td>F</td><td>South Elevation</td><td>23.10.19</td></tr> <tr><td>11C-NL10003</td><td>F</td><td>East Elevation</td><td>23.10.19</td></tr> <tr><td>11D-NL1001</td><td>G</td><td>North-South Section</td><td>23.10.19</td></tr> <tr><td>11D-NL1002</td><td>F</td><td>West-East Section 1</td><td>23.10.19</td></tr> <tr><td>11D-NL1003</td><td>F</td><td>West-East Section 2</td><td>23.10.19</td></tr> <tr> <th colspan="4">SSDA Landscape Design Report - Updated prepared by Aspect Studios, Revision 9, dated 17.10.19</th> </tr> <tr> <th>Page Number</th> <th colspan="3">Name of Plan</th> </tr> <tr><td>10</td><td colspan="3">Level 00 General Arrangement</td></tr> <tr><td>11</td><td colspan="3">Level 00 Section</td></tr> <tr><td>12</td><td colspan="3">Level 00 Landscape Design</td></tr> <tr><td>13</td><td colspan="3">Level 00 Material Palette</td></tr> <tr><td>15</td><td colspan="3">Soil Depths and Volumes</td></tr> <tr><td>16</td><td colspan="3">Planting Plan</td></tr> <tr><td>17</td><td colspan="3">Planting Schedules</td></tr> <tr><td>18</td><td colspan="3">Site Tree Retention and Removal</td></tr> </tbody> </table>	Architectural Plans prepared by BVN and Terroir				Dwg No.	Issue	Name of Plan	Date	01A-NL0016	A	Site Plan	04.07.19	01A-DA00510	A	Materials Board	04.07.19	11B-0000003	D	General Arrangement Plan Level 00	04.07.19	11B-0100003	D	General Arrangement Plan Level 01	04.07.19	11B-0200003	D	General Arrangement Plan Level 02	04.07.19	11B-0300003	D	General Arrangement Plan Level 03	04.07.19	11B-0400003	D	General Arrangement Plan Level 04	04.07.19	11B-0500003	D	General Arrangement Plan Level 05	04.07.19	11B-0600003	D	General Arrangement Plan Level 06	04.07.19	11B-0700003	D	General Arrangement Plan Level 07	04.07.19	11B-0800003	D	General Arrangement Plan Level 08	04.07.19	11B-0900003	D	General Arrangement Plan Level 09	04.07.19	11B-1000003	C	General Arrangement Plan Level 10	04.07.19	11B-B100003	D	General Arrangement Plan Level -01	04.07.19	11C-NL10001	G	North Elevation	23.10.19	11C-NL10002	F	South Elevation	23.10.19	11C-NL10003	F	East Elevation	23.10.19	11D-NL1001	G	North-South Section	23.10.19	11D-NL1002	F	West-East Section 1	23.10.19	11D-NL1003	F	West-East Section 2	23.10.19	SSDA Landscape Design Report - Updated prepared by Aspect Studios, Revision 9, dated 17.10.19				Page Number	Name of Plan			10	Level 00 General Arrangement			11	Level 00 Section			12	Level 00 Landscape Design			13	Level 00 Material Palette			15	Soil Depths and Volumes			16	Planting Plan			17	Planting Schedules			18	Site Tree Retention and Removal							<p><b>c) Current Management plans and Sub-plans</b> In accordance with the EIS and Response to Submissions</p> <p><b>d) Check of Current Plans</b> Approved plans are in place for Construction</p>	
Architectural Plans prepared by BVN and Terroir																																																																																																																																							
Dwg No.	Issue	Name of Plan	Date																																																																																																																																				
01A-NL0016	A	Site Plan	04.07.19																																																																																																																																				
01A-DA00510	A	Materials Board	04.07.19																																																																																																																																				
11B-0000003	D	General Arrangement Plan Level 00	04.07.19																																																																																																																																				
11B-0100003	D	General Arrangement Plan Level 01	04.07.19																																																																																																																																				
11B-0200003	D	General Arrangement Plan Level 02	04.07.19																																																																																																																																				
11B-0300003	D	General Arrangement Plan Level 03	04.07.19																																																																																																																																				
11B-0400003	D	General Arrangement Plan Level 04	04.07.19																																																																																																																																				
11B-0500003	D	General Arrangement Plan Level 05	04.07.19																																																																																																																																				
11B-0600003	D	General Arrangement Plan Level 06	04.07.19																																																																																																																																				
11B-0700003	D	General Arrangement Plan Level 07	04.07.19																																																																																																																																				
11B-0800003	D	General Arrangement Plan Level 08	04.07.19																																																																																																																																				
11B-0900003	D	General Arrangement Plan Level 09	04.07.19																																																																																																																																				
11B-1000003	C	General Arrangement Plan Level 10	04.07.19																																																																																																																																				
11B-B100003	D	General Arrangement Plan Level -01	04.07.19																																																																																																																																				
11C-NL10001	G	North Elevation	23.10.19																																																																																																																																				
11C-NL10002	F	South Elevation	23.10.19																																																																																																																																				
11C-NL10003	F	East Elevation	23.10.19																																																																																																																																				
11D-NL1001	G	North-South Section	23.10.19																																																																																																																																				
11D-NL1002	F	West-East Section 1	23.10.19																																																																																																																																				
11D-NL1003	F	West-East Section 2	23.10.19																																																																																																																																				
SSDA Landscape Design Report - Updated prepared by Aspect Studios, Revision 9, dated 17.10.19																																																																																																																																							
Page Number	Name of Plan																																																																																																																																						
10	Level 00 General Arrangement																																																																																																																																						
11	Level 00 Section																																																																																																																																						
12	Level 00 Landscape Design																																																																																																																																						
13	Level 00 Material Palette																																																																																																																																						
15	Soil Depths and Volumes																																																																																																																																						
16	Planting Plan																																																																																																																																						
17	Planting Schedules																																																																																																																																						
18	Site Tree Retention and Removal																																																																																																																																						
<p><b>A3</b></p>	<p>Consistent with the requirements in this consent, the Planning Secretary may make written directions to the Applicant in relation to: (a) the content of any strategy, study, system, plan, program, review, audit, notification, report or correspondence submitted under or otherwise made in relation to this consent, including those that are required to be, and have been, approved by the Planning Secretary; (b) any reports, reviews or audits commissioned by the Planning Secretary regarding compliance with this approval; and (c) the implementation of any actions or measures contained in any such document referred to in (a) above.</p>	<p>At all times</p>	<p>-</p>	<p>Note</p>	<p>Record Keeping System for communications with the Planning Secretary, Department of Planning Industry and Environment</p>	<p>Directives Received to date:</p> <ol style="list-style-type: none"> <li>1. Preconstruction compliance report format feedback was received and the CCR revised to include evidence of key correspondences and submissions to the Certifier, Planning Secretary and/or other Agencies, as per DPIE email 1 May 2020 DPIE Post Approval Document PA-9</li> <li>2. ESD guidelines – alterations and procedures for alternate guideline DPIE letter dated 10/2/2020. Reference B8 for details.</li> <li>3. Staging Report #1 Feedback and responses to RFI titled "RFI Request for Post Approval_15022021_094525" dated 15<sup>th</sup> February</li> </ol>	<p>Compliant</p>																																																																																																																																

Randwick Campus Redevelopment

						2021. Updates and responses issued to PWC by email 18 <sup>th</sup> March 2020. Approval pending.	
A4	The conditions of this consent and directions of the Planning Secretary prevail to the extent of any inconsistency, ambiguity or conflict between them and a document listed in condition A2(c) or A2(d). In the event of an inconsistency, ambiguity or conflict between any of the documents listed in condition A2(c) and A2(d), the most recent document prevails to the extent of the inconsistency, ambiguity or conflict.	At all times	-	Note	Review & cross check requirements	Condition is noted	Compliant
<b>Limits of Consent</b>							
A5	This consent lapses five years after the date of consent unless work is physically commenced.	At all times up until 5 years after the consent lapses	-	Note	Check of consent date and date of construction commencement	Front page SSD 10339 dated – 18 Dec 2019. Construction start date – 23 March 2020 Note: 'Construction' as defined by SD10339	Not triggered
<b>Prescribed Conditions</b>							
A6	The Applicant must comply with all relevant prescribed conditions of development consent under Part 6, Division 8A of the EP&A Regulation.	At all times	-	LHD	At all times - Note Environmental monitoring, inspection/s, internal and independent audits, Management Plan and Management Plan Reviews, training, Record keeping systems for communications with Certifier/ Planning Secretary and other relevant 3rd party groups	a) Erection of Site Signage –Site sign board with project details erected at Gate 3 b) Residential building work – N/A c) Entertainment venues – N/A d) Signage for maximum number of persons – N/A e) Shoring and adjoining properties – Document Title: SSD10339 Structural Design Certificate for Crown Certificate CC2 – Conditions A4, A17 & B3 Prepared by: Enstruct group Dated -28 <sup>th</sup> July 2020  <b>Submitted to PCA</b> Via aconex corro. Ref: LL-GCOR-023873 Consultant Enstruct Group Sent: 27-8-20 <b>Approval from PSA</b>	Compliant

Randwick Campus Redevelopment

						Via Crown Certificate No 20/124846-7 Issued: 28-9-2020	
<b>Planning Secretary as Moderator</b>							
<b>A7</b>	In the event of a dispute between the Applicant and a public authority, in relation to an applicable requirement in this approval or relevant matter relating to the Development, either party may refer the matter to the Planning Secretary for resolution. The Planning Secretary's resolution of the matter must be binding on the parties.	At all times	Reference may be made to Planning Secretary	Note	Record Keeping System for communications with the Planning Secretary, Department of Planning Industry and Environment	Record of written direction	Not triggered

Randwick Campus Redevelopment

Evidence of Consultation							
A8	<p>Where conditions of this consent require consultation with an identified party, the Applicant must:</p> <p>(a) consult with the relevant party prior to submitting the subject document for information or approval; and</p> <p>(b) provide details of the consultation undertaken including:</p> <p>(i) the outcome of that consultation, matters resolved and unresolved; and</p> <p>(ii) details of any disagreement remaining between the party consulted and the Applicant and how the Applicant has addressed the matters not resolved.</p>	At all times		Contractor	<p>Record keeping for communications with the Certifier.</p> <p>Record keeping for Communications with Council, Community, all agencies including Coordinator General, Transport Coordination, or Sydney Light Rail Project Team.</p>	<p><b>Condition A31:</b> <i>The Applicant must consult with TfNSW - surrounding road network associated with the closure of Hospital Road at High Street.</i>                      Email response received from TfNSW (CBD Freight Policy &amp; Planning Manager) supporting endorsement of CPTMP &amp; CWTS with inclusion of comments dated 19/02/20.</p> <p><b>Condition B6 : Protection of Public Infrastructure</b>  <i>item (c) submit a copy of the dilapidation report to the Planning Secretary, Certifier and Council.</i>                      Planning Dept acknowledge receipt of Dilapidation Reports – email dated 26 Feb 2020 Title: Prince of Wales Hospital – Addition to approved acute Service Building- Dilapidation Reports                      Since Feb 20:                      Sydney Water SC180989WW – Sewer adjustment &amp; deviation plans approved stamped 5-5-2020. Plans and Deed poll titles starting “B6 – CASE180989WW...”                      Ausgrid – AN11992 and AB14223 adjustments as requested file titled “B6 = Ausgrid email – Deed of Agreement – AN11992 and AN 14233”</p> <p><b>Condition B7: CBD and South East Light Rail</b> <i>Prior to commencement of construction, the Applicant must consult with and obtain written approval from TfNSW,</i>                      Email response received from TfNSW (CBD Freight Policy &amp; Planning Manager) supporting endorsement of CPTMP &amp; CWTS with inclusion of comments dated 19/02/20</p> <p>CTPMP_IASB_June20_r5 issued by email to PWC &amp; TfNSW on 18/6/20 by Richard Yarad &amp; updated 3/7/20 titled “RCR-IASB-TfNSW Construction Staging Meeting”</p> <p>Updated CPTMP endorsed June 20 for r5 Email response received 14-7-20 “Endorsement 14 July 2020 – IASB – TfNSW Construction Staging” (See also B15)</p>	Compliant

						<p><b>Condition B15 : Construction Traffic &amp; Management Plan :</b> <i>item (b) be prepared in consultation with the TfNSW, including its Sydney Coordination Office, Sydney Light Rail Operator team, TfNSW (RMS), and Council.</i>          Email response received from TfNSW (CBD Freight Policy &amp; Planning Manager) supporting endorsement of CPTMP &amp; CWTS with inclusion of comments dated 19/02/20.</p> <p>CTPMP_IASB_June20_r5 issued by email to PWC &amp; TfNSW on 18/6/20 by Richard Yarad &amp; updated 3/7/20 titled "RCR-IASB-TfNSW Construction Staging Meeting"</p> <p>Updated CPTMP endorsed June 20 for r5 Email response received 14-7-20 "Endorsement 14 July 2020 – IASB – TfNSW Construction Staging" (See also B15)</p> <p><b>Condition B17: Construction Worker Transport Strategy:</b> <i>Prior to the commencement of construction, the Applicant must submit a Construction Worker Transportation Strategy in consultation with the Sydney Coordination Office within Transport for New South Wales to the satisfaction of the Certifier.</i>          Email response received from TfNSW (CBD Freight Policy &amp; Planning Manager) supporting endorsement of CPTMP &amp; CWTS with inclusion of comments dated 19/02/20.</p> <p><b>Condition B24: Construction and Demolition Waste Management:</b> <i>Prior to the commencement of the removal of any waste material from the site, the Applicant must notify the TfNSW (RMS) Traffic Management Centre of the truck route(s)</i>          Email letter sent from Lendlease Construction Manager to TfNSW (CBD Freight Policy &amp; Planning Manager) on 30 Jan 2020 which included the Construction Waste Management Plan which provided notification of waste disposal facilities and planned road routes.</p> <p><b>Condition B40 - Aboriginal Heritage</b></p>	
--	--	--	--	--	--	--	--

Randwick Campus Redevelopment

						<p>Email/Letter from Mary Dallas referencing the difference between the wording of the EIS Heritage Report &amp; DA Condition with regards to ongoing heritage monitoring – B40 currently subject to proposed modification. Modification approved and published on website advised 10/03/20)          - <a href="https://www.planningportal.nsw.gov.au/major-projects/project/27166">https://www.planningportal.nsw.gov.au/major-projects/project/27166</a></p> <p><b>SCHEDULE 3 - MODIFICATION TO SSD 9113</b> -: .... in consultation with Council and submitted to the satisfaction of the Planning Secretary prior to installation  <b>Refer to</b> Randwick City Council Meeting – Date 1 Apr 2020 - Meeting Minutes 010          Item – Design 5.2 – Magill Street Boom Gate – RCC confirmed support of the layout and single boomgate option.</p> <p>Others</p> <ul style="list-style-type: none"> <li>b) Online meeting 25<sup>th</sup> March 2020 with FRNSW facilitated by HI – Presentation of Loading Dock Fire Strategy.</li> <li>c) LLB &amp; PWC presented LHD – Loading Dock Security at meeting on 22<sup>nd</sup> May 2019</li> <li>d) FEBQs issued to PwC for submission to FRNSW for “Hospital Road fire booster relocation strategy”- April 2020. Refer aconex LL-GCOR-016798</li> </ul> <p>Notification of Hospital Rd changes issued to TFNSW via email dated 15 December 2020 from Richard Yarad.          Filename: <i>Randwick Campus Redevelopment - Traffic switch Hospital Rd - SSD10339</i>          Register of complaints and communications is in effect          Document Title: Randwick Campus Redevelopment Community Contact and Complaint Spreadsheet          Filename: "RCR Community Contact and Complaints" Live document.</p>	
<p><b>Staging</b></p>							

Randwick Campus Redevelopment

A9	The project may be constructed and operated in stages. Where staged construction or operation is proposed, a Staging Report (for either or both construction and operation as the case may be) must be prepared and submitted for the approval of the Planning Secretary. The Staging Report must be submitted to the Planning Secretary no later than one month before the commencement of construction of the first of the proposed stages of construction (or if only staged operation is proposed, one month before the commencement of operation of the first of the proposed stages of operation).	NA	Submission & approval to Planning Secretary	Contractor	It has been confirmed that the Project is not programmed on a Staging Requirement.	Staging report for IASB issued 10/12/20 to PWC Document: <b>RCR State Significant Development ISSD10339: Staging Report</b> File Name: <i>RCR- IASB 10339 - Staging Report #1 Rev2</i> Prepared by Lendlease Building Dated 10/12/2020  Staging Report #1 DPIE RFI titled "RFI Request for Post Approval_15022021_094525" dated 15 <sup>th</sup> February 2021. Updates and responses issued to PWC by email 18 <sup>th</sup> March 2020. Approval pending.  Approval pending	Compliant
A10	A Staging Report prepared in accordance with condition A9 must: (a) if staged construction is proposed, set out how the construction of the whole of the project will be staged, including details of work and other activities to be carried out in each stage and the general timing of when construction of each stage will commence and finish; (b) if staged operation is proposed, set out how the operation of the whole of the project will be staged, including details of work and other activities to be carried out in each stage and the general timing of when operation of each stage will commence and finish (if relevant); (c) specify how compliance with conditions will be achieved cross and between each of the stages of the project; and (d) set out mechanisms for managing any cumulative impacts arising from the proposed staging.	NA		Contractor	Not applicable	Staging report for IASB issued 10/12/20 to PWC Document: <b>RCR State Significant Development ISSD10339: Staging Report</b> File Name: <i>RCR- IASB 10339 - Staging Report #1 Rev2</i> Prepared by Lendlease Building Dated 10/12/2020  Staging Report #1 DPIE RFI titled "RFI Request for Post Approval_15022021_094525" dated 15 <sup>th</sup> February 2021. Updates and responses issued to PWC by email 18 <sup>th</sup> March 2020.  Approval pending	Compliant
A11	Where staging is proposed, the project must be staged in accordance with the Staging Report, as approved by the Planning Secretary.	NA	submission & approval to Planning Secretary	Contractor	Not applicable	Not applicable as yet as Staging plan not approved	Not triggered
A12	Where staging is proposed, the terms of this approval that apply or are relevant to the works or activities to be carried out in a specific stage must be complied with at the relevant time for that stage.	NA		Contractor	Not applicable	Not applicable as yet as Staging plan not approved	Not triggered

Staging, Combining and Updating Strategies, Plans or Programs



Randwick Campus Redevelopment

<p><b>A13</b></p>	<p>The Applicant may:                  (a) prepare and submit any strategy, plan (including management plan, architectural or design plan) or program required by this consent on a staged basis (if a clear description is provided as to the specific stage and scope of the development to which the strategy, plan (including management plan, architectural or design plan) or program applies, the relationship of the stage to any future stages and the trigger for updating the strategy, plan (including management plan, architectural or design plan) or program);                  (b) combine any strategy, plan (including management plan, architectural or design plan), or program required by this consent (if a clear relationship is demonstrated between the strategies, plans (including management plan, architectural or design plan) or programs that are proposed to be combined); and                  (c) Update any strategy, plan (including management plan, architectural or design plan), or program required by this consent (to ensure the strategies, plans (including management plan, architectural or design plan), or programs required under this consent are updated on a regular basis and incorporate additional measures or amendments to improve the environmental performance of the development).</p>	<p>NA</p>		<p>Contractor</p>		<p>Staging report for IASB issued 10/12/20 to PWC                  Document: <b>RCR State Significant Development ISSD10339: Staging Report</b>                  File Name: <i>RCR- IASB 10339 - Staging Report #1 Rev2</i>                  Prepared by Lendlease Building                  Date 10/12/2020</p> <p>Staging Report #1 DPIE RFI titled "RFI Request for Post Approval_15022021_094525" dated 15<sup>th</sup> February 2021. Updates and responses issued to PWC by email 18<sup>th</sup> March 2020.</p> <p>Approval pending</p> <p>See Management Plan Tracking Matrix                  Filenamed; SSD10339 Management Plans Register                  Nov 20 Rev 1.2                  Dated :November 2020                  Issued as evidence in IA#2 on 3/12/20 by ACONEX LL-GCOR-029247</p> <p>Non-Compliance: Documentation has not been issued to the PCA consistently</p> <p>December 2020 Management Plan revision:                  Notification issued to PCA 21<sup>st</sup> December 2020 by Aconex LL-GCOR-030228                  Notification issued to PWC 14th December 2020 LL-GCOR-029744                  DPIE notification lodged 17<sup>th</sup> December 2020                  DPIE post approval notice issued                  Filename: "Prince of Wales Hospital - Addition to approved Acute Services Building - Post Approval Document Received - (SSD-10339-PA-20)"                  Dated: 17<sup>th</sup> December 2020</p>	<p>Compliant</p>
<p><b>A14</b></p>	<p>The Planning Secretary must approve any strategy, plan or program prepared in accordance with condition A13 where previously approved by the Planning Secretary under this consent.</p>	<p>NA</p>	<p>If the Planning Secretary agrees,</p>	<p>Note</p>	<p>Record keeping for communications with the Planning Secretary.</p>	<p>Documentation as approved by Planning Secretary. To date, there is nothing that requires approval.</p>	<p>Not Triggered</p>

Randwick Campus Redevelopment

A15	If the Planning Secretary agrees, a strategy, plan (including management plan, architectural or design plan), or program may be staged or updated without consultation being undertaken with all parties required to be consulted in the relevant condition in this consent.	NA	If the Planning Secretary agrees,	Note	Record keeping for communications with the Planning Secretary.	Not applicable	Not triggered
A16	Updated strategies, plans (including management plan, architectural or design plan), or programs supersede the previous versions of them and must be implemented in accordance with the condition that requires the strategy, plan, program or drawing.	NA	If approved by the Planning Secretary,	Contractor	Filing Approvals issued by the Planning Secretary	Not applicable	Not triggered
<b>Structural Adequacy</b>							
A17	All new buildings and structures, and any alterations or additions to existing buildings and structures, that are part of the development, must be constructed in accordance with the relevant requirements of the BCA.	At all times		Contractor	Application for construction and occupation certificates Engineering and Design Plan Reviews	<p><b>Documentation issued for CC1</b></p> <p>Document Title; Randwick Campus Redevelopment – Acute Services Building – Structural Design Certificate for Crown Certificate CC1 – Conditions A4, A17 &amp; B3 Prepared by: Enstruct group Dated -23 Jan 2020</p> <p><b>Submitted to PCA</b> Via aconex corro. Ref: LL-GCOR-014451 Consultant Enstruct Group Sent: 29 Jan 20</p> <p><b>Approval from PSA</b> Via Crown Certificate No 19/124846-5 Issued: 18 Mar 2020</p> <p><b>Documents issued for CC2</b></p> <p>Document Title; SSD10339 Structural Design Certificate for Crown Certificate CC2 – Conditions A4, A17 &amp; B3 Filename: 19. SSD10339 Structural Design Certificate Prepared by: Enstruct group Dated -28<sup>th</sup> July 2020</p> <p><b>Submitted to PCA</b> Via aconex corro. Ref: LL-GCOR-023873 Consultant Enstruct Group Sent: 27-8-20</p>	Compliant

Randwick Campus Redevelopment

					<p><b>Approval from PSA</b> Via Crown Certificate No 20/124846-7 Issued: 28-9-2020</p> <p>Document Title; SSD10339 Structural Piling Design Certificate #2 for Crown Certificate CC2 – Conditions A4, A17 &amp; B3 Filename 18. SSD10339 Structural Piling Design Certificate #2 - 28 July 2020 Prepared by: Pile Design Solutions group Dated -28<sup>th</sup> July 2020</p> <p><b>Submitted to PCA</b> Via aconex corro. Ref: LL-GCOR-023873 Consultant Pile Design Solutions Group Sent: 27-8-20</p> <p><b>Approval from PSA</b> Via Crown Certificate No 20/124846-7 Issued: 28-9-2020</p> <p><b>Documents issued for CC3</b></p> <p>Document Title; Randwick Campus Redevelopment – Integrated Acute Services Building and lowering of Hospital Road Structural Design Certificate for Crown Certification CC3 (Amended Design) DA Number: SSD10339 Filename: 9 - SSD10339 CC3 - Structural Design Certificate - Enstruct Prepared by: Enstruct group Dated -18<sup>th</sup> December 2020</p> <p><b>Submitted to PCA</b> Via aconex corro. Ref: LL-GCOR-030369 Consultant Enstruct Group Sent: 04-01-2021</p> <p><b>Approval from PSA</b> Via Crown Certificate</p>
--	--	--	--	--	---

Randwick Campus Redevelopment

						<p>No 21/124846-9          Issued: 22-1-2021          ACONEX: MGC-GCOR-000699</p> <p>Document Title; SSDA 10339 – CC3 Submission          Design Certification – Amended Shoring and Foundation          Piles Integrated Acute Services Building and Lowering of          Hospital Road, Randwick          Filename 10 - SSD10339 CC3 - Foundation and Shoring          Pile Design Certificate - PDS          Prepared by: Pile Design Solutions group          Dated -16<sup>th</sup> December 2020</p> <p><b>Submitted to PCA</b>          Via aconex corro.          Ref: LL-GCOR-030369          Consultant Pile Design Solutions group          Sent: 04-01-2021</p> <p><b>Approval from PSA</b>          Via Crown Certificate          No 21/124846-9          Issued: 22-1-2021          ACONEX: MGC-GCOR-000699</p>	
<b>External Walls and Cladding</b>							
<b>A18</b>	The external walls of all buildings including additions to existing buildings must comply with the relevant requirements of the BCA.	At all times		Contractor	Record keeping for communications with the Certifier.	Not applicable to CC1 & 2, to be satisfied under CC3	Not triggered
<b>Applicability of Guidelines</b>							
<b>A19</b>	References in the conditions of this consent to any guideline, protocol, Australian Standard or policy are to such guidelines, protocols, Standards or policies in the form they are in as at the date of this consent.	At all times		Note	Record Keeping System for communications with the Planning Secretary, Department Management Plans/ Sub-plans	<b>Management Plans &amp; Sub-plans</b> Management Plans and Sub-plans contain guidelines, AS and protocols as current to date of this Consent.	Compliant
<b>A20</b>	Consistent with the conditions of this consent and without altering any limits or criteria in this consent, the Planning Secretary may, when issuing directions under this consent in respect of ongoing monitoring and management obligations, require compliance with an updated or revised	At all times		Note	Monitoring or audit methodology statements	Monitoring reports & Audit reports for the below directives when requested.  Directives Received to date: <ul style="list-style-type: none"> <li>Preconstruction compliance report format feedback was received and the CCR revised to</li> </ul>	Not triggered

Randwick Campus Redevelopment

	version of such a guideline, protocol, Standard or policy, or a replacement of them.					<ul style="list-style-type: none"> <li>include evidence of key correspondences and submissions to the Certifier, Planning Secretary and/or other Agencies, as per DPIE email 1 May 2020 DPIE Post Approval Document PA-9</li> <li>ESD guidelines – alterations and procedures for alternate guideline DPIE letter dated 10/2/2020. Reference B8 for details.</li> <li>Staging Report #1 Feedback and responses to RFI titled "RFI Request for Post Approval_15022021_094525" dated 15<sup>th</sup> February 2021. Updates and responses issued to PWC by email 18<sup>th</sup> March 2020. Approval pending.</li> </ul>	
<b>Monitoring and Environmental Audits</b>							
A21	<p>Any condition of this consent that requires the carrying out of monitoring or an environmental audit, whether directly or by way of a plan, strategy or program, is taken to be a condition requiring monitoring or an environmental audit under Division 9.4 of Part 9 of the EP&amp;A Act. This includes conditions in respect of incident notification, reporting and response, non-compliance notification, Site audit report and independent auditing.</p> <p>Note: For the purposes of this condition, as set out in the EP&amp;A Act, "monitoring" is monitoring of the development to provide data on compliance with the consent or on the environmental impact of the development, and an "environmental audit" is a periodic or particular documented evaluation of the development to provide information on compliance with the consent or the environmental management or impact of the development.</p>	At all times		Contractor	Monitoring or audit methodology statements	<ul style="list-style-type: none"> <li>Independent Audits held as specified in Independent Audit Programme prepared under Conditions C36</li> <li>Independent Reports under Condition C40 received and responded to under Condition C41 until satisfied</li> <li>Condition Compliance status as per Compliance Reports under Conditions B28 &amp; B29</li> <li>Staging Report submitted and approved under Conditions A9 and A10</li> <li>Incident and Notification as per Condition requirements A24 and A25</li> </ul> <p>Refer to relevant conditions for details</p>	Compliant
<b>Access to Information</b>							
A22	<p>At least 48 hours before the commencement of construction until the completion of all works under this consent, or such other time as agreed by the Planning Secretary, the Applicant must:</p> <p>(a) make the following information and documents (as they are obtained or approved) publicly available on its website:</p> <p>(i) the documents referred to in condition A2 of this consent;</p>	<p>Crown Certificate s:</p> <p>CC1 - Mar 2020</p> <p>CC2 –</p>		<p>Contractor to issue to HI</p> <p>HI to publish</p>	Record keeping for communications with the Certifier.	<p>Check Website for public access to all the information and documents listed in A22.</p> <p><b>NON-COMPLIANCE:</b> Updated management plans which have been approved by the Certifier (CC2) have not have been uploaded to the website.</p> <p><b>Web site:</b></p>	Compliant

**Randwick Campus Redevelopment**

	<p>(ii) all current statutory approvals for the development;          (iii) all approved strategies, plans and programs required under the conditions of this consent;          (iv) regular reporting on the environmental performance of the development in accordance with the reporting arrangements in any plans or programs approved under the conditions of this consent;          (v) a comprehensive summary of the monitoring results of the development, reported in accordance with the specifications in any conditions of this consent, or any approved plans and programs;          (vi) a summary of the current stage and progress of the development;          (vii) contact details to enquire about the development or to make a complaint;          (viii) a complaints register, updated monthly;          (ix) audit reports prepared as part of any independent audit of the development and the Applicant's response to the recommendations in any audit report;          (x) any other matter required by the Planning Secretary; and          (b) keep such information up to date, to the satisfaction of the Planning Secretary.</p>	<p>July 2020           CC3 –Dec 2020           *requirement: 48 hours prior to construction start</p>				<p><a href="http://randwickcampusredevelopment.health.nsw.gov.au/projects/integrated-acute-services-building-addition/ssd-10339-documentation">http://randwickcampusredevelopment.health.nsw.gov.au/projects/integrated-acute-services-building-addition/ssd-10339-documentation</a></p> <p>Non Compliance closed as all management plans loaded onto the website 31/3/21</p> <p>Available documents on the website include:</p> <ol style="list-style-type: none"> <li>1. Construction and environmental Management Plan (Condition B11)</li> <li>2. Construction Traffic and Pedestrian Management Plan (Condition B15)</li> <li>3. Construction Worker Transportation Strategy (Condition B17)</li> <li>4. Biodiversity – Fauna Report (Condition B41)</li> <li>5. Construction Noise and Vibration Management Plan</li> <li>6. Construction Waste management Plan</li> <li>7. Stormwater and Erosion Management Plan</li> <li>8. Air Quality Management Plan</li> <li>9. Groundwater Management Plan</li> <li>10. Remediation Action Plan</li> <li>11. Site Audit Statement</li> <li>12. Compliance Report</li> </ol> <p>a-i) available          a-ii) available          a-iii) available          a-vi) No regular reporting as yet but reports will be uploaded as obtained.          a-v) A comprehensive summary of the monitoring results are available on the website above</p> <p>vi) Regular project updates are available on the project website's dedicated Integrated Acute Services Building Addition page. Updates are provided through Community and Stakeholder Fact Sheets that are updated regularly in alignment with project progress and milestones.</p> <p>vii) The project maintains a 24/7 Community Contact phone number and project email address for general inquiries and complaints management. Contact details</p>	
--	---	---	--	--	--	--	--

Randwick Campus Redevelopment

						<p>are available of project site signage, all communication collateral and the project website.</p> <p>viii) A monthly complaint register is housed on the project website documenting community complaints and project response. This register is available on the website above</p> <p>ix) Independent audit reports are available on the website above</p> <p>x) Any other matters required by the planning secretary will be uploaded upon request and as required. The project page is actively monitored and updated to reflect currency in documentation.</p> <p>b) The information that has been provided online, is up to date with the current phase .</p>	
<b>Compliance</b>							
<b>A23</b>	The Applicant must ensure that all of its employees, contractors (and their sub-contractors) are made aware of, and are instructed to comply with, the conditions of this consent relevant to activities they carry out in respect of the development.	At all times		Note	Instruction to comply with conditions include in minor contract template	<p>Head Contract requires LLB to comply with all conditions of consent under SSDA10339</p> <p>Staff are made aware through various ongoing meetings and discussions.</p> <p>DA Conditions form part of the Subcontractors Major Works Subcontract – Subcontracts No 261973-005 used as example: Listed under 'Management Plans &amp; Authorities' – referenced as: "SSD-10339 SSDA Approval Conditions – Addition to the Approved Acute Services Building</p> <p>Refer to Aconex LL-GCOR-014472 – notification to all D &amp; C Contractor for Lowering of Hospital Road in accordance to Condition A23.</p>	Compliant
<b>Incident Notification, Reporting and Response</b>							
<b>A24</b>	The Department must be notified in writing to compliance@planning.nsw.gov.au immediately after the Applicant becomes aware of an incident. The notification must identify the development (including the development application number and the name of the development if it	At all times		Contractor /LHD	Record Keeping System for communications with the Planning	Department notification issued to PWC and HI for rainwater release event 29-3-21 via ACONEX LL-GCOR-034910	Compliant

Randwick Campus Redevelopment

	has one) and set out the location and nature of the incident.						
A25	Subsequent notification must be given, and reports submitted in accordance with the requirements set out in Appendix 2.	At all times		Contractor /Principal/ LHD	Record Keeping System for communications with the Planning Department for Incident Notification & Reporting	Department notification	Not triggered
<b>Non-Compliance Notification</b>							
A26	The Planning Secretary must be notified in writing to compliance@planning.nsw.gov.au within seven days after the Applicant becomes aware of any non-compliance. The Certifier must also notify the Department in writing to compliance@planning.nsw.gov.au within seven days after they identify any non-compliance.	Notification within 7 days	Notification to Planning Secretary	Contractor /Principal/ LHD	Record Keeping System for communication with the Planning Secretary & Certifier	<p>Non-Compliances as noted in table 6 of this Construction Report – Non compliances to be notified within 7 days of this report.</p> <p>Non compliance letter:  Filename: SSD10339 - Condition B3 - Non-Compliance Notification  Dated: 29<sup>th</sup> July 2020  Post Approval PA13 from DPIE dated 29-7-20</p> <p>IASB Audit report findings  Title: Independent Audit Report Randwick Campus Redevelopment Integrated Acute Services Building (IASB) SSD 20339 Report Number 1.  Filename: IASB Audit Report July 2020 Final Rev0.pdf  Dated 22<sup>nd</sup> July 2020 by NGH</p> <p>Notice of Non-Compliance  Filename: SSD10339 - Condition C7 - Non-Compliance Notification  Dated: 7<sup>th</sup> August 2020</p> <p>Notice of Non-Compliance letter:  Filename: SSD10339 - Condition B5 - Potential Non-Compliance Notification  Dated 1<sup>st</sup> September 2020</p> <p>Notice of Non-Compliance letter:  Filename: SSD10339 - Condition A22 Non Compliance Notification  Dated 8<sup>th</sup> December 2020</p> <p>Notice of Non-Compliance letter:</p>	Compliant



Randwick Campus Redevelopment

						<p>Filename: SSD10339 - Condition B35 Non Compliance Notification Dated 8<sup>th</sup> December 2020</p> <p>Notice of Non-Compliance letter: Filename: SSD10339 - Condition B30 Non Compliance Notification Dated 8<sup>th</sup> December 2020</p> <p>Notice of Non-Compliance letter: Filename: SSD10339 - Condition A29 Non Compliance Notification Dated 10<sup>th</sup> December 2020</p> <p>DPIE Post Approval Receipt Filename: 201210 SSD10339 - A26 Non Compliance Notification Receipt - (SSD-10339-PA-16) Dated 11<sup>th</sup> December 2020 ACONEX PWCAU-GCOR-009304</p>	
<b>A27</b>	The notification must identify the development and the application number for it, set out the condition of consent that the development is non-compliant with, the way in which it does not comply and the reasons for the non-compliance (if known) and what actions have been, or will be, undertaken to address the non-compliance.	At all times		Contractor /Principal/ LHD	Record Keeping System for communication with the Planning Secretary & Certifier	Details to be included in notification as per requirements of A27	Compliant
<b>A28</b>	A non-compliance which has been notified as an incident does not need to also be notified as a non-compliance.	At all times		Contractor /Principal/ LHD	Note	Note	Not triggered

Randwick Campus Redevelopment

Revision of Strategies, Plans and Programs							
A29	<p>Within three months of:</p> <p>(a) the submission of a compliance report under condition B30;</p> <p>(b) the submission of an incident report under condition A25 ;</p> <p>(c) the submission of an Independent Audit under condition C41;</p> <p>(d) the approval of any modification of the conditions of this consent; or</p> <p>(e) the issue of a direction of the Planning Secretary under condition A2 which requires a review, the strategies, plans and programs required under this consent must be reviewed, and the Department and the Certifier must be notified in writing that a review is being carried out. If necessary, to either improve the environmental performance of the development, cater for a modification or comply with a direction, the strategies, plans and programs required under this consent must be revised, to the satisfaction of the Certifier. Where revisions are required, the revised document must be submitted to the Certifier for approval within six weeks of the review.</p> <p>Note: This is to ensure strategies, plans and programs are updated on a regular basis and to incorporate any recommended measures to improve the environmental performance of the development.</p>	<p>Within 3 months with regards to items a), b), c), d) &amp; e).</p> <p>If required documents to be submitted to Certifier for approval within 6 weeks of the review.</p>		Contractor		<p>Notification to Department and Certifier, that a review is being undertaken.</p> <p>Any change to be provided to the satisfaction of the Certifier.</p> <p>A register of management plans and strategies has been prepared by Lendlease to profile the extent of compliance against Condition A13 and A29.</p> <p>See Management Plan Tracking Matrix            Filenamed; SSD10339 Management Plans Register            Nov 20 Rev 1.2            Dated :November 2020            Issued as evidence in IA#2 on 3/12/20 by ACONEX LL-GCOR-029247</p> <p>Aconex to Certifier to clarify satisfaction based on CC2 of all management plans LL-GCOR-029151</p> <p>Non Compliance is that notification of a review being undertaken was not submitted to the Certifier or the Department.</p> <p>December 2020 Management Plan revision:            Notification issued to PCA 21<sup>st</sup> December 2020 by Aconex LL-GCOR-030228            Notification issued to PWC 14<sup>th</sup> December 2020 LL-GCOR-029744            DPIE notification lodged 17<sup>th</sup> December 2020            DPIE post approval notice issued            Filename: "Prince of Wales Hospital - Addition to approved Acute Services Building - Post Approval Document Received - (SSD-10339-PA-20)"            Dated: 17<sup>th</sup> December 2020</p> <p>March 2021 Management Plan revision:            Notification issued to PCA &amp; PWC 25<sup>th</sup> March 2021 by Aconex LL-GCOR-034718            Notification issued to HI 30<sup>th</sup> March 2021</p>	Compliant

Randwick Campus Redevelopment

<b>Noise Mitigation Strategy</b>							
<b>A30</b>	The Applicant must provide a Noise Mitigation Strategy prepared by a suitably qualified acoustic consultant for the approval of the Planning Secretary identifying mitigation measures, including architectural treatments (if required) to be offered to all residences on the southern side of Magill Street, to ensure the internal noise levels do not exceed the sleep disturbance criteria in accordance with the Noise Policy for Industry (EPA 2017). If accepted the treatments must be installed at no cost to the resident.	At all times	Approval of Planning Secretary if mitigation measure were required.	Contractor	Acoustic Report (acoustic Logic) includes details of McGill Street monitoring.	<p>Acoustic Logic have the necessary experience and have been engaged as specialist Noise and Vibration Consultants.</p> <p>Acoustic Logic has undertaken noise studies along Magill Street which identified no current noise exceedances.</p> <p>Refer to <b>Acoustic Logic</b> letter dated 28/01/20 – Titled Randwick Hospital Redevelopment – CC2, Condition B61.</p> <p>Note SSD9113 Condition B61 is technically the same requirements as SSD 10339 Condition A30. <i>“..... external noise level would be less than 58db(A) L max and would therefore be compliant with the nominated maximum emergence level criteria presented in the Noise and Vibration Impact assessment prepared by Acoustic Studio.”</i></p> <p>No treatment strategy required.</p>	Not Triggered

Randwick Campus Redevelopment

Transport Network Operation							
A31	The Applicant must consult with TfNSW, including its Sydney Coordination Office and TfNSW (RMS), to identify measures to mitigate impacts on the surrounding road network associated with the closure of Hospital Road at High Street.	During periods of Hospital Road & High Road closure		Contractor	Record Keeping System for communication with TfNSW.	<p>Lendlease (Construction Manager) issued CPTMP &amp; CWTS to TfNSW (CBD Freight Policy &amp; Planning Manager) on 19<sup>th</sup> Dec 2019 for review</p> <p>Email response received from TfNSW (CBD Freight Policy &amp; Planning Manager) supporting endorsement of CPTMP &amp; CWTS with inclusion of comments dated 19/02/20.</p> <p>Updated CEMP Rev 2 Re-issued to PCA Via Aconex LL-GCOR-015861 Date 10 Mar 2020</p> <p>Updated CTPMP_IASB_June20_r5 issued by email to pwc &amp; TfNSW on 18/6/20 by Richard Yarad &amp; updated 3/7/20 titled "RCR-IASB-TfNSW Construction Staging Meeting"</p> <p>Updated CPTMP endorsed June 20 for r5 Email response received 14-7-20 "Endorsement 14 July 2020 – IASB – TfNSW Construction Staging" (See also B15)</p> <p>Read in conjunction with Condition B7 &amp; A8</p>	Compliant
Amendments to Consent SSD 9113							
A32	The Applicant must deliver a notice of modification to the consent authority that complies with clause 97 of the Environmental Planning and Assessment Regulation 2000, within six months of the date of this determination. The notice must set out the modifications to conditions in SSD 9113 that are listed in Schedule 3 of this consent.	6 months date of determination		Contractor /Principal/ LHD	record keeping for to satisfaction of Council & TfNSW	<p>Refer to Schedule 3 of SSDA 10339. Opening of Magill Street to have boomgate and signage in lieu of removable bollards</p> <p>Modification 2 for SSD 9113 issued to Health Infrastructure dated 26<sup>th</sup> June 2020 lodged to the consent authority on the 29<sup>th</sup> June 2020 titled "Notice of Modification to SSD 9113" pertaining to Clause A15 of SSD9113</p> <p>Record of lodgement and post approval document was issued by DPIE on the 29/6/20 in email to Claire Muir of HI.</p> <p>Evidence of consultation requested by DPIE below:</p>	Compliant

Randwick Campus Redevelopment

RCC Coordination Meeting – Date 7 Oct 2020 - Meeting Minutes 016  
Item – Previous Actions 2.4  
Filename: 200107 - RCC Coord Meeting - Meeting 016 – Minutes  
also  
Meeting – Date 4 Nov 2020 - Meeting Minutes 017  
Item – Previous Actions 2.4  
Filename: 2001103 - RCC Coord Meeting - Meeting 017 - Minutes

Modification Notification has been approved and a meeting held with RCC on 25<sup>th</sup> February to discuss modification to SSD10339 to remove boom gate condition

Meeting - Date 25<sup>th</sup> February 2021  
Email notes and presentation sent 1<sup>st</sup> March 2021 from C. Mazza of PWC to T.Lehmann of RCC.

No response has been issued from RCC to date. HI to address with DPIE.

Randwick Campus Redevelopment

PART B PRIOR TO COMMENCEMENT OF CONSTRUCTION							
Notification of Commencement							
B1	The Department must be notified in writing of the dates of commencement of physical work and operation at least 48 hours before those dates.	Prior to Construction Works		Contractor	Record Keeping System for communications with the Department advising construction start date	<p>PwC aconex to HI Planning: PWCAU-GCOR-006707: titled SSDA 10339: Condition B1: notification of Commencement Dated 19 March 2020</p> <p>Acknowledgment email letter from Health Infrastructure (CM) to the Department (EW) attaching B1 : Notification of Commencement.- dated 20<sup>th</sup> March 2020</p>	Compliant
B2	If the construction or operation of the development is to be staged, the Department must be notified in writing at least 48 hours before the commencement of each stage, of the date of commencement and the development to be carried out in that stage.	Prior to Construction Works of any stage		Contractor	Record Keeping System for communications with the Department advising construction start date	<p>Staging report for IASB issued 10/12/20 to PWC Document: <b>RCR State Significant Development ISSD10339: Staging Report</b> File Name: <i>RCR- IASB 10339 - Staging Report #1 Rev2</i> Prepared by Lendlease Building Date 10/12/2020</p> <p>Staging Report #1 Feedback and responses to RFI titled "RFI Request for Post Approval_15022021_094525" dated 15<sup>th</sup> February 2021. Updates and responses issued to PWC by email 18<sup>th</sup> March 2020.</p> <p>Approval pending</p>	Compliant
Certified Drawings							
B3	Prior to the commencement of construction, the Applicant must submit to the satisfaction of the Certifier structural drawings prepared and signed by a suitably qualified practising Structural Engineer that demonstrates compliance with the relevant clauses of the BCA and this development consent.	Prior to Construction		Contractor / Structural Consultant	<p>Copy of records / certificates of Compliance.</p> <p>Record Keeping for communications with the certifier.</p>	<p>Certificate of Compliance from Structural Engineer for CC1 works Prepared by: Enstruct Group Also refer to A4 &amp; A17</p> <p><b>Submitted to PCA</b> Via aconex corro. Ref: LL-GCOR-014451 Consultant Enstruct Group Sent: 29 Jan 20</p> <p><b>Approval from PCA</b> Via Crown Certificate No 19/124846-5</p>	Compliant

Randwick Campus Redevelopment

Issued: 18 Mar 20

Documents issued for CC2

Document Title; SSD10339 Structural Design Certificate for Crown Certificate CC2 – Conditions A4, A17 & B3  
Filename: 19. SSD10339 Structural Design Certificate  
Prepared by: Enstruct group  
Dated -28<sup>th</sup> July 2020

**Submitted to PCA**  
Via aconex corro.  
Ref: LL-GCOR-023873  
Consultant Enstruct Group  
Sent: 27-8-20

**Approval from PSA**  
Via Crown Certificate  
No 20/124846-7  
Issued: 28-9-2020

Document Title; SSD10339 Structural Piling Design Certificate #2 for Crown Certificate CC2 – Conditions A4, A17 & B3  
Filename 18. SSD10339 Structural Piling Design Certificate #2 - 28 July 2020  
Prepared by: Pile Design Solutions group  
Dated -28<sup>th</sup> July 2020

**Submitted to PCA**  
Via aconex corro.  
Ref: LL-GCOR-023873  
Consultant Pile Design Solutions Group  
Sent: 27-8-20

**Approval from PSA**  
Via Crown Certificate  
No 20/124846-7  
Issued: 28-9-2020

Non compliance letter:  
Filename: SSD10339 - Condition B3 - Non-Compliance Notification  
Dated: 29<sup>th</sup> July 2020

**Documents issued for CC3**

Document Title; Randwick Campus Redevelopment – Integrated Acute Services Building and lowering of Hospital Road Structural Design Certificate for Crown Certification CC3 (Amended Design) DA Number: SSD10339  
Filename: 9 - SSD10339 CC3 - Structural Design Certificate - Enstruct  
Prepared by: Enstruct group  
Dated -18<sup>th</sup> December 2020

**Submitted to PCA**

Via aconex corro.  
Ref: LL-GCOR-030369  
Consultant Enstruct Group  
Sent: 04-01-2021

**Approval from PSA**

Via Crown Certificate  
No 21/124846-9  
Issued: 22-1-2021  
ACONEX: MGC-GCOR-000699

Document Title; SSDA 10339 – CC3 Submission Design Certification – Amended Shoring and Foundation Piles Integrated Acute Services Building and Lowering of Hospital Road, Randwick  
Filename 10 - SSD10339 CC3 - Foundation and Shoring Pile Design Certificate - PDS  
Prepared by: Pile Design Solutions group  
Dated -16<sup>th</sup> December 2020

**Submitted to PCA**

Via aconex corro.  
Ref: LL-GCOR-030369  
Consultant Pile Design Solutions group  
Sent: 04-01-2021

**Approval from PSA**

Via Crown Certificate  
No 21/124846-9



Randwick Campus Redevelopment

						Issued: 22-1-2021 ACONEX: MGC-GCOR-000699	
<b>External Walls and Cladding</b>							
<b>B4</b>	Prior to the commencement of construction of the façade, the Applicant must provide the Certifier with documented evidence that the products and systems proposed for use or used in the construction of external walls, including finishes and claddings such as synthetic or aluminium composite panels, comply with the requirements of the BCA.	Prior to Construction		Contractor - Façade Designer Architect	Record keeping for communications with the Certifier.	Letter issued by Lendlease and accepted by the Certifying Authority noting condition not applicable to CC1 to be satisfied under future CC inline with the current staging plan V0.3 to be approved. To be read in conjunction with Condition A18.	Not triggered
<b>B5</b>	The Applicant must provide a copy of the documentation given to the Certifier to the Planning Secretary within seven days after the Certifier accepts it.	Prior to Construction - within 7 days after Certifier approval	Copy of documentation to Planning Secretary	Contractor	Record Keeping for communications with the Planning Secretary	Potential Non compliance letter: Filename: SSD10339 - Condition B5 - Potential Non-Compliance Notification Dated 1 <sup>st</sup> September 2020	Not Triggered
<b>Protection of Public Infrastructure</b>							
<b>B6</b>	Prior to the commencement of construction, the Applicant must: (a) consult with the relevant owner and provider of services that are likely to be affected by the development to make suitable arrangements for access to, diversion, protection and support of the affected infrastructure; (b) prepare a dilapidation report identifying the condition of all public infrastructure in the vicinity of the site (including roads, gutters and footpaths); and (c) submit a copy of the dilapidation report to the Planning Secretary, Certifier and Council.	Prior to Construction  CC1 - Mar 2020  CC2 – July 2020  CC3 –Dec 2020	copy of report to Planning Secretary	Contractor	Record Keeping for Consultation/ Communications with Service Owners/ Providers  Record Keeping for communications with the Certifier  Record Keeping System for communications with the Planning Secretary and Council  Record Keeping for communications with the certifier.	<b>B6 (a): Submitted to PCA</b> Via aconex corro. Ref: LL-GCOR-014620 Sent: 4 Feb 2020 & Ref: LL-GCOR-015438 27 Feb 2020  Sydney Water – Wastewater – major (case Number 180989) Evidence of communications; e) Letter of Requirements – Adjustment of a Sydney Water Asset – dated 24 Sept 2019. f) Job Specific Information Letter – 18 Feb 2020 g) Bonding of works for deviation of a Sydney Water sewer main – dated 18 Feb 20.	Compliant

Randwick Campus Redevelopment

					<p>h) Sydney Water – Developer Works Deed signed by Acor &amp; HI.</p> <p>-----</p> <p>Achieved since CC1 Submission.  Ausgrid SC11992 – RCR Chamber &amp; Feeders – Deed of Agreement for Lease (unexecuted)  Ausgrid – SC14233 – Hospital Rd Relocations – Deed of Agreement for Easement</p> <p>Note: Other services that are located in close proximity or in the site boundary are private assets owned by the Hospital these being;  Water, gas, communications, medical gas and LV power</p> <p>-----</p> <p>Achieved CC2 Submission.  Sydney Water SC180989WW – Sewer adjustment &amp; deviation plans approved stamped 5-5-2020. Plans and Deed poll titles starting “B6 – CASE180989WW...”  Ausgrid – AN11992 and AB14223 adjustments as requested file titled “B6 = Ausgrid email – Deed of Agreement – AN11992 and AN 14233”</p> <p><b>B6 (b):</b>  <b>Submitted to PCA</b>  Dilapidation Reports Via aconex corro.  Ref: LL-GCOR-014620  Sent: 4 Feb 20  <b>Approval from PCA</b>  Via Crown Certificate  No 19/124846-5  Issued: 18 Mar 20</p> <p>i) Barker &amp; High Streets Randwick Dilap Survey Report prepared by James Townsend on 15 Jan 2020  j) Prince of Wales Hospital – Road Survey prepared by James Townsend 20 Sept 2018  k) Royal Hospital for Women Dilap Survey Blds 16 &amp; 17 prepared by James Townsend on 26 Nov 2<sup>nd</sup> 7 6<sup>th</sup> Dec 2019</p>
--	--	--	--	--	---

Randwick Campus Redevelopment

						<p>l) Services Mark-up – Existing &amp; Future Overlay - Hospital Road prepared by Acor Consultants &amp; CMS Surveyors</p> <p>m) Sydney Children’s Hospital / Ainsworth Building – Build 1, Centre and south section prepared by James Townsend on 25 Nov &amp; 2 Dec 2019</p> <p><b>Complies with B6 (c):</b> Dilapidation Reports issued to John Flannigan Development Manager at Randwick City Council - date 27/02/20 by John Gillen (Lendlease)</p> <p>Planning Dept acknowledge receipt of Dilapidation Reports – email dated 26 Feb 2020 Title: Prince of Wales Hospital – Addition to approved acute Service Building- Dilapidation Reports</p>	
<b>CBD and South East Light Rail</b>							
<b>B7</b>	<p>Prior to commencement of construction, the Applicant must consult with and obtain written approval from TfNSW, including its Sydney Co-ordination Office and Sydney Light Rail team, in relation to the proposed construction management measures to mitigate any impacts to the operation of the CBD South East Light Rail arising from: (a) the closure of Hospital Road at High Street; and (b) excavation works and any potential flooding impacts due to the proposed development.</p>	Prior to Construction		Contractor	Record keeping for communications and approvals from TfNSW	<p>Lendlease (Construction Manager) issued CPTMP &amp; CWTS to TfNSW (CBD Freight Policy &amp; Planning Manager) on 19<sup>th</sup> Dec 2019 for review</p> <p>Email response received from TfNSW (CBD Freight Policy &amp; Planning Manager) supporting endorsement of CPTMP &amp; CWTS with inclusion of comments dated 19/02/20.</p> <p>Updated CEMP Rev 2 Re-issued to PCA Via Aconex LL-GCOR-015861 Date 10 Mar 2020</p> <p>Read in conjunction with CoC A31</p> <p>DPIE acknowledgment of submission email titled: Prince of Wales Hospital - Addition to approved Acute Services Building - Post Approval Document Received - (SSD-10339-PA-4) – date 16 March 2020</p>	Compliant

Randwick Campus Redevelopment

						<p>Updated CTPMP_IASB_June20_r5 issued by email to pwc &amp; TfNSW on 18/6/20 by Richard Yarad &amp; updated 3/7/20 titled "RCR-IASB-TfNSW Construction Staging Meeting"</p> <p>Updated CPTMP endorsed June 20 for r5 Email response received 14-7-20 "Endorsement 14 July 2020 – IASB – TfNSW Construction Staging" (See also B15)</p>	
<b>Ecologically Sustainable Development</b>							
<b>B8</b>	<p>Prior to the commencement of construction, unless otherwise agreed by the Planning Secretary, the Applicant must demonstrate that ESD is being achieved by either:</p> <p>(a) registering for a minimum 4 star Green Star rating with the Green Building Council Australia and submit evidence of registration to the Certifier; or</p> <p>(b) seeking approval from the Planning Secretary for an alternative certification process.</p>	Prior to Construction	option b being pursued - approval from Planning Secretary	Contractor	<p>a) Record Keeping for communications with the Certifier OR b) Record Keeping for communications with the Planning Secretary, Department</p>	<p>Email received from Green Building Council Australia via Wood &amp; Grieve Engineers dated 8<sup>th</sup> Oct 2019 confirming registration and project number – GS-4699DA</p> <ol style="list-style-type: none"> <li>1. GBCA Tax invoice received: GS-4699Da-A-38478</li> <li>2. Lendlease payment receipt Number 673711</li> </ol> <p>Consequently B8 (b) to be pursued HI have since instructed that the Greenstar process is not to be pursued.</p> <p>Instruction provided from HI to continue with DPIE/HI Alternative ESD strategy letter received from DPIE 10/02/20</p> <p>Change to HI ESD strategy/framework HI advice letter <b>Submitted to PCA</b> ref Aconex -LLGCOR-015384 Dated 26 Feb 20</p> <p>Instruction provided from HI to continue with DPIE/HI - endorsed alternate pathway. Change to HI ESD strategy/framework HI advice letter Submitted to PCA: ref Aconex -LLGCOR-015384 Dated 26 Feb 20 Alternative ESD pathway agreement letter received from DPIE 10/02/20. DPIE agreement letter title: ESD Framework and Guidelines – Request for agreement of Alternative</p>	<b>Compliant</b>

Randwick Campus Redevelopment

						<p>Framework File name: B18 DPIE Agreement - 191022 - HINSW ESD Framework Dated: 22 October 2019 Relevant documentation referred to above-Submitted to PCA: Aconex ref# LL-GCOR-017169 on 14 April 2020 &amp; ref# LL-GCOR-018175 on 6 May 2020</p> <p>HI &amp; DPIE run monthly meetings for ESD but no minutes are noted; Reference Email from HI to PWC dated Mon 7<sup>th</sup> December 2020 Filename: B8 Engineering Guidelines for alternative ESD Certification Meetings</p>	
--	--	--	--	--	--	--	--

Randwick Campus Redevelopment

Outdoor Lighting							
B9	Prior to commencement of lighting installation, evidence must be submitted to the satisfaction of the Certifier that all outdoor lighting within the site has been designed to comply with AS 1158.3.1:2005 Lighting for roads and public spaces – Pedestrian area (Category P) lighting – Performance and design requirements and AS 4282-2019 Control of the obtrusive effects of outdoor lighting.	Prior to commencement of outdoor lighting installation		Contractor	Record keeping for communications with the Certifier.	Not applicable to CC2	Not triggered
Environmental Management Plan Requirements							
B10	<p>Management plans required under this consent must be prepared in accordance with relevant guidelines, and include:</p> <p>(a) detailed baseline data;</p> <p>(b) details of:</p> <p>(i) the relevant statutory requirements (including any relevant approval, licence or lease conditions);</p> <p>(ii) any relevant limits or performance measures and criteria; and</p> <p>(iii) the specific performance indicators that are proposed to be used to judge the performance of, or guide the implementation of, the development or any management measures;</p> <p>(c) a description of the measures to be implemented to comply with the relevant statutory requirements, limits, or performance measures and criteria;</p> <p>(d) a program to monitor and report on the:</p> <p>(i) impacts and environmental performance of the development;</p> <p>(ii) effectiveness of the management measures set out pursuant to paragraph (c) above;</p> <p>(e) a contingency plan to manage any unpredicted impacts and their consequences and to ensure that ongoing impacts reduce to levels below relevant impact assessment criteria as quickly as possible;</p>	Note		Contractor	<p>The Construction Environmental Management Plan must be formatted to include the requirements listed in this Condition.</p> <p>Lendlease recognises the requirements of Condition B10 and will ensure that all items are complied with through the duration of the project</p>	<p>Refer to CEMP document to be read in conjunction with Condition B11</p> <p>File name: CEMP_IASB_030320 Document Title; Randwick Campus Redevelopment: Construction Environmental Management Plan Prepared by: Lendlease Dated -Feb 2020 Rev 2 – for CC1</p> <p>See Management Plan Tracking Matrix Filename; SSD10339 Management Plans Register Nov 20 Rev 1.2 Dated :November 2020 Issued as evidence in IA#2 on 3/12/20 by ACONEX LL-GCOR-029247</p> <p><b>a)</b> Refer to section 7.0: CNVMSP <b>b-i)</b> included throughout the CEMP but particular reference to Section 4 – Overview of CEMP. <b>b-ii)</b> included throughout the CEMP but particular reference to Section 4 – Overview of CEMP. <b>b-iii)</b> included throughout the CEMP but particular reference to Section 4 – Overview of CEMP &amp; section 5.0 Inspection, Monitoring, Auditing &amp; Reporting. <b>c)</b> included throughout the CEMP but particular reference to Section 4.2 Objectives &amp; Targets of the CEMP and Section 5.4 Compliance Reporting – Overview of CEMP.</p> <p><b>d)</b> included throughout the CEMP but particular reference to Section 5.2 Environmental Monitoring</p>	Compliant

Randwick Campus Redevelopment

	<p>(f) a program to investigate and implement ways to improve the environmental performance of the development over time;</p> <p>(g) a protocol for managing and reporting any:          (i) incident and any non-compliance (specifically including any exceedance of the impact assessment criteria and performance criteria);          (ii) complaint;          (iii) failure to comply with statutory requirements; and</p> <p>(h) a protocol for periodic review / update of the plan and any updates in response to incidents or matters of non-compliance.</p> <p>Note: The Planning Secretary may waive some of these requirements if they are unnecessary or unwarranted for particular management plans</p>					<p><b>e)</b> included throughout the CEMP but particular reference to Section 3.3 Construction Sequencing, Section 4.2 Objectives and Targets of the CEMP and Section 6.2 Stakeholder Management.</p> <p><b>f)</b> reference to Section 5.0 Inspection, Monitoring, Auditing &amp; Reporting.</p> <p><b>g-i)</b> reference to Section 6.3 Communications &amp; Engagement Protocols.</p> <p><b>g-ii)</b> reference to Section 2.5 Site Contacts / Contact Numbers and Section 6.3 Communications &amp; Engagement Protocols.</p> <p><b>g-iii)</b> included throughout the CEMP but particular reference to Section 4.2 Objectives and Targets of the CEMP, Section 5.4 Compliance Reporting and Section 7.1 CNVMSP Overview</p> <p><b>h)</b> reference to Section 6.2 Stakeholder Management and Section 6.3 Communication &amp; Management Protocols</p>	
<b>Construction Environmental Management Plan</b>							
B11	<p>Prior to the commencement of construction, the Applicant must submit a Construction Environmental Management Plan (CEMP) to the Certifier and provide a copy to the Planning Secretary. The CEMP must include, but not be limited to, the following:</p> <p>(a) Details of:          (i) hours of work;          (ii) 24-hour contact details of site manager;          (iii) management of dust and odour to protect the amenity of the neighbourhood;          (iv) stormwater control and discharge;          (v) measures to ensure that sediment and other materials are not tracked onto the roadway by vehicles leaving the site;          (vi) groundwater management plan including measures</p>	Prior to Construction CC1 - March 2020	copy to Planning Secretary	Contractor	<p>Copy of records / certificates of Compliance.</p> <p>Record Keeping for communications with the certifier.</p>	<p>CEMP document detailing B11 requirements.</p> <p>File name: CEMP_IASB_030320          Document Title: Randwick Campus Redevelopment: Construction Environmental Management Plan          Prepared by: Lendlease          Dated -Feb 2020          Rev 2 – for CC1</p> <p><b>Submitted to PCA</b>          Via aconex corro.          Ref: LL-GCOR-015861          Sent:10 March 20  <b>Approval from PSA</b>          Via Crown Certificate</p>	Compliant

**Randwick Campus Redevelopment**

	<p>to prevent groundwater contamination;                  (vii) external temporary lighting in compliance with AS 4282-2019 Control of the obtrusive effects of outdoor lighting;                  (viii) community consultation and complaints handling;                  (b) Construction Noise and Vibration Management Sub-Plan (see condition B12);                  (c) Construction Waste Management Sub-Plan (see condition B13);                  (d) Construction Soil and Water Management Sub-Plan (see condition B14);                  (e) an unexpected finds protocol for contamination and associated communications procedure;                  (f) an unexpected finds protocol for Aboriginal and non-Aboriginal heritage and associated communications procedure;                  (g) waste classification (for materials to be removed) and validation (for materials to remain) be undertaken to confirm the contamination status in these areas of the site; and</p>					<p>No 19/124846-5                  Issued: 18 Mar 20</p> <p><b>Submitted to PCA for CC2</b>                  Via aconex corro.                  Ref: LL-GCOR-023873                  Sent:27-8-20</p> <p><b>Approval from PCA</b>                  Via Crown Certificate                  No 20/124846-7                  Issued: 28-9-2020</p> <p>See Management Plan Tracking Matrix                  Filenamed; SSD10339 Management Plans Register                  Nov 20 Rev 1.2                  Dated :November 2020                  Issued as evidence in IA#2 on 3/12/20 by ACONEX LL-GCOR-029247</p> <p>Part (a) items:  <b>Addresses (i): Hours of Work</b>                  Refer section 2.2</p> <p><b>Addresses (ii) :24 hr contact</b>                  Refer section 2.5</p> <p><b>Addresses (iii): dust and odour</b>                  Refer to CEMP section 10.0 Management of Air Quality Sub Plan – refer to appendix 5                  Appendix 5: Air Quality Management Sub Plan prepared by Lendlease                  latest revision as per the Management Plans register referenced above.</p> <p><b>Addresses (vi): stormwater control &amp; discharge</b>                  Refer to CEMP section 9.0 Construction Soil and Water Management Sub Plan –refer to appendix 4.                  Appendix 4: Stormwater &amp; Erosion Management Plan prepared by Lendlease. latest revision as per the Management Plans register referenced above.</p> <p><b>Addresses (v): tracking of sediment</b></p>	
--	---	--	--	--	--	---	--



					<p>Refer to CEMP section 9.0– Stormwater and Erosion Management Subplan refer to appendix 4  Appendix 4: RCR Integrated Stormwater and Erosion Management Plan  Prepared by Lendlease  Date: latest revision as per the Management Plans register referenced above.</p> <p><b>Addresses (vi): ground water management plan</b>  Refer CEMP section 11.0 Ground water Management Plan – refer to appendix 6  Appendix 6: Ground Water Management Plan prepared by Douglas Partners  Date: latest revision as per the Management Plans register referenced above.</p> <p>CC2 Issue:  File name: <i>72505.13.R.036.Rev1.GMP Hospital Rd</i>  Document Title: <b>Ground water Management Plan for Lowering of Hospital Road</b>  Prepared by Douglas Partners  Rev 2 – 4<sup>th</sup> March 2020  For Groundwater Management Plan (GMP) refer to - CEMP (DA Condition B11) - Appendix 6: Groundwater Management Plan</p> <p><b>Addresses (vii): Ext temp lighting</b>  Refer to CEMP Section 13.0</p> <p><b>Addresses (viii): Community Consultation &amp; complaints</b>  Refer to CEMP section 6.0</p> <p>Addresses Part (b): <b>Construction Noise &amp; Vibration Management Plan Sub Plan (CNVPSP)</b>  Refer to CEMP section 7.0 – refer to appendix 2.  Appendix 2: CNVMSP  Prepared by Acoustic Logic  Date: 09/03/20 - Rev 7  Addresses Part (c): <b>Construction Waste Management Subplan (CWMSp)</b>  Refer to CEMP section 8 – refer to appendix 3.</p>
--	--	--	--	--	---

					<p>Appendix 3: CWMSPP prepared by Lendlease date; latest revision as per the Management Plans register referenced above.</p> <p>Addresses Part (d): <b>Construction Soil &amp; Water Management Subplan (CSWMSPP)</b> Refer to CEMP section 9 – refer to appendix 4. Appendix 4: RCR Integrated Stormwater and Erosion Management Plan Prepared by Lendlease Date latest revision as per the Management Plans register referenced above.</p> <p>Addresses Part (e): <b>unexpected finds protocol for contamination</b> Refer to CEMP section 12.0 refer to appendix 7 &amp; 8 for Remediation Action Plan (RAP).</p> <p>appendix 7: Remedial Action Plan Stage 1 &amp; IASB Addition prepared by Douglas Partners – Date: Sept 2019 - rev 9</p> <p>appendix 8: Site Audit Statement prepared by Senversa Pty Ltd. Statement no. JC-NSW26b Date 20 Sept 2019</p> <p>Addresses Part (f): <b>unexpected finds protocol for heritage.</b> Refer to CEMP section 12.2 &amp; aboriginal Cultural Heritage assessment Report dated Oct 2018 by MDCA and subsequent appendix c</p> <p><b>Heritage and Archaeological Management Plan</b> Prepared by Lendlease Date latest revision as per the Management Plans register referenced above.</p>
--	--	--	--	--	--

Randwick Campus Redevelopment

						<p>Addresses Part (g): <b>waste classification</b>  Refer to CEMP section 12.3  refer to appendix 7 – Remedial Action Plan.  appendix 7: Remedial Action Plan Stage 1 &amp; IASB  Addition  prepared by Douglas Partners – Date: Sept 2019 - rev 9</p> <p>DPIE acknowledgment of submission email titled: Prince of Wales Hospital - Addition to approved Acute Services Building - Post Approval Document Received - (SSD-10339-PA-5)</p>	
B12	<p>The Construction Noise and Vibration Management Sub-Plan must address, but not be limited to, the following:  (a) be prepared by a suitably qualified and experienced noise expert;  (b) describe procedures for achieving the noise management levels in EPA's Interim Construction Noise Guideline (DECC, 2009);  (c) describe the measures to be implemented to manage high noise generating works such as piling, in close proximity to sensitive receivers;  (d) include strategies that have been developed with the community for managing high noise generating works;  (e) describe the community consultation undertaken to develop the strategies in condition B12(d);  (f) include a complaints management system that would be implemented for the duration of the construction;  (g) mitigation measures to minimise impacts of works undertaken outside standard hours  (h) adherence to the recommendations of the report titled Noise and Vibration Impact Assessment Issue 5 dated 5 August 2019 and prepared by Acoustic Studio, as modified by the conditions of this consent.</p>	Prior to Construction	Contractor Acoustic Consultant	Construction Noise & Vibration Management Sub Plan included in the Construction Environmental Management Plan	<p>CNVMSP documents B12 requirements.</p> <p>See Management Plan Tracking Matrix  Management Plans revised and updated from time to time: latest revision as per the Management Plans register referenced above.</p> <p>Previous issue for examples:  File named; SSD10339 Management Plans Register  Nov 20 Rev 1.2  Dated :November 2020  Issued as evidence in IA#2 on 3/12/20 by ACONEX LL-GCOR-029247</p> <p>File name: 20200309GWA_R7  Construction_Noise_and_Vibration_Managemnt_Sub_Plan  Document Title; Prince of Wales Hospital – Lowering of Hospital Road –(CNVMP)  Prepared by: Acoustic Logic  Dated – 9 Mar 2020  Rev 7 – for CC1</p> <p><b>Submitted to PCA</b>  Via aconex corro.  Ref: LL-GCOR-015861  Sent:10 March 20</p> <p><b>Approval from PSA</b>  Via Crown Certificate</p>	Compliant	

Randwick Campus Redevelopment

						<p>No 19/124846-5 Issued: 18 Mar 20</p> <p>a) Acoustic Logic – are specialist acoustic engineers suitably to produce appropriate noise and vibration reports and monitoring. b) Refer to Section 7.1 c) Refer to Section 7 - tables 2,3 &amp; 4 d) Refer to Section 9.6 e) Refer to section 14.2 f) Refer to section 14.3 g) Refer to section 14.1 h) refer to section 1.2 – Item 2 – acknowledgment of Acoustic Studio report &amp; section 5 – background Noise Levels.</p> <p>DPIE acknowledgment of submission email titled: Prince of Wales Hospital - Addition to approved Acute Services Building - Post Approval Document Received - (SSD-10339-PA-5)</p>	
--	--	--	--	--	--	---	--

Randwick Campus Redevelopment

<p><b>B13</b></p>	<p>The Construction Waste Management Sub-Plan must address, but not be limited to, the following:          (a) detail the quantities of each waste type generated during construction and the proposed reuse, recycling and disposal locations; and          (b) removal of hazardous materials, particularly the method of containment and control of emission of fibres to the air, and disposal at an approved waste disposal facility in accordance with the requirements of the relevant legislation, codes, standards and guidelines, prior to the commencement of any building works.</p>	<p>Prior to construction</p>		<p>Contractor</p>	<p>Construction Waste Management Sub Plan to be included in the Construction Environmental Management Plan</p>	<p>CWMP documents B13 requirements.</p> <p>File name: Management Plan – CWMSP_200120          Document Title; Randwick Campus Redevelopment Integrated ASB (IASB) Addition – Management Sub Plan Waste          Prepared by: Lendlease          Dated – 20/01/2020          Rev 2.8</p> <p><b>Submitted to PCA</b>          Via aconex corro.          Ref: LL-GCOR-014620          Sent:4 Feb 20</p> <p><b>Approval from PSA</b>          Via Crown Certificate          No 19/124846-5          Issued: 18 Mar 20</p> <p>See Management Plan Tracking Matrix          Management Plans revised and updated from time to time: latest revision as per the Management Plans register referenced above.          Previous Examples:          Filenamed; SSD10339 Management Plans Register          Nov 20 Rev 1.2          Dated :November 2020          Issued as evidence in IA#2 on 3/12/20 by ACONEX LL-GCOR-029247</p> <p>a) Refer to appendix 1 – Key Waste Streams          b) Refer to section 2 – Implementation of the Sub Plan</p> <p>DPIE acknowledgment of submission email titled: Prince of Wales Hospital - Addition to approved Acute Services Building - Post Approval Document Received - (SSD-10339-PA-5)</p>	<p>Compliant</p>
-------------------	--	------------------------------	--	-------------------	--	---	------------------

Randwick Campus Redevelopment

<p><b>B14</b></p>	<p>The Construction Soil and Water Management Sub-Plan must address, but not be limited to the following:          (a) be prepared by a suitably qualified expert, in consultation with Council;          (b) describe all erosion and sediment controls to be implemented during construction;          (c) provide a plan of how all construction works will be managed in a wet-weather events (i.e. storage of equipment, stabilisation of the Site);          (d) detail all off-Site flows from the Site; and          (e) describe the measures that must be implemented to manage stormwater and flood flows for small and large sized events, including, but not limited to 1 in 1-year ARI, 1 in 5-year ARI and 1 in 100-year ARI.</p>	<p>Prior to construction</p>		<p>Contractor</p>	<p>Construction Soil and Water Management Sub Plan to be included in the Construction Environmental Management Plan</p> <p>Record of communications with Council.</p>	<p>CSWMSP documents B14 requirements</p> <p>File name: Management Plan – Stormwater and Erosion IASB          Document Title; <b>Randwick Campus Redevelopment Integrated ASB (IASB) – Management Plan – Stormwater and Erosion</b>          Prepared by: Lendlease          Dated – 17/01/2020          Rev 2.6</p> <p><b>Submitted to PCA</b>          Via aconex corro.          Ref: LL-GCOR-014620          Sent:4 Feb 20  <b>Approval from PSA</b>          Via Crown Certificate          No 19/124846-5          Issued: 18 Mar 20</p> <p>See Management Plan Tracking Matrix          Filenamed; SSD10339 Management Plans Register          Nov 20 Rev 1.2          Dated :November 2020          Issued as evidence in IA#2 on 3/12/20 by ACONEX LL-GCOR-029247          Management Plans revised and updated from time to time: latest revision as per the Management Plans register referenced above.          a) Prepared by Lendlease Building who have the suitable and relevant experience.          b) Refer to Section 2 Implementation - site controls and also in the <b>Soil &amp; Erosion Management Plan</b> and the <b>Early &amp; Enabling Works Acor drawing</b> – RCR-ACR-CV-01-DWG-DD-101 rev 4.          c) Refer to Section 2 – Implementation of the Sub Plan &amp; as detailed on Acor Drawing RCR-ACR-CV-01-DWG-DD-101 rev 4.          d &amp; e) Refer to Douglas Partners - <b>Ground Water Management Plan</b> – section 5: expected flow rates and controls for “heavy rain events”.</p>	<p>Compliant</p>
-------------------	--	------------------------------	--	-------------------	---	--	------------------

Randwick Campus Redevelopment

						DPIE acknowledgment of submission email titled: Prince of Wales Hospital - Addition to approved Acute Services Building - Post Approval Document Received - (SSD-10339-PA-5)	
--	--	--	--	--	--	--	--

Randwick Campus Redevelopment

Construction Traffic and Pedestrian Management Plan							
B15	<p>A Construction Traffic and Pedestrian Management Plan (CTPMP) must be prepared to achieve the objective of ensuring safety and efficiency of the road network and address, but not be limited to, the following:</p> <p>(a) be prepared by a suitably qualified and experienced person(s);</p> <p>(b) be prepared in consultation with the TfNSW, including its Sydney Coordination Office, Sydney Light Rail Operator team, TfNSW (RMS), and Council;</p> <p>(c) detail the measures that are to be implemented to ensure road safety and network efficiency during construction in consideration of potential impacts on the CBD and South East Light Rail project and general traffic, cyclists and pedestrians and bus services;</p> <p>(d) location all proposed work zones;</p> <p>(e) proposed construction hours;</p> <p>(f) estimated number and type of construction vehicle movements including volume, time of day, vehicle routes, access and parking arrangements. All construction vehicles are to enter and exit site in a forward direction. No reversing into site should be allowed for pedestrian safety reasons. Construction vehicle movements should be limited during peak periods, AM (7am-9.30am) and PM (4pm-6.30pm) to reduce impacts on any bus operations and traffic flow.</p> <p>(g) construction program including details of peak construction activities and proposed construction staging;</p> <p>(h) measures to reduce the likelihood of construction workers driving to the Randwick Hospital Campus site to park, placing further demand on kerbside parking and the road network during construction.</p> <p>(i) include a Driver Code of Conduct to:</p> <p>(i) minimise the impacts of earthworks and construction on the local and regional road network;</p> <p>(ii) minimise conflicts with other road users;</p> <p>(iii) minimise road traffic noise; and</p> <p>(iv) ensure truck drivers use specified routes;</p> <p>(j) include a program to monitor the effectiveness of these measures; and</p> <p>(k) if necessary, detail procedures for notifying residents</p>	Prior to construction		Contractor	<p>Construction Traffic &amp; Ped Management Plan Prepared in accordance with condition requirements.</p> <p>Record of communications with Council &amp; TfNSW.</p>	<p>CTPMP documents B15 requirements</p> <p>File name: CTPMP_IASB_Dec 2020_ Rev3 Document Title; Randwick Campus Redevelopment Construction Traffic &amp; Pedestrian Management Plan Prepared by: Lendlease Dated – Feb 2020 Rev 3.0 (includes TfNSW comments)</p> <p>See Management Plan Tracking Matrix Management Plans revised and updated from time to time: latest revision as per the Management Plans register referenced above.</p> <p>Previous example: File named; SSD10339 Management Plans Register Nov 20 Rev 1.2 Dated :November 2020 Issued as evidence in IA#2 on 3/12/20 by ACONEX LL-GCOR-029247</p> <p>a) Prepared by Lendlease Building who have the suitable and relevant experience with impute from Arup Traffic.</p> <p>b) Lendlease (Construction Manager) issued CPTMP &amp; CWTS to TfNSW (CBD Freight Policy &amp; Planning Manager) on 19<sup>th</sup> Dec 2019 for review</p> <p>Email response received from TfNSW (CBD Freight Policy &amp; Planning Manager) supporting endorsement of CPTMP &amp; CWTS with inclusion of comments dated 19/02/20.</p> <p>c) refer to Section 4.2 &amp; 4.5 d) refer to section 4.8, 4.10 &amp; read in conjunction with Appendix 8 e) refer to Section 2.2 for Hours of Work f) refer to sections 4.2, 4.5 &amp; 4.7 g) refer to section 3.0 - Construction Programme &amp; Staging</p>	Compliant



Randwick Campus Redevelopment

	and the community (including local schools), of any potential disruptions to routes.					<p>h) refer to section 4.9 – Existing Parking Provisions &amp; section 6.0 Construction Worker Transportation Strategy (CWTS)</p> <p>File name: Construction Worker Transportation Strategy – Feb 20 – Rev3 Document Title; Randwick Campus Redevelopment Construction Worker Transportation Strategy – Integrated ASB Addition Prepared by: Lendlease Dated – Feb 2020 Rev 3.0 (includes TfNSW comments) <b>Submitted to PCA</b> Via aconex corro. Ref: LL-GCOR-015302 Sent:24 Feb 20 <b>Approval from PSA</b> Via Crown Certificate No 19/124846-5 Issued: 18 Mar 20</p> <p>i) Refer to section 5.0 Driver Code of Conduct j) refer to section 4.11 &amp; 7.1 k) Refer to section 7.0 - Stakeholder Management</p> <p>DPIE acknowledgment of submission email titled: Prince of Wales Hospital - Addition to approved Acute Services Building - Post Approval Document Received - (SSD-10339-PA-4) – date 16 March 2020</p>	
B16	A copy of the final CTPMP is to be submitted to the Coordinator General, Transport Coordination at TfNSW for endorsement prior to the commencement of any work.	Prior to construction		Contractor	Record of CTPMP submission to TfNSW	<p>Lendlease (Construction Manager) issued CPTMP &amp; CWTS to TfNSW (CBD Freight Policy &amp; Planning Manager) on 19<sup>th</sup> Dec 2019 for review</p> <p>Email response received from TfNSW (CBD Freight Policy &amp; Planning Manager) supporting endorsement of CPTMP &amp; CWTS with inclusion of comments dated 19/02/20. Email to response dated 24/02/20 to TfNSW (attn: CBD Freight Policy &amp; Planning Manager) responding to questions raised and including the updated CWTS &amp; CTPMP</p>	Compliant

Randwick Campus Redevelopment

						<p>Titled - <i>FW: Endorsement; SSD-10339 IASB Addition CTPMP and CWTS approval (Feb 2019)</i>            Author – Richard Yarad Lendlease</p> <p>DPIE acknowledgment of submission email titled: Prince of Wales Hospital - Addition to approved Acute Services Building - Post Approval Document Received - (SSD-10339-PA-4) – date 16 March 2020</p> <p>Updated CTPMP_IASB_June20_r5 issued by email to pwc &amp; TfNSW on 18/6/20 by Richard Yarad &amp; updated 3/7/20 titled “RCR-IASB-TfNSW Construction Staging Meeting”</p> <p>Updated CPTMP endorsed June 20 for r5 Email response received 14-7-20 “Endorsement 14 July 2020 – IASB – TfNSW Construction Staging” (See also B15)</p>	
<b>Construction Worker Transportation Strategy</b>							
<b>B17</b>	<p>Prior to the commencement of construction, the Applicant must submit a Construction Worker Transportation Strategy in consultation with the Sydney Coordination Office within Transport for New South Wales to the satisfaction of the Certifier. The Strategy must detail the provision of sufficient parking facilities or other travel arrangements for construction workers in order to minimise demand for parking in nearby public and residential streets or public parking facilities.</p>	Prior to construction		Contractor	<p>Record of consultation with TfNSW &amp; Certifier.</p>	<p>File name: Construction Worker Transportation Strategy – Feb 20 – Rev3            Document Title; Randwick Campus Redevelopment Construction Worker Transportation Strategy – Integrated ASB Addition            Prepared by: Lendlease            Dated – Feb 2020            Rev 3.0 (includes TfNSW comments)</p> <p><b>Submitted to PCA</b>            Via aconex corro.            Ref: LL-GCOR-015302            Sent:24 Feb 20</p> <p><b>Approval from PSA</b>            Via Crown Certificate            No 19/124846-5            Issued: 18 Mar 20</p> <p>Email to response dated 24/02/20 to TfNSW (Attn: CBD Freight Policy &amp; Planning Manager) responding to questions raised and including the updated CWTS &amp; CTPMP</p>	Compliant

Randwick Campus Redevelopment

						<p>Titled - <i>FW: Endorsement; SSD-10339 IASB Addition CTPMP and CWTS approval (Feb 2019)</i>                  Author – Richard Yarad Lendlease</p> <p>DPIE acknowledgment of submission email titled: Prince of Wales Hospital - Addition to approved Acute Services Building - Post Approval Document Received - (SSD-10339-PA-4) – date 16 March 2020</p>	
<b>Soil and Water</b>							
<b>B18</b>	<p>Prior to the commencement of construction, the Applicant must:                  (a) install erosion and sediment controls on the site to manage wet weather events; and                  (b) divert existing clean surface water around operational areas of the site.</p>	Prior to construction		Contractor	<p>Copy of records / certificates of Compliance.</p>	<p>File name: Management Plan – Stormwater and Erosion IASB                  Document Title; Randwick Campus Redevelopment Integrated ASB (IASB) – Management Plan – Stormwater and Erosion                  Prepared by: Lendlease                  Dated – 17/01/2020                  Rev 2.6</p> <p>See Management Plan Tracking Matrix                  Filenamed; SSD10339 Management Plans Register Nov 20 Rev 1.2                  Dated :November 2020                  Issued as evidence in IA#2 on 3/12/20 by ACONEX LL-GCOR-029247                  Management Plans revised and updated from time to time: latest revision as per the Management Plans register referenced above.</p> <p>a &amp; b) Appendix 2 – of Stormwater and Erosion Plan – refer Soil and Erosion Drawing prepared by Acor – RCR-ACR-CV-00-DWG-00-401 rev etc</p>	Compliant
<b>B19</b>	<p>Prior to the commencement of construction, erosion and sediment controls must be installed and maintained, as a minimum, in accordance with the publication Managing Urban Stormwater: Soils &amp; Construction (4th edition, Landcom 2004) commonly referred to as the 'Blue Book'.</p>	Prior to construction		Contractor	<p>Copy of records / certificates of Compliance.</p>	<p>File name: Management Plan – Stormwater and Erosion IASB                  Document Title; Randwick Campus Redevelopment Integrated ASB (IASB) – Management Plan – Stormwater and Erosion                  Prepared by: Lendlease                  Dated – 17/01/2020                  Rev 2.6</p> <p>See Management Plan Tracking Matrix</p>	Compliant

Randwick Campus Redevelopment

						<p>Management Plans revised and updated from time to time: latest revision as per the Management Plans register referenced above.                  Previous example:                  Filenamed; SSD10339 Management Plans Register                  Nov 20 Rev 1.2                  Dated :November 2020                  Issued as evidence in IA#2 on 3/12/20 by ACONEX LL-GCOR-029247</p> <p>Refer to Legislation and Guidelines section in the Stormwater and Erosion Management Plan for acknowledgment of practices as per the 'Managing Urban Stormwater: Soils &amp; Construction (4th edition, Landcom 2004)' commonly referred to as the 'Blue Book'.</p>	
<b>Stormwater Management System</b>							
<b>B20</b>	<p>Prior to the commencement of construction above ground, the Applicant must design an operational stormwater management system for the development and submit it to the satisfaction of the Certifier. The system must:</p> <p>(a) be designed by a suitably qualified and experienced person(s);                  (b) be generally in accordance with the conceptual design in the EIS;                  (c) be in accordance with applicable Australian Standards; and                  (d) ensure that the system capacity has been designed in accordance with Australian Rainfall and Runoff (Engineers Australia, 2016) and Managing Urban Stormwater: Council Handbook (EPA, 1997) guidelines.</p>	<p>Prior to commencement of above ground construction</p>		<p>Contractor</p>	<p>Copy of records / certificate of compliance from Certifier.</p>	<p><b>a)</b> Stormwater Management System design by Acor Consultants who are suitably qualified to undertake design works.                  Refer to Civil Design Certification – R02                  Dated 26/07/2020                  Author: Acor Consultants – Nathan Pearce  <b>b)</b> the stormwater management system is generally in accordance with the conceptual design in the EIS.  <b>c)</b> Australian Design Standards listed in the Civil Design Certificate.  <b>d)</b> confirmed in the Civil Design Certificate – refer 'Reference Material'</p> <p><b>CC1 Design Submitted to PCA</b>                  Civil Design Certification                  Refer to: Civil-RCR-HRL-CC1 Design Certificate _R2_200226                  Via aconex corro.                  Ref: LL-GCOR-015444                  Sent:27 Feb 20  <b>Approval from PSA</b>                  Via Crown Certificate                  No 19/124846-5                  Issued: 18 Mar 20</p>	<p>Compliant</p>

Randwick Campus Redevelopment

						<p><b>CC2 Design Submitted to PCA</b>          Civil Design Certification          Filename: "SY180053_Civil RCR HRL CC2 Design Certificate_R2_200720.docX"          Via Aconex Corro          Ref: LL-GCOR-023873          Sent:27-8-20</p> <p><b>Approval from PCA</b>          Via Crown Certificate          No 20/124846-7          Issued: 28-9-2020</p>	
<b>Operational Noise – Design of Mechanical Plant and Equipment</b>							
<b>B21</b>	Prior to installation of mechanical plant and equipment, the Applicant must incorporate the noise mitigation recommendations in the Noise and Vibration Impact Assessment Issue 5 dated 5 August 2019 and prepared by Acoustic Studio, into the detailed design drawings. The Certifier must verify that all noise mitigation measures have been incorporated into the design to ensure the development will not exceed the recommended operational noise levels identified in the Noise and Vibration Impact Assessment Issue 5 dated 5 August 2019 and prepared by Acoustic Studio.	Prior to the installation of mech plant		Contractor	<p>Copy of records / certificate of compliance from Certifier.</p> <p>Lendlease recognises this requirement and will ensure that it is complied with through the duration of the project.</p>	Applicant (LL) to provide Certifier with confirmation that all noise mitigation as per Acoustic Studio Report have been incorporated.	Not triggered
<b>B22</b>	Mechanical plant and equipment must be selected, installed and operated both individually and cumulatively within SSD 10339, so that the operational noise levels from the entire Acute Services Building (SSD 9113 and SSD 10339) do not exceed the Project Noise Trigger levels identified in Table 4 of Section 5.2.1.1.1 of the noise impact assessment.	note		Contractor	note	Lendlease recognises this requirement and will ensure that it is complied with through the duration of the project.	Not triggered

Randwick Campus Redevelopment

Landscaping							
B23	<p>Prior to the commencement of construction of landscape works, the Applicant must prepare a detailed Landscape Plan to manage the landscaping works on-site, to the satisfaction of the Certifier, and submit a copy to the Planning Secretary. The plan must:</p> <p>(a) detail the location, species, maturity and height at maturity of plants to be planted on-site;</p> <p>(b) include species (trees, shrubs and groundcovers) indigenous to the local area using a mix of species from the plant families that are found in naturally occurring examples of the vegetation community that is most likely to have occurred on the site and compensate for any loss of foraging habitat for the Grey-headed Flying fox;</p> <p>(c) include species (trees, shrubs and groundcovers) indigenous to the local area; and</p> <p>(d) incorporate the details and recommendations outlined in the SSDA Landscape Design Report - Updated 17 October 2019 prepared by Aspect Studios.</p>	Prior to commencement of landscaping works	Copy to Planning Secretary	Contractor	Copy of records / certificate of compliance from Certifier.	Noted – will be submitted as part of the future CC submission	Not triggered
Construction and Demolition Waste Management							
B24	<p>Prior to the commencement of the removal of any waste material from the site, the Applicant must notify the TfNSW (RMS) Traffic Management Centre of the truck route(s) to be followed by trucks transporting waste material from the site.</p>	Prior to commencement of removal of waste material		Contractor	Record of TfNSW notification	<p>Email letter sent from Lendlease Construction Manager to TfNSW (CBD Freight Policy &amp; Planning Manager) on 30 Jan 2020 which included the Construction Waste Management Plan which provided notification of waste disposal facilities and planned road routes.</p> <p>Confirming no change to date of these haulage routes.</p>	Compliant
Operational Waste Storage and Processing							
B25	<p>Prior to the commencement of construction above ground, the Applicant must obtain agreement from Council for the design of the operational waste storage area (where waste removal will be undertaken by Council). Where waste removal will be undertaken by a third party, the design of the operational waste storage area must be in accordance with Council's standards and evidence must be provided to the Certifier.</p>	Prior to commencement of above ground construction		Contractor support from LHD/UNSW	Record of agreement from Council or record of compliance to council standards and submission to Certifier	Noted – will be submitted as part of a future CC submission	Not triggered

Randwick Campus Redevelopment

Crime Prevention Through Environmental Design (CPTED)							
B26	Prior to the commencement of construction above ground, details must be submitted to the satisfaction of the Certifier that the Crime Prevention Through Environmental Design principles established in the Architectural Design Statement report, prepared by BVN Terroir Revision 10, dated 23 October 2019, have been incorporated into the design to minimise crime risk and ensure the design is generally consistent with the principles in the CPTED principles.	Prior to commencement of above ground structures - CC3		Contractor	Copy of records / certificate of compliance from Certifier.	Noted – CC submission relating to landscaping	Not triggered
Compliance Reporting							
B27	No later than 48 hours prior to the commencement of construction, a Compliance Monitoring and Reporting Schedule prepared in accordance with section 2.1 of the Compliance Reporting Post Approval Requirements (Department 2018, or as amended), as amended by condition B28 must be submitted to the Planning Secretary and the Certifier.	no later than 48 hours prior to construction start	submit to Planning Secretary	Applicant /Contractor	Compliance Monitoring and Reporting Program Record Keeping System for communications with the Certifying Authority	<p>Refer to Randwick Campus Redevelopment – Prince of Wales – UNSW Addition &amp; Lowering Hospital Road. Preconstruction Compliance Report.</p> <p>Refer to section 2.0 for Compliance Reporting – table 4.</p> <p><b>Submitted to PCA</b> Refer to: 200311 – SSSA 10339 – CC1 - Preconstruction Compliance Report – Rev3 Via aconex corro. Ref: LL-GCOR-0161125 Sent: 11 Mar 20</p> <p><b>Approval from PCA</b> Via Crown Certificate No 19/124846-5 Issued: 18 Mar 20</p> <p>Submission acknowledge by DPIE email dated 16 March 2020 – titled: Prince of Wales Hospital - Addition to approved Acute Services Building - Post Approval Document Received - (SSD-10339-PA-6)</p> <p>Resubmitted to DPIE Rev#4 (May 20): Confirmation received on 2 June 2020 - Post Approval Document Received SSD10339-PA-9</p>	Compliant

Randwick Campus Redevelopment

<p><b>B28</b></p>	<p>Table 1 of the Compliance Reporting Post Approval Requirements (Department 2018, or as amended) is amended so that the Compliance Monitoring and Reporting Schedule, minimum frequency of Compliance Reports required is:                  (a) a Pre-Construction Compliance Report must be submitted to the Planning Secretary prior to commencement of construction;                  (b) a Pre-Operational Compliance Report must be submitted to the Planning Secretary prior to commencement of operation and/or use; and                  (c) Operation Compliance Reports are required for the duration of operation and must be submitted to the Planning Secretary at intervals, no greater than 52 weeks from the commencement of operation or as otherwise by the Planning Secretary.</p>	<p>a - Pre-construction Compliance Report                  b- Pre-operational Compliance Report                  c- Operation Compliance report</p>	<p>submit to Planning Secretary</p>	<p>Contractor to issue to HI</p>	<p>Record Keeping System for submission to Planning Secretary</p>	<p>Pre-Construction Compliance Report submitted to the Planning Secretary prior to commencement of CC1 construction works</p> <p>a) Pre-Construction Compliance Report lodged with DPIE 16/03/20 details as follows;                  Document Name: Preconstruction Compliance Report                  Description of Document                  Pre-Construction Compliance Report as per condition B27</p> <p>Email correspondence received from DPIE – Senior Compliance Officer – PreCompliance Report did not meet the Conditions of B29. – date 1<sup>st</sup> May 20202.</p> <p>SSDA 10339 PreCompliance Report – Rev 4 (dated :15/05/20) updated in accordance with Compliance Reporting Post Approval Requirements (Department 2018, or as amended), Issued to Planning Department via PWC</p> <p>b) refer to Section 2.0 – Table 4 Compliance Reporting Program                  c) refer to Section 2.0 – Table 4 Compliance Reporting Program</p>	<p>Compliant</p>
<p><b>B29</b></p>	<p>Compliance Reports of the development must be prepared in accordance with the Compliance Reporting Post Approval Requirements (Department 2018, or as amended)</p>	<p>At all times</p>		<p>Contractor to issue to HI</p>	<p>As above</p>	<p>Compliance Report prepared in accordance with the Compliance Reporting Post Approval Requirements (Department 2018, or as amended)</p>	<p>Compliant</p>
<p><b>B30</b></p>	<p>Compliance Reports of the development must be submitted to the Planning Secretary in accordance with timing outlined in the Compliance Monitoring and Reporting Schedule.</p>	<p>As stated in Compliance and Monitoring Report</p>	<p>submit to Planning Secretary</p>	<p>Contractor to issue to HI</p>	<p>Record Keeping System for submission to Planning Secretary</p>	<p>Refer to SSDA 10339 Pre Compliance Report: Section 2.0 – Table 4 Compliance Reporting Program Schedule. To be read in conjunction with B28</p> <p>Non Compliance: Compliance Report 1 is issued late.</p> <p>Non Compliance: Compliance Report 2 is issued later than scheduled. Ref Email PWC filename: Re__EXT__Re_RCR - SSD10339 - Construction Compliance Report #2 confirming HI acceptance of a small extension for compassionate reasons.</p>	<p>Non Compliant</p>



Randwick Campus Redevelopment

B31	The Applicant must make each Compliance Report publicly available 60 days after submitting it to the Planning Secretary.	60 days after submission to Planning Secretary		Contractor to issue to HI	Record of submission to Planning Secretary	<p>Compliance Reports issued to Health Infrastructure on the 19 March 2020: for uploading to project website</p> <p><a href="http://randwickcampusredevelopment.health.nsw.gov.au/projects/integrated-acute-services-building-addition/ssd-10339-documentation">http://randwickcampusredevelopment.health.nsw.gov.au/projects/integrated-acute-services-building-addition/ssd-10339-documentation</a></p> <p>Via aconex corro. PWC to HI. Ref: PWCAU-GCOR-006704 Sent:19 March 20</p> <p>Compliance Report #1 issued to PWC via ACONEX LL-GCOR-029663 dated 11/12/20 Filename' SSDA 10339 - CC1 -Construction Compliance Report Rev 1'</p> <p>Non Compliance: CCR#1 has not been uploaded to the website.</p>	Non - Compliant
B32	Notwithstanding the requirements of the Compliance Reporting Post Approval Requirements (Department 2018, or as amended), the Planning Secretary may approve a request for ongoing annual operation Compliance Reports to be ceased, where it has been demonstrated to the Planning Secretary's satisfaction that consistent operational compliance has been achieved.	Note		Note	Note	Planning Secretary may approve request for ongoing annual operation Compliance Reports to be ceased.	Not triggered
<b>Remediation</b>							
B33	Prior to commencement of remediation works, the Applicant must prepare an updated Remediation Action Plan to include an asbestos management plan, unexpected finds protocol and soil management strategy in accordance with the recommendations in the Contamination Report prepared by Douglas Partners dated 20 August 2019 to the satisfaction of the Certifier.	Prior to commencement of remediation works		Contractor	Record of submission to satisfaction of Certifier.	<p>Refer to CEMP section 12.0 refer to appendix 7 for Remediation Action Plan (RAP). appendix 7: Remedial Action Plan Stage 1 &amp; IASB Addition prepared by Douglas Partners Date: Sept 2019 - rev 9</p> <p>Refer to section 11 – for Asbestos Management Refer to section 12 – for Unexpected Finds</p> <p><b>Submitted to PCA</b> Via aconex corro. Ref: LL-GCOR-015861 Sent:10 March 20 <b>Approval from PSA</b></p>	Compliant

Randwick Campus Redevelopment

						<p>Via Crown Certificate No 19/124846-5 Issued: 18 Mar 20</p> <p><b>Refer to Spoil Management Plan for - soil management strategy.</b></p> <p>File name: 72505.15.R.005.Rev0.SMP Document Title; Report on Spoil Management Plan Prepared by Douglas Partners Rev 0 – 31 Feb 2019</p> <p>DPIE acknowledgment of submission email titled: Prince of Wales Hospital - Addition to approved Acute Services Building - Post Approval Document Received - (SSD-10339-PA-5)</p>	
<b>Contamination</b>							
<b>B34</b>	<p>Prior to commencement of construction, the Applicant must prepare a Contamination Management Protocol to the satisfaction of a NSW EPA Accredited Site Auditor which identifies how concurrent remediation and construction activities will be managed on site which:</p> <p>(a) includes procedures to differentiate between the handling of contaminated soil/material and construction material to ensure clear separation of handling;</p> <p>(b) includes procedures to differentiate between the handling and transport of contaminated soil and construction materials to and from the site ensure clear separation of handling; and</p> <p>(c) includes a procedure for recording the volume and type of contaminated material leaving the site and its destination.</p>	Prior to Construction		Contractor	<p>Copy of records / certificates of Compliance.</p> <p>Record Keeping for communications with the Certifier &amp; Site Auditor</p> <p>Contamination Report to the satisfaction of the EPA accredited site auditor</p>	<p>Updated Remedial Action Plan as prepared by Douglas Partners – rev 9 - submitted to Certifier as part of the CEMP – refer to B11 CC1 submission</p> <p>File name: S16895_SAS_JC-NSW26b_20September2019 Document Title; <b>IASB Addition, Randwick Campus Redevelopment - Site Audit Statement</b> Prepared by: Senversa Dated – 20 Sept 2020</p> <p>Issued to PCA: Approval letter from Senversa (EPA Accredited Auditor) confirming review of Douglas Partners Groundwater Management Plan (GMP) against the Remedial Action Plan (RAP) and Validation Report - S16895_LET11- 4th March 2020 (003)</p> <p>Issued to PCA: Douglas Partner memo letter confirming amendments made to the GMP in respect of comments from the EPA Site Auditor - 72505.13.R.036 DMP Responses to Auditor Comments (002) - 4th March 2020</p>	Compliant

Randwick Campus Redevelopment

						<p><b>Submitted to PCA</b> Via aconex corro. Ref: LL-GCOR-015697 Sent: 5 March 20</p> <p><b>Approval from PSA</b> Via Crown Certificate No 19/124846-5 Issued: 18 Mar 20</p> <p>With reference to <b>Douglas Partners, Remedial Action Plan:</b></p> <p><b>a)</b> refer to section: 9.4.3, 9.4.4 &amp; 9.4.5 for handling of contaminated soil/material and construction material</p> <p><b>b)</b> refer to section 12: which discusses differentiation between the handling and transport of contaminated soil and construction</p> <p><b>c)</b> refer to section 13.10.2: which outlines the procedure for recording the volume and type of contaminated materials</p>	
--	--	--	--	--	--	--	--

Randwick Campus Redevelopment

Unexpected Contamination Procedure							
B35	<p>Prior to the commencement of earthworks, the Applicant must prepare an unexpected contamination procedure to ensure that potentially contaminated material is appropriately managed. The procedure must form part of the of the CEMP in accordance with condition B11 and must ensure any material identified as contaminated must be disposed off-site, with the disposal location and results of testing submitted to the Planning Secretary, prior to its removal from the site.</p>	Prior to Construction	Submission to Planning Secretary	Contractor	<p>Copy of records / certificates of Compliance. Record Keeping for communications with the certifier &amp; Site Auditor</p>	<p>Refer to CEMP submitted under B11 – section 12 – refer to appendix 3.</p> <p>Submitted: waste classification report with proposed disposal locations.</p> <p>See Management Plan Tracking Matrix                      Filenamed; SSD10339 Management Plans Register                      Nov 20 Rev 1.2                      Dated :November 2020                      Issued as evidence in IA#2 on 3/12/20 by ACONEX LL-GCOR-029247                      Management Plans revised and updated from time to time: latest revision as per the Management Plans register referenced above.</p> <p>Submission acknowledge by DPIE email dated 8 May 2020 – titled: Prince of Wales Hospital - Addition to approved Acute Services Building - Post Approval Document Received - (SSD-10339-PA-8)</p> <p>Non compliance noted: Planning Secretary was not notified in all cases prior to the removal of the material from site</p> <p>CCR#2 UPDATE: No unexpected finds in this period.</p>	Compliant
B36	<p>The EPA is to be notified under section 60 of the Contaminated Land Management Act 1997 for any contamination identified which meets the triggers in the Guidelines for the Duty to Report Contamination.</p>	Notification as triggered under section 60		Contractor	<p>Copy of records / certificates of Compliance. Record Keeping for communications with the Site Auditor &amp; EPA</p>	Notification to EPA	Not triggered

Randwick Campus Redevelopment

<p><b>B37</b></p>	<p>The Applicant is required to engage an EPA-accredited site auditor to review the adequacy of the investigations, unexpected finds protocol, any remedial works or management plan required and confirm that the land can be made suitable for the proposed use. The Applicant must adhere to the management measures accepted by the Auditor.</p>	<p>As required</p>		<p>Contractor</p>	<p>Copy of records / certificates of Compliance/management measures. Appointment of EPA accredited investigator.</p>	<p>Lendlease engaged Senversa Pty – NSW accredited site auditor - author Jason Clay.</p> <p>Site Auditors Statement prepared by Senversa - 20<sup>th</sup> Sept 2019</p> <p>To be read in conjunction with condition B11 - Refer to CEMP: Appendix 8: Contamination / Site Auditor report prepared by Senversa</p> <p>File name: <i>S16895_SAS_JC-NSW26b_20 Septemeber2019</i></p>	<p>Compliant</p>
<p><b>Groundwater</b></p>							
<p><b>B38</b></p>	<p>A report must be obtained from a qualified, experienced hydrogeological engineer, which provides an assessment of the site and the potential impact of groundwater (including seepage flows) and the water table upon the development, and measures to be implemented to effectively manage groundwater where affected. The report is to be submitted to the satisfaction of the Certifier.</p>	<p>Note</p>		<p>Contractor</p>	<p>Record Keeping for communications to satisfaction of the Certifier.</p>	<p>Lendlease engaged Douglas Partners – who specialise in Geotechnical, Environmental and Groundwater engineering - author Peter Valenti</p> <p>File name: <i>72505.13.R.036.Rev1.GMP Hospital Rd</i> Document Title: <b>Ground water Management Plan for Lowering of Hospital Road</b> Prepared by Douglas Partners Rev 1 – 31 Jan 2020 For Groundwater Management Plan (GMP) refer to - CEMP (DA Condition B11) - Appendix 6: Groundwater Management Plan</p> <p><b>Submitted to PCA</b> Via aconex corro. Ref: LL-GCOR-014620 Sent:4 Feb 2020 <b>Approval from PSA</b> Via Crown Certificate No 19/124846-5 Issued: 18 Mar 20</p> <p>----- CC2 &amp; CC3 issue</p> <p>Document Title: <b>Ground water Management Plan for Lowering of Hospital Road</b></p>	<p>Compliant</p>

Randwick Campus Redevelopment

						<p>File name: 26. B38 72595.13.R.036.Rev2.Ground water managemtn plan Hospital Rd Prepared by Douglas Partners Rev 2 – 4<sup>th</sup> March 2020</p> <p><b>Submitted to PCA</b> Civil Design Certification Filename: "SY180053_Civil RCR HRL CC2 Design Certificate_R2_200720.docX" Via Aconex Corro Ref: LL-GCOR-023873 Sent:27-8-20</p> <p><b>Approval from PCA</b> Via Crown Certificate No 20/124846-7 Issued: 28-9-2020</p>	
<b>Public Domain Works</b>							
<b>B39</b>	Prior to the commencement of any footpath, bicycle path, or public domain works on Council land, the Applicant must consult with Council and demonstrate to the Certifier that the streetscape design and treatment meets the requirements of Council, including addressing pedestrian management. The Applicant must submit documentation of approval for each stage from Council to the Certifier.	Prior to commencement of any footpath etc on Council land		Contractor	Record Keeping for communications with the Certifier, Council, Planning Secretary and other agencies as relevant.	Applicant will demonstrate will consult with Council and demonstrate to the Certifier that the streetscape design and treatment meets the requirements of Council, including addressing pedestrian management.	Not triggered
<b>Aboriginal Heritage</b>							
<b>B40</b>	Prior to the commencement of demolition or earthworks within the subject land a limited program of investigations be undertaken inclusive of machine trenching and manual excavation as outlined in the Aboriginal Cultural Heritage Assessment Report, prepared by Mary Dallas Consulting Archaeologists, dated October 2018, across the subject land. The work should be undertaken by a qualified archaeologist. These initial archaeological test excavations should be undertaken in accessible portions of the subject land, in order to determine the presence/absence of any Aboriginal archaeological remains within surviving archaeologically sensitive dune deposits.	Prior to Construction CC1 - Mar 2020		Contractor /Principal/ LHD	Copy of records / certificates of Compliance.  Record Keeping for communications with the certifier.	Monitoring works shall be undertaken by Mary Dallas of Mary Dallas Consulting Archaeologists  This Condition was subject to a proposed modification during the CC process which seeks to change the original requirement that required a programme of investigations <u>prior to the commencement of demolition or earthworks</u> to agreed <u>programme of archaeological monitoring of civil excavations along Hospital Road.</u>  Supporting documentation to enable CC1 to be issued while Modification was being processed refer email	Compliant

Randwick Campus Redevelopment

						<p>Letter –Mary Dallas_Lendlease_McKenzie Group-180220</p> <p><b>Submitted to PCA</b> Via aconex corro. Ref: LL-GCOR-015306 Sent:24 Feb 2020</p> <p>Details of DPIE application for Modification to condition B40 issued to PCA via email on 12/02/20</p> <ol style="list-style-type: none"> <li>1. Refer to DPIE letter: <i>SSD 10339 Mod 2 B40 Clarification_ PwC v2 edits</i></li> </ol> <p>Modification to Condition B40 approved</p> <ol style="list-style-type: none"> <li>2. Refer to SSD 10339 MOD 1 Instrument of Modification – issued by DPIE dated 6<sup>th</sup> March 2020</li> <li>3. Refer to SSD 10339-Mod-1Notice of determination (Mod) – issued by DPIE dated 10<sup>th</sup> March 2020</li> </ol> <p><b>Submitted to PCA</b> Via aconex corro Ref: LL-GCOR-015837 9 March 2020</p> <p>Modification approved and published on website advised 10/03/20) - <a href="https://www.planningportal.nsw.gov.au/major-projects/project/27166">https://www.planningportal.nsw.gov.au/major-projects/project/27166</a></p> <p><b>Approval from PCA</b> Via Crown Certificate No 19/124846-5 Issued: 18 Mar 20</p>	
Biodiversity							

Randwick Campus Redevelopment

B41	Prior to the commencement of tree removal, the Applicant must engage an appropriately licensed and qualified fauna ecologist to search the 10 trees approved for removal (as shown on page 18 of SSDA Landscape Design Report – Updated, prepared by Aspect Studios, Revision 9, dated 17.10.19) prior to their removal, in order to confirm the absence of native fauna, such as microbats. In the event that microbats are found, the ecologist must capture, treat and relocate the microbats to a suitable location.	Prior to any tree removal		Contractor	Engage licenced ecologist  Record Keeping of communications with the licenced ecologist.	Lendlease engaged Narla Environmental who are qualified ecologists.  Document Title; Pre-Clearing Survey Report File name: <i>Pre-clearingReport_Randwick Hospital _ Narla_v1.0</i> Prepared by Narla Environmental March 2020 v1.0  <b>Submitted to PCA</b> Via aconex corro. Ref: LL-GCOR-015582 Sent: 3 March 2020 <b>Approval from PSA</b> Via Crown Certificate No 19/124846-5 Issued: 18 Mar 20  Note: no evidence of microbats etc were found.	Compliant
<b>PART C DURING CONSTRUCTION</b>							
<b>Approved Plans to be On-site</b>							
C1	A copy of the approved and certified plans, specifications and documents incorporating conditions of approval and certification must be kept on the Site at all times and must be readily available for perusal by any officer of the Department, Council or the Certifier.	At all times		Contractor	Plans to be available on site.	Plans kept on site and are readily available.	Compliant
<b>Site Notice</b>							



**Randwick Campus Redevelopment**

<p><b>C2</b></p>	<p>A site notice(s):                  (a) must be prominently displayed at the boundaries of the site during construction for the purposes of informing the public of project details including, but not limited to the details of the Builder, Certifier and Structural Engineer is to satisfy the following requirements;                  (b) minimum dimensions of the notice must measure 841 mm x 594 mm (A1) with any text on the notice to be a minimum of 30-point type size;                  (c) the notice is to be durable and weatherproof and is to be displayed throughout the works period;                  (d) the approved hours of work, the name of the site/ project manager, the responsible managing company (if any), its address and 24-hour contact phone number for any inquiries, including construction/ noise complaint must be displayed on the site notice; and                  (e) the notice(s) is to be mounted at eye level on the perimeter hoardings/fencing and is to state that unauthorised entry to the site is not permitted.</p>	<p>Construction</p>		<p>Contractor</p>	<p>Observation / photo graphic record.</p>	<p>Items a) though to e) will be contained in the site notice board.                   2 notice boards erected. Photos issued in IA#2.</p>	<p>Compliant</p>
<p><b>Operation of Plant and Equipment</b></p>							
<p><b>C3</b></p>	<p>All construction plant and equipment used on site must be maintained in a proper and efficient condition and operated in a proper and efficient manner.</p>	<p>Construction</p>		<p>Contractor</p>	<p>Plant equipment records to be maintained.</p>	<p>Plant operators' tickets/licences are presented at the point of site induction and photocopied as part of the individual's induction record.                   Onsite checks are also conducted to see if the operator is suitably ticketed.                   Random plant pre-start checks are normally conducted on the site safety walk                   Randwick Campus Redevelopment Plant Register</p>	<p>Compliant</p>

Randwick Campus Redevelopment

Construction Hours							
C4	Construction, including the delivery of materials to and from the site, may only be carried out between the following hours: (a) between 7am and 6pm, Mondays to Fridays inclusive; and (b) between 8am and 5pm, Saturdays. No work may be carried out on Sundays or public holidays.	Construction		Note	Observation Inductions and training Management Plans Site inspections	Daily diaries  Latest Induction with C4 requirements included  Induction attendance records  Latest Management Plan/s with C4 requirements included  Toolbox attendance records  Current Site Inspection Checklist	Compliant
C5	Construction activities may be undertaken outside of the hours in condition C4 if required: (a) by the Police or a public authority for the delivery of vehicles, plant or materials; or (b) in an emergency to avoid the loss of life, damage to property or to prevent environmental harm; or (c) where the works are inaudible at the nearest sensitive receivers; or (d) for the delivery, set-up and removal of construction cranes, where notice of the crane-related works is provided to the Planning Secretary and affected residents at least seven days prior to the works; or (e) where a variation is approved in advance in writing by the Planning Secretary or his nominee if appropriate justification is provided for the works.	Construction		Note	Works planning / programming Out of Hours permit/ Approval system Out of Hours Noise assessments Management Plans Record keeping of Planning Secretary approval.	Out of hours work notification example:  Filename: SSD10339 Conditions C7-C13 Out of Hours Works Validation w Attachments A-E Dated: 11 <sup>th</sup> September 2020	Not Triggered
C6	Notification of such construction activities as referenced in condition C5 must be given to affected residents before undertaking the activities or as soon as is practical afterwards.	Construction		Note	Community consultation record keeping system	Community Notification maintained as per Stakeholders Management agreements.  Example:  Filename: SSD10339 Conditions C7-C13 Out of Hours Works Validation w Attachments A-E Dated: 11 <sup>th</sup> September 2020	Compliant
C7	Construction activities may be undertaken outside of the hours in condition C4, in accordance with the schedule of out of hours work nominated at section 3.4.2 and table 3.3 of the EIS to maintain operation of the hospital loading dock, unless directed otherwise by the Planning Secretary, and must be restricted to the following times and type of	Construction		Note	Observation Inductions and training Management Plans Site inspections	Notice of non compliance Filename: SSD10339 - Condition C7 - Non-Compliance Notification Dated: 7 <sup>th</sup> August 2020	Compliant

**Randwick Campus Redevelopment**

	<p>works:                  (a) Friday: 6:00 pm to 10:00 pm (limited to site establishment activities in preparation for weekend works).                  (b) Saturday: 5:00 pm to 10:00 pm (general construction activities excluding excavation, sawing of rock, jack hammers, pile drivers, vibratory rollers/compactors of the like).                  (c) Sunday: 8:00 am to 5:00 pm (general construction activities including excavation, sawing of rock, jack hammers, pile drivers, vibratory rollers/compactors of the like).                  (d) Sunday: 5:00 pm to 10:00 pm (general construction activities excluding excavation, sawing of rock, jack hammers, pile drivers, vibratory rollers/compactors of the like).</p>					<p>Example Application for C7</p> <p>Application:                  Filename: SSD10339 Conditions C7-C13 Out of Hours Works Validation w Attachments A-E                  Dated: 11<sup>th</sup> September 2020</p> <p>Non Compliance CLOSED.</p>	
<p><b>C8</b></p>	<p>The work permitted under condition C7:                  (a) may be undertaken for a trial period of four weekends to monitor the effectiveness of the Construction Noise Vibration Management Plan (CNVMP) for the out-of-hour works required by condition C9, with a start date and the weekends notified in writing to the Planning Secretary 14 calendar days prior to commencement. At the conclusion of the trial period, the Applicant must submit a written report as required by condition C11 within 14 calendar days.                  (b) may continue in accordance with the schedule in accordance with C7 if the Planning Secretary does not advise within two weeks of submission of the trial period report that the works must cease.                  (c) must be supported by respite days where continuous days of construction exceed 13 days. A respite day must be provided after 14 consecutive days of working.</p>	<p>14 days prior to commencement of works</p>	<p>Y</p>	<p>Note</p>	<p>written Report to be submitted</p>	<p>Notification issued 14<sup>th</sup> July 2020-27<sup>th</sup> July 2020                  Works scheduled 31<sup>st</sup> July- August 20<sup>th</sup>                  Report Supplied:                  Filename: SSD10339 Conditions C7-C13 Out of Hours Works Validation w Attachments A-E                  Dated: 11<sup>th</sup> September 2020</p>	<p>Compliant</p>

**Randwick Campus Redevelopment**

<p><b>C9</b></p>	<p>In undertaking any out-of-hours works under condition C7, the Applicant must comply with the following:  (a) prepare a CNVMP for the out-of-hours work that is to include:  (i) a description of the proposed out-of-hours works;  (ii) predictions of LAeq (15 minute) noise levels at noise sensitive receivers from these works and activities, where noise levels are predicted to be greater than the construction noise management levels in EPA's Interim Construction Noise Guideline (DECC, 2009); and  (iii) a monitoring plan to validate the noise predictions, based on monitoring at the boundary of representative sensitive receivers during noise generating activities that are representative of the out-of-hours works;  (b) the Applicant must submit the CNVMP to the Planning Secretary 14 calendar days prior to any work commencing for the duration of the trial period; and</p>	<p>14 days prior to commencement of works</p>	<p>Submit CNVMP to Planning Secretary</p>	<p>Note</p>	<p>prepare CNVMP to Planning Secretary.</p>	<p>The Department of Planning Infrastructure and Environment was notified ahead of the works on 9 July 2020 of the intended commencement date of 31 July 2020 (ref: SSD-10339-PA-11)   CNVMP refer to SSD-10339- PA-11 post-approval documentation</p>	<p>Compliant</p>
------------------	---	---	---	-------------	---	--	------------------

Randwick Campus Redevelopment

<p><b>C10</b></p>	<p>In undertaking any out-of-hours works under condition C7, the Applicant must notify potentially affected noise sensitive receivers of works outside of standard construction hours not less than five calendar days and not more than 14 calendar days before those works are to be undertaken.  (a) the notification must be:  (i) undertaken by letterbox drop or email; and  (ii) be detailed on the project website.  (b) the notification required by this condition must:  (i) clearly outline the reason that the work is required to be undertaken outside the hours specified in condition C7;  (ii) include a diagram that clearly identifies the location of the proposed works in relation to nearby cross streets and local landmarks;  (iii) include details of relevant time restrictions that apply to the proposed works;  (iv) clearly outline in plain English, the location, nature, scope and duration of the proposed works;  (v) detail the expected noise impact of the works on noise sensitive receivers;  (vi) clearly state how complaints may be made and additional information obtained;  and  (vii) include the number of the telephone complaints line, which must also be the after-hours contact phone number specific to the works undertaken outside the hours specified in condition C7, and the project website address.</p>	<p>Not less than five calendar days and not more than 14 calendar days before those works are to be undertaken</p>		<p>Contractor</p>	<p>Maintain records of methods of communication to potential sensitive receivers</p>	<p>Report Supplied:  Filename: SSD10339 Conditions C7-C13 Out of Hours Works Validation w Attachments A-E  Dated: 11<sup>th</sup> September 2020  Attachment C&amp;D</p>	<p>Compliant</p>
<p><b>C11</b></p>	<p>For out-of-hours works permitted under condition C7, a validation report must be submitted to the Planning Secretary within 14 calendar days of the completion of the trial that includes the following detail:  (a) a copy of the community notification required under condition C10; and  (b) noise monitoring undertaken during the out of hours works; and  (c) details of any exceedances of noise levels predicted in the CNVMP; and</p>	<p>Within 14 calendar days of the completion of the trial</p>	<p>Submit to Planning Secretary</p>	<p>Contractor</p>	<p>Prepare and submit Validation Report</p>	<p>Report Supplied:  Filename: SSD10339 Conditions C7-C13 Out of Hours Works Validation w Attachments A-E  Dated: 24<sup>th</sup> December 2020 following the completion of the fourth trial weekend.  Attachment B&amp;E   Comments from DPIE were address via letter dated 12-2-21 from C.Hall to DPIE.  Filename: 'SSD10339 Conditions C7-C13 Out of Hours Works Validation Feb 2021 w Attachment A'</p>	<p>Compliant</p>

**Randwick Campus Redevelopment**

	(d) details of the noise and vibration mitigation measures that were implemented during the out-of-hours works; and (e) a summary of any community complaints received by the project during the trial period.						
<b>C12</b>	Rock breaking, rock hammering, sheet piling, pile driving, and similar activities may only be carried out between the following hours: (a) 9am to 12pm, Monday to Friday; (b) 2pm to 5pm Monday to Friday; and (c) 9am to 12pm, Saturday.	Note		Note	Maintain record of working activities	Daily diaries Latest Induction with C5 requirements included Induction attendance records Latest Management Plan/s with C5 requirements included Toolbox attendance records Current Site Inspection Checklist	Compliant
<b>C13</b>	Where high noise impact activities are undertaken in accordance with the schedule of weekend closures of the loading dock nominated at section 3.4.2 and table 3.3 of the EIS to maintain operation of the hospital loading dock, the requirements of condition C12 do not apply provided that all high noise impact activities are undertaken prior to 5pm where reasonable and feasible.	Note		Note	Maintain record of working activities	Noise levels were within the levels anticipated by the CNVMP noted in Report Supplied: Filename: SSD10339 Conditions C7-C13 Out of Hours Works Validation w Attachments A-E Dated: 11 <sup>th</sup> September 2020 Attachment B	Compliant
<b>Implementation of Management Plans</b>							
<b>C14</b>	The Applicant must carry out the construction of the development in accordance with the most recent version of the approved CEMP (including Sub-Plans) and CTPMP.	Construction		Note	Observation Inductions and training Management Plans Site inspections	Reference " SSD 10339 Management Plans Register Oct 20 Rev 1" for latest revision of CEMP & CTPMP Record keeping includes: <ul style="list-style-type: none"> <li>• Daily diaries</li> <li>• Latest Induction with C5 requirements included</li> <li>• Induction attendance records</li> <li>• Latest Management Plan/s with C5 requirements included</li> <li>• Toolbox attendance records</li> <li>• Current Site Inspection Checklist</li> </ul>	Compliant
<b>Construction Traffic</b>							

**Randwick Campus Redevelopment**

<b>C15</b>	All construction vehicles (excluding worker vehicles) are to be contained wholly within the site, except if located in an approved on-street work zone, and vehicles must enter the site before stopping unless directed by traffic control. A construction zone is not permitted on High Street.	Construction		Contractor	Observation Management Plans Inductions and training	CTPMP identifies gate access/egress and approved loading zones.  Reference "SSD 10339 Management Plans Register Oct 20 Rev 1" for latest revision of CTPMP	Compliant
<b>C16</b>	The Applicant is to consult with the TfNSW and its internal stakeholders including Roads and Maritime Services, Council and the Light Rail Operator at the Traffic and Transport Construction Coordination meetings during construction	Construction		Contractor	Maintain records of consultation with TfNSW and traffic stakeholders	Ref: Consultation Meeting and Correspondence Register (v1)	Compliant
<b>Hoarding Requirements</b>							
<b>C17</b>	The following hoarding requirements must be complied with: (a) no third-party advertising is permitted to be displayed on the subject hoarding/ fencing; and (b) the construction site manager must be responsible for the removal of all graffiti from any construction hoardings or the like within the construction area within 48 hours of its application.	Construction - within 48 hours of event		Contractor	Maintain photographic records.	Prompt removal of graffiti within 48 hours – maintain evidence of removal should it occur	Not triggered
<b>Construction Noise Limits</b>							
<b>C18</b>	The development must be constructed to achieve the construction noise management levels detailed in the Interim Construction Noise Guideline (DECC, 2009). All feasible and reasonable noise mitigation measures must be implemented and any activities that could exceed the construction noise management levels must be identified and managed in accordance with the management and mitigation measures identified in the approved Construction Noise and Vibration Management Plan.	Construction		Contractor	Processes set out in the CNVMSP	All works are managed in accordance with the conditions and requirements in the Construction Noise & Vibration Management Sub Plan. CVNVMS (as prepared by Acoustic Logic).  Monitoring includes <ul style="list-style-type: none"> <li>• Monitoring records maintained</li> <li>• Noise assessments undertaken where required</li> <li>• Complaints register maintained</li> </ul> Management measures include: <ul style="list-style-type: none"> <li>• Early notification of noisy activities to residents</li> <li>• Where monitoring indicates an exceedance the site team are notified and adjust the work methodology to reduce noise, if possible</li> <li>• Review of exceedances and activities by the acoustic consultant, and updated to the CNVMSP if required.</li> </ul>	Compliant

Randwick Campus Redevelopment

						See Management Plan Tracking Matrix Filenamed; SSD10339 Management Plans Register Nov 20 Rev 1.2 Dated :November 2020 Issued as evidence in IA#2 on 3/12/20 by ACONEX LL- GCOR-029247 Management Plans revised and updated from time to time: latest revision as per the Management Plans register referenced above.	
<b>C19</b>	The Applicant must ensure construction vehicles (including concrete agitator trucks) do not arrive at the site or surrounding residential precincts outside of the construction hours of work outlined under conditions C4 and C7.	Construction		Contractor	Observation Inductions and training Inspections	All vehicle & truck movements to be in accordance with the Construction Traffic & Pedestrian Management Sub Plan. (CTPMSP)  Monitoring includes <ul style="list-style-type: none"> <li>• Daily diaries</li> <li>• Inspection checklists</li> <li>• Induction and records</li> <li>• Toolboxes and records</li> </ul>	Compliant
<b>C20</b>	The Applicant must implement, where practicable and without compromising the safety of construction staff or members of the public, the use of 'quackers' to ensure noise impacts on surrounding noise sensitive receivers are minimised.	Construction		Contractor	Observation Inductions and training Inspections	Induction and records Pre-starts and records Toolboxes and records	Compliant



Randwick Campus Redevelopment

Vibration Criteria							
C21	Vibration caused by construction at any residence or structure outside the site must be limited to: (a) for structural damage, the latest version of DIN 4150-3 (1992-02) Structural vibration - Effects of vibration on structures (German Institute for Standardisation, 1999); and (b) for human exposure, the acceptable vibration values set out in the Environmental Noise Management Assessing Vibration: a technical guideline (DEC, 2006) (as may be updated or replaced from time to time).	Construction		Contractor	Processes set out in the CNVMSP	<p>All works are managed in accordance with the conditions and requirements in the Construction Noise &amp; Vibration Management Sub Plan. CVNVMSPP) as prepared by Acoustic Logic.</p> <p>Monitoring includes</p> <ul style="list-style-type: none"> <li>• Monitoring records maintained and issued to HI/PwC.</li> <li>• Noise assessments undertaken where required</li> <li>• Complaints register maintained</li> </ul> <p>Noise and Vibration register Filename: Noise Dust Vibration Register 201007 Revision dated 07<sup>th</sup> October 2020</p> <p>See Management Plan Tracking Matrix Filename: SSD10339 Management Plans Register Nov 20 Rev 1.2 Dated :November 2020 Issued as evidence in IA#2 on 3/12/20 by ACONEX LL-GCOR-029247 Management Plans revised and updated from time to time: latest revision as per the Management Plans register referenced above</p>	Compliant
C22	Vibratory compactors must not be used closer than 30 metres from residential buildings unless vibration monitoring confirms compliance with the vibration criteria specified in condition C21.	Construction		Contractor	Processes set out in the CNVMSP	No vibratory compactors have been used with specified distance in condition or requirements described in C21	Compliant
C23	The limits in conditions C21 and C22 apply unless otherwise outlined in a Construction Noise and Vibration Management Sub-Plan, approved as part of the CEMP required by condition B12 of this consent or CNVMSP required by condition C9(a) of this consent.	Construction		Contractor	Processes set out in the CNVMSP	Noted	Compliant
Air Quality							
C24	The Applicant must take all reasonable steps to minimise dust generated during all works authorised by this consent.	Construction		Contractor	Processes set out in the AQMP	Lendlease recognises this requirement and will ensure that it is complied with through the duration of the project.	Compliant

Randwick Campus Redevelopment

						<p>All works are managed in accordance with the conditions and requirements in the Air Quality Management Sub Plan (AQMSP) as prepared by Lendlease.</p> <p>Water dust suppression policy and apparatus in place to control any potential dust events</p> <ul style="list-style-type: none"> <li>• Weather alerts</li> <li>• Inspection reports</li> </ul>	
<b>C25</b>	<p>During construction, the Applicant must ensure that:</p> <p>(a) exposed surfaces and stockpiles are suppressed by regular watering;</p> <p>(b) all trucks entering or leaving the site with loads have their loads covered;</p> <p>(c) trucks associated with the development do not track dirt onto the public road network;</p> <p>(d) public roads used by these trucks are kept clean; and</p> <p>(e) land stabilisation works are carried out progressively on site to minimise exposed surfaces.</p>	Construction		Contractor	Processes set out in the AQMP Training & monitoring	<p>a) All stockpiles are regularly suppressed by watering</p> <p>b) All trucks entering or leaving site have loads covered</p> <p>c) cattle grid and truck wash positioned at site access point.</p> <p>d) Acknowledged by placement of cattlegrids and wheel washing points at exit points</p> <p>e) Land stabilisation is carried out to exposed surfaces – use of dust binders</p> <p>Monitoring &amp; records would include;</p> <ul style="list-style-type: none"> <li>• Inspection reports</li> <li>• Construction Phase activity</li> <li>• Toolbox talks / daily tasks</li> </ul>	Compliant

Randwick Campus Redevelopment

Erosion and Sediment Control							
C26	All erosion and sediment control measures must be effectively implemented and maintained at or above design capacity for the duration of the construction works and until such time as all ground disturbed by the works have been stabilised and rehabilitated so that it no longer acts as a source of sediment. Erosion and sediment control techniques, as a minimum, are to be in accordance with the publication Managing Urban Stormwater: Soils & Construction (4th edition, Landcom, 2004) commonly referred to as the 'Blue Book'.	Construction		Contractor	Erosion and Sediment Control Plan Observation Inspection	<p>All works are managed in accordance with the conditions and requirements in the Stormwater &amp; Erosion Management Plan prepared by Lendlease</p> <p>Inspection and maintenance records</p> <p>CC2 drawing &amp; Certification: <b>Submitted to PCA</b> Drawing Title: RCR-ACR-CV-00-DWG-00-401 Rev 1 Civil Design Certification Filename: "SY180053_Civil RCR HRL CC2 Design Certificate_R2_200720.docX" Via Aconex Corro Ref: LL-GCOR-023873 Sent:27-8-20</p> <p><b>Approval from PCA</b> Via Crown Certificate No 20/124846-7 Issued: 28-9-2020</p>	Compliant
Imported Soil							
C27	The Applicant must: (a) ensure that only VENM, ENM, or other material approved in writing by EPA is brought onto the site; (b) keep accurate records of the volume and type of fill to be used; and (c) make these records available to the Certifier upon request.	Construction		Contractor	Material tracking system Observations. Make records available to Certifier upon request.	<p>a) records kept in imported materials register b) records kept in imported materials register c) request acknowledged</p>	Compliant
Disposal of Seepage and Stormwater							
C28	Adequate provisions must be made to collect and discharge stormwater drainage during construction of the building to the satisfaction of the principal Certifier. The prior written approval of Council must be obtained to connect or discharge site stormwater to Council's stormwater drainage system or street gutter.	Construction		Contractor	Off-site water Discharge/ de-watering Procedure Water quality test results EPA approvals	EPA Approval Dewatering/ Discharge Procedure prior to discharge of waters	Compliant

Randwick Campus Redevelopment

Unexpected Finds Protocol – Aboriginal Heritage							
C29	<p>In the event that surface disturbance identifies a new Aboriginal object, all works must halt in the immediate area to prevent any further impacts to the object(s). A suitably qualified archaeologist and the registered Aboriginal representatives must be contacted to determine the significance of the objects. The recommendations in the Aboriginal Cultural Heritage Assessment Report prepared by Mary Dallas Consulting Archaeologists dated October 2018 shall be adhered to.</p> <p>The site is to be registered in the Aboriginal Heritage Information Management System (AHIMS) which is managed by EES Group and the management outcome for the site included in the information provided to AHIMS. The Applicant must consult with the Aboriginal community representatives, the archaeologists and EES Group to develop and implement management strategies for all objects/sites. Works shall only recommence with the written approval of EES Group.</p>	Construction		Contractor	<p>Observations if required record of consultation with Aboriginal Community, archaeologist and EES groups</p> <p>Inductions and training</p> <p>Inspections</p>	<p>Refer to CEMP section 12.2 &amp; Aboriginal Cultural Heritage assessment Report dated Oct 2018 by MDCA and subsequent appendix c</p>	Compliant
Unexpected Finds Protocol – Historic Heritage							
C30	<p>If any unexpected archaeological relics are uncovered during the work, then all works must cease immediately in that area and the NSW Heritage Division contacted. Depending on the possible significance of the relics, an archaeological assessment and management strategy may be required before further works can continue in that area. Works may only recommence with the written approval of the NSW Heritage Division.</p>	Construction		Contractor	<p>Observation</p> <p>Inductions and training</p> <p>Inspections</p>	<p>Management Plan in place</p> <p>See Management Plan Tracking Matrix</p> <p>File named; SSD10339 Management Plans Register</p> <p>Nov 20 Rev 1.2</p> <p>Dated :November 2020</p> <p>Issued as evidence in IA#2 on 3/12/20 by ACONEX LL-GCOR-029247</p> <p>Unexpected finds protocol</p> <p>Daily diaries</p> <p>Inspection checklists</p> <p>Induction and records</p> <p>Pre-starts and records</p> <p>Toolboxes and records</p> <p>Incident reports</p> <p>Management Strategy</p> <p>OEH approval to recommence</p>	Compliant
Waste Storage and Processing							

Randwick Campus Redevelopment

C31	Waste must be secured and maintained within designated waste storage areas at all times and must not leave the site onto neighbouring public or private properties.	Construction		Contractor	Observation Inspections Works planning / programming CWMSP Waste tracking system	For implementation strategy refer to <b>Construction Waste Management Subplan (CWMSP):</b>  Refer to CEMP section 5.3.14 Waste Management  Latest revision See Management Plan Tracking Matrix Filed named; SSD10339 Management Plans Register Nov 20 Rev 1.2 Dated :November 2020 Issued as evidence in IA#2 on 3/12/20 by ACONEX LL- GCOR-029247 No complaints registered to date.	Compliant
C32	All waste generated during construction must be assessed, classified and managed in accordance with the Waste Classification Guidelines Part 1: Classifying Waste (EPA, 2014).	Construction		Contractor	Observation Inspections Works planning / programming CWMSP Waste tracking system	For implementation strategy refer to <b>Construction Waste Management Subplan (CWMSP):</b>  Refer to section 2.0 – implementation of the Subplan which states policy is to be in accordance with Waste Classification Guidelines Part 1: Classifying Waste (EPA, 2014).	Compliant
C33	The body of any vehicle or trailer used to transport waste or excavation spoil must be covered before leaving the premises to prevent any spillage or escape of any dust, waste or spoil. Mud, splatter, dust and other material likely to fall from or be cast off the wheels, underside or body of any vehicle, trailer or motorised plant leaving the site must be removed before leaving the premises.	Construction		Contractor	Works planning / programming Observation Inspection	Project site has installed cattle grids and truck wash stations at all exit points from site to avoid any material from being transported onto public highways  Project has not received any complaints to date.	Compliant
C34	The Applicant must ensure that concrete waste and rinse water are not disposed of on the site and are prevented from entering any natural or artificial watercourse.	Construction		Contractor	Works planning / programming Erosion and Sediment Control Plan Observation Inspection	For details refer to <b>Construction Waste Management Subplan (CWMSP):</b> in particular appendix 1 - Key Waste Streams” & “Control Measures”	Compliant
<b>Independent Environmental Audit</b>							
C35	Proposed independent auditors must be agreed to in writing by the Planning Secretary prior to the commencement of an Independent Audit.	commencement of IA	In writing to Planning Secretary	Principle/L HD	Evidence of Independent Auditor submission to and approval from Planning Secretary	Refer to PWCAU-GCOR-006271 for confirmation of IEA. – date 10/02/20 (NGH Consulting - Mr Erwin Budde).	Compliant
C36	Within four weeks of the commencement of construction, an Independent Audit Schedule	Within four weeks of the	submitted to	Contractor	Independent Audit Program Record Keeping System for	Independent Audit Program submitted to DPIE: 22/05/2019.	Compliant

Randwick Campus Redevelopment

	prepared in accordance with section 2.1 of the Independent Audit Post Approval Requirements, (Department 2018, or as amended), as amended by condition C37 must be submitted to the Planning Secretary and the Certifier.	commencement of construction	Planning Secretary		communications with the Certifying Authority. Record Keeping System for communications with the Department	NGH Environmental Independent Audit Schedule 2.1 Audit Schedule  Reference made to request by Independent Auditor and supported by PwC to combine the programme of Independent Audits so SSDA 9113 & SSDA 10339 are conducted simultaneously	
<b>C37</b>	Table 1 of the Independent Audit Post Approval Requirements (Department 2018, or as amended) is amended so that the Independent Audit Schedule frequency of Independent Audits required in the construction phase is: (a) an initial construction Independent Audit must be undertaken within twelve weeks of the notified commencement date of construction; and (b) subsequent Independent Audits of construction must be undertaken at intervals, no greater than 26 weeks from the date of the initial construction Independent Audit.	Within twelve weeks of the notified commencement date of construction;		Contractor	Independent Audit Program	Initial Construction Independent Report as per Independent Audit Report prepared by NGH Pty Ltd – dated 22 <sup>nd</sup> July 2020 Rev 0. Filename: IASB Audit Report July 2020 Final Rev0.  Audit date was 23 <sup>rd</sup> June 2020 within 12 weeks of commencement of construction  Independent Audit #2 was undertaken on 2 <sup>nd</sup> December 2020 which is within 26 weeks of IA#1.	Compliant
<b>C38</b>	In all other respects Table 1 of the Independent Audit Post Approval Requirements (Department 2018, or as amended) remains the same. The Planning Secretary may require Independent Audits to be undertaken at different times to those specified above, upon giving at least eight weeks' notice to the Applicant of the date upon which the Independent Audit must be commenced.	Upon giving at least eight weeks' notice	Planning Secretary may require.	Contractor	Independent Audit Program  Independent Audit	<b>Noted</b>	Compliant
<b>C39</b>	Independent Audits of the development must be carried out in accordance with: (a) the Independent Audit Schedule submitted to the Planning Secretary and the Certifier under condition C36 of this consent; and (b) the Independent Audit Post Approval Requirements (Department 2018, or as amended).	Construction		Contractor	Independent Audit Program  Independent Audit	<b>Independent Audit 1 : 23<sup>rd</sup> June 2020</b> Audit Dates:23 <sup>rd</sup> June 2020 Prepared by: NGH Independent Audit 1 Report Titled: " INDEPENDENT AUDIT REPORT Randwick Campus Redevelopment Integrated Acute Services Building (IASB) SSD 10339" Filename: "IASB Audit Report July 2020 Final Rev0"  Report Submitted to DPIE: Monday 27 <sup>th</sup> July 2020 (Ref: SSD10339 IEA#1, File name: PoW IASB Post Approval Document Received - (SSD-10339-PA-12)	Compliant

Randwick Campus Redevelopment

						<p><b>Independent Audit 2 : 10<sup>th</sup> December 2020</b>          Audit Dates: 2<sup>nd</sup> December 2020          Prepared by: NGH          Independent Audit 2 Report Titled: "INDEPENDENT AUDIT REPORT Randwick Campus Redevelopment Integrated Acute Services Building (IASB) SSD 10339"          Filename: "IASB Audit Report Devember 2020 Final Rev1"</p> <p>Issued on Aconex to PWC and PCA LL-GCOR-029851 dated 15<sup>th</sup> December          Received by PWC dated 17<sup>th</sup> December 2020 filename: "Aconex record of receipt by PWC and PCA"</p> <p>Report &amp; Proponent Response Submitted to DPIE: 17<sup>th</sup> December 2020 (Ref: SSD10339 IE#2),          Post approval document issued:          File name: <i>Prince of Wales Hospital - Addition to approved Acute Services Building - Post Approval Document Received - (SSD-10339-PA-18)</i></p>	
C40	<p>In accordance with the specific requirements in the Independent Audit Post Approval Requirements (Department 2018, or as amended), the Applicant must:          (a) review and respond separately to each Independent Audit Report prepared under condition C39 of this consent;          (b) submit the response to the Planning Secretary and the Certifier; and          (c) make each Independent Audit Report and response to it publicly available 60 days after submission to the Planning Secretary.</p>	Construction	Submit response to Planning Secretary	Contractor	<p>Compliance reporting</p> <p>Independent Audit</p> <p>Website periodic review evidence of communication with Planning Secretary &amp; Certifier.</p>	<p>Part a)          Proponent response noted Document title " Randwick campus REDEVELOPMENT Prince of Wales UNSW Addition &amp; lowering hospital road          SSD Number: 10339          Filename:" RCR - IASB - Proponent Response to Independent Audit #1"          Dated 24 July 2020</p> <p>Proponent Response for IA#2:          Filename: <i>RCR - SSD10339- Proponent Response to IA#2</i>          Dated: 11<sup>th</sup> December 2020</p> <p>Part b)          Proponent Report Issued to PCA ACONEX LLGCOR-022228 dated 30th July 2020          Proponent Report Submitted to DPIE: Monday 27<sup>th</sup> July 2020 (Ref: SSD10339 IEA#1, File name: <i>PoW IASB Post Approval Document Received - (SSD-10339-PA-12)</i>)</p>	Compliant

Randwick Campus Redevelopment

						<p>Proponent Response for IA#2 Submitted to DPIE 17<sup>th</sup> December 2020  DPIE Post approval document issued:  File name: <i>Prince of Wales Hospital - Addition to approved Acute Services Building - Post Approval Document Received - (SSD-10339-PA-18)</i>  Dated: 18<sup>th</sup> December 2020</p> <p>Part c) Documents evident on website  <a href="http://randwickcampusredevelopment.health.nsw.gov.au/projects/integrated-acute-services-building-addition/ssd-10339-documentation">http://randwickcampusredevelopment.health.nsw.gov.au/projects/integrated-acute-services-building-addition/ssd-10339-documentation</a></p>	
<b>C41</b>	Independent Audit Reports and the Applicant's response to audit findings must be submitted to the Department within 21 days of the date referenced in the Independent Audit Schedule, unless otherwise agreed by the Planning Secretary.	Within 21 days IA schedule.		Contractor	record of responses	<p>IE#1: Audit and Proponent Report Submitted to DPIE: Monday 27<sup>th</sup> July 2020 (Ref: SSD10339 IEA#1, File name: <i>PoW IASB Post Approval Document Received - (SSD-10339-PA-12)</i>)</p> <p>IE#2: Audit Report &amp; Proponent Response Submitted to DPIE: 17<sup>th</sup> December 2020 (Ref: SSD10339 IE#2), Post approval document issued:  File name: <i>Prince of Wales Hospital - Addition to approved Acute Services Building - Post Approval Document Received - (SSD-10339-PA-18)</i>)</p>	Compliant
<b>C42</b>	Notwithstanding the requirements of the Independent Audit Post Approval Requirements (Department 2018), the Planning Secretary may approve a request for ongoing operational Independent Audits to be ceased, where it has been demonstrated to the Planning Secretary's satisfaction that Independent Audits have demonstrated consistent operational compliance.	Construction	Planning Secretary may cease IA's	Contractor	Record Keeping System for communications with the Department	Record of Planning Secretary approval for cessation	Not triggered
<b>Handling of Asbestos</b>							
<b>C43</b>	The Applicant is to consult with SafeWork NSW concerning the handling of any asbestos waste that may be encountered during construction. The requirements of the Protection of the Environment Operations (Waste) Regulation 2014 with particular reference to Part 7 – 'Transportation and management of asbestos waste' must also be complied with.	Construction		Contractor	Hazmat Report CWMSP	<p>Procedure for handling and disposing of asbestos will follow:</p> <ul style="list-style-type: none"> <li>Code of Practice for Safe Removal of asbestos (NOHSC:2002 (2005))</li> </ul> <p>And</p> <ul style="list-style-type: none"> <li>Guide to the Control of Asbestos Hazards in Buildings &amp; Structures (NOHSC: 3002 (1988))</li> </ul>	Not triggered



Randwick Campus Redevelopment

						These are stated in the CEMP – section 8.0: authorities Letter from	
<b>Community Engagement</b>							
C44	The Applicant must consult with the community regularly throughout construction, including consultation with the nearby sensitive residential receivers located in Magill Street and relevant regulatory authorities and other interested stakeholders.	Construction		Principle/L HD/Contractor	Record Keeping of evidence of consulting with community in accordance with CCS	<p>With reference to the Lendlease Community Engagement Strategy &amp; Construction Communications plan</p> <p>Filename: IASB-Appendix-X2-LLB-Construction-Communications-Plan – FINAL – Sept 2020 Review Dated: 30<sup>th</sup> September 2020 V3.0</p> <p>Regular ongoing engagement with key stakeholders is on a fortnightly basis through the Hospital Road and Construction Interface meeting. Monthly meetings are held with TfNSW (SCO) and meetings with Council Planning, Project Management &amp; Traffic Committee are held frequently, as needed</p> <p>Registers record details of engagement including:</p> <ul style="list-style-type: none"> <li>Record of Key engagement activities with Authorities (draft) - File name: <i>Consultation, Meeting &amp; Correspondence Register (v1)</i></li> <li>Record of complaints - File name : <i>RCR - Complaints Register as at May 2020 – web</i></li> <li>Record of engagement activities with community &amp; key stakeholders (e.g. neighbours &amp; adjacent hospital) - File name: <i>Construction Stakeholder and Community Engagement - Schedule of Activity - 200713</i></li> </ul>	Compliant

Randwick Campus Redevelopment

Builders Details							
C45	<p>The Applicant must provide the builder's direct contact number to surrounding stakeholders impacted by the construction work and the Transport Management Centre and Sydney Coordination Office within TfNSW to resolve issues relating to traffic, freight, servicing and pedestrian access during construction in real time. The Applicant is responsible for ensuring the builder's direct contact number is current during any stage of construction.</p>	Construction		Contractor	<p>Record keeping of corresponding with Transport Management Centre and Sydney Coordination Office within Transport for NSW</p>	<p>Lendlease is responsible for managing the 1800 24/7 community contact number providing community members and local stakeholders with direct access to the builder for complaints handling. This number is available on all project communication collateral and is actively promoted to stakeholders and local community members during engagement activities. Project contact cards, displaying this number, are made available to all personnel working externally to the construction site to pass to road users, pedestrians and residents who approach workers and wish to make direct contact with the construction team. In addition, the contact numbers for Senior Site Manager and Construction Manager are displayed at the site access gate. The 1800 community contact number has been available since site establishment in 2018.</p> <p>Submission of CTPMP provided direct contact details for the site. (Richard Yarad Construction Manager). CTPMP_IASB_June20_r5 issued by email to PWC &amp; TfNSW on 18/6/20 by Richard Yarad &amp; updated 3/7/20 titled "RCR-IASB-TfNSW Construction Staging Meeting"</p>	Compliant

Randwick Campus Redevelopment

PART D PRIOR TO COMMENCEMENT OF OPERATION							
<b>Notification of Occupation</b>							
D1	At least one month before commencement of operation, the date of commencement of the operation of the development must be notified to the Planning Secretary in writing. If the operation of the development is to be staged, the Planning Secretary must be notified in writing at least one month before the commencement of each stage, of the date of commencement and the development to be carried out in that stage.	One month before commencement of operation,	Notification to Planning Secretary	Contractor to advise Principal  Principal to advise Planning Dept	Pre operations compliance report	Notice of commencement to the Dept (including date)	Not triggered
<b>External Walls and Cladding</b>							
D2	Prior to commencement of operation, the Applicant must provide the Certifier with documented evidence that the products and systems used in the construction of external walls including finishes and claddings such as synthetic or aluminium composite panels comply with the requirements of the BCA.	Prior to commencement of operation		Contractor	Submission of information for occupation certificate	Issuance of Occupation Certificate	Not triggered
D3	The Applicant must provide a copy of the documentation given to the Certifier to the Planning Secretary within seven days after the Certifier accepts.	Within 7 days after Certifier approves	submission to Planning Secretary	Contractor	Submission of information for occupation certificate	Provide documentation to Planning Secretary	Not triggered
<b>Post-construction Dilapidation Report</b>							
D4	Prior to commencement of operation, the Applicant must engage a suitably qualified person to prepare a post-construction dilapidation report at the completion of construction. This report is: a) to ascertain whether the construction created any structural damage to adjoining buildings or infrastructure; b) to be submitted to the Certifier. In ascertaining whether adverse structural damage has occurred to adjoining buildings or infrastructure, the Certifier must: i) compare the post-construction dilapidation report with the pre-construction dilapidation report required by these conditions; and ii) have written confirmation from the relevant authority that there is no adverse structural damage to their infrastructure and roads. c) to be forwarded to Council.	Prior to commencement of operation,		Contractor	Works planning / programming Submission to Certifier Forwarded to Council	Post dilapidation reports Submission of reports to Certifying Authority and Council Certifying Authority statement of review and written confirmation on damage.	Not triggered

Randwick Campus Redevelopment

Protection of Public Infrastructure							
D5	<p>Unless the Applicant and the applicable authority agree otherwise, the Applicant must:</p> <p>(a) repair, or pay the full costs associated with repairing, any public infrastructure that is damaged by carrying out the development; and</p> <p>(b) relocate, or pay the full costs associated with relocating any infrastructure that needs to be relocated as a result of the development.</p> <p>Note: This condition does not apply to any damage to roads caused as a result of general road usage or otherwise addressed by contributions required by conditions of this consent.</p>	Prior to Operation		Contractor	<p>Submission of information for occupation certificate</p> <p>Pre operations compliance report Dilapidation reporting</p>	<p>Pre and post dilapidation reports</p> <p>Damage payment records</p> <p>Occupation certificate issuance</p>	Not triggered
Protection of Property							
D6	<p>Unless the Applicant and the applicable owner agree otherwise, the Applicant must repair, or pay the full costs associated with repairing any property that is damaged by carrying out the development.</p>	Prior to Operation		Contractor	<p>Submission of information for occupation certificate</p> <p>Pre operations compliance report Dilapidation reporting</p>	<p>Pre and post dilapidation reports</p> <p>Damage payment records</p> <p>Occupation certificate issuance</p>	Not triggered
Utilities and Services							
D7	<p>Prior to commencement of operation, the Applicant must obtain a Compliance Certificate for water and sewerage infrastructure servicing of the site under section 73 of the Sydney Water Act 1994.</p>	Prior to Operation		Contractor	Works planning / programming	Compliance Certificate for water and sewerage infrastructure servicing of the site under section 73	Not triggered
Works as Executed Plans							
D8	<p>Prior to the commencement of operation, works-as-executed drawings signed by a registered surveyor demonstrating that the stormwater drainage and finished ground levels have been constructed as approved, must be submitted to the Certifier.</p>	Prior to Operation		Contractor	Acquire works as executed drawings	<p>Provide evidence that as-executed drawings have been approved by Registered Surveyor.</p> <p>Record of submission to Certifier.</p>	Not triggered

Randwick Campus Redevelopment

Green Travel Plan							
D9	<p>Prior to the commencement of operation, a Green Travel Plan (GTP), must be submitted to the Certifier to promote the use of active and sustainable transport modes. The plan must:</p> <p>(a) be prepared by a suitably qualified traffic consultant in consultation with Randwick City Council and TfNSW (Sydney Coordination Office) and all stakeholders within the Randwick Health and Education Precinct;</p> <p>(b) include objectives and modes share targets (i.e. Site and land use specific, measurable and achievable and timeframes for implementation) to define the direction and purpose of the GTP;</p> <p>(c) identify strategies and mode share targets that encourage the use of public and active transport and reduce the proportion of single-occupant car journeys to the site;</p> <p>(d) include measures to promote and support the implementation of the plan, including financial and human resource requirements, roles and responsibilities for relevant employees involved in the implementation of the GTP;</p> <p>(e) include details regarding the methodology and monitoring/review program to measure the effectiveness of the objectives and mode share targets of the GTP, including the frequency of monitoring and the requirement for travel surveys to identify travel behaviours of users of the development;</p> <p>(f) include a Transport Access Guide that provides information to students/employees/visitors about the range of travel modes, access arrangements and supporting facilities that service the site;</p> <p>(g) identify relevant workplace policies such as flexible working and teleworking arrangements that enable travel outside peak periods or which reduce the need for work related travel (where applicable); and</p> <p>(h) nominate the party/parties responsible for implementing the Travel Plan and its ongoing monitoring and review, including the delivery of actions and associated mode share targets.</p>	Prior to Operation		Principal/LHD	Record of consultation with RCC & TfNSW Record of submission to Certifier.	Consultation records with TfNSW, RMS, Council and stakeholders within the Randwick Health and Education Precinct.	Not triggered

Randwick Campus Redevelopment

Mechanical Ventilation							
D10	Prior to commencement of operation, the Applicant must provide evidence to the satisfaction of the Certifier that the installation and performance of the mechanical ventilation systems complies with: (a) AS 1668.2-2012 The use of air-conditioning in buildings – Mechanical ventilation in buildings and other relevant codes; (b) The BCA and the development consent and any relevant modifications; and (c) any dispensation granted by Fire and Rescue NSW.	Prior to Operation		Contractor	Submission of information for occupation certificate Pre operations compliance report	Mechanical plant installation report Occupation certificate issuance Issue to Certifier	Not triggered
Operational Noise – Design of Mechanical Plant and Equipment							
D11	Prior to the commencement of operation, the Applicant must submit evidence to the Certifier that the noise mitigation recommendations Noise and Vibration Impact Assessment Issue 5 dated 5 August 2019, prepared by Acoustic Studio have been incorporated into the design to ensure the development will not exceed the recommended operational noise levels identified in the Noise and Vibration Impact Assessment.	Prior to Operation		Contractor	Copy of records / certificates of Compliance. Record Keeping for communications with the certifier.	Submit Acoustic report which should align with all recommendation with the Acoustic studio report – dated 5 <sup>th</sup> August 2019	Not triggered
Road Damage							
D12	Prior to the commencement of operation, the cost of repairing any damage caused to Council or other Public Authority's assets in the vicinity of the Subject Site as a result of construction works associated with the approved development must be met in full by the Applicant.	Prior to Operation		Contractor	Submission of information for occupation certificate Pre operations compliance report Dilapidation reporting	Pre and post dilapidation reports Damage payment records Occupation certificate issuance	Not triggered
Fire Safety Certification							
D13	Prior to commencement of occupation, a Fire Safety Certificate must be obtained for all the Essential Fire or Other Safety Measures forming part of this consent. A copy of the Fire Safety Certificate must be submitted to the relevant authority and Council. The Fire Safety Certificate must be prominently displayed in the building.	Prior to Operation		Contractor	Submission of information for occupation certificate Pre operations compliance report Design plan review	Provide Fire Safety Certificate	Not triggered
Structural Inspection Certificate							

Randwick Campus Redevelopment

D14	Prior to the commencement of occupation of the relevant parts of any new or refurbished buildings, a Structural Inspection Certificate or a Compliance Certificate must be submitted to the satisfaction of the Certifier. A copy of the Certificate with an electronic set of final drawings (contact approval authority for specific electronic format) must be submitted to the approval authority and the Council after: (a) the site has been periodically inspected and the Certifier is satisfied that the structural works is deemed to comply with the final design drawings; and (b) the drawings listed on the Inspection Certificate have been checked with those listed on the final Design Certificate/s.	Prior to Operation		Contractor	Submission of information for occupation certificate Pre operations compliance report Design plan review	Structural Inspection Certificate or a Compliance Certificate  Occupation certificate issuance  Statement of satisfaction from Certifying Authority Submission to Certifying Authority and Council	Not triggered
<b>Warm Water Systems and Cooling Systems</b>							
D15	The installation of warm water systems and water cooling systems (as defined under the Public Health Act 2010) must comply with the Public Health Act 2010, Public Health Regulation 2012 and Part 1 (or Part 3 if a Performance-based water cooling system) of AS/NZS 3666.2:2011 Air handling and water systems of buildings – Microbial control – Operation and maintenance and the NSW Health Code of Practice for the Control of Legionnaires' Disease.	Prior to and during operation		Contractor	Submission of information for occupation certificate Pre operations compliance report Maintenance programming	Installation and maintenance records	Not triggered
<b>Outdoor Lighting</b>							
D16	Prior to the commencement of operation, the Applicant must submit evidence from a suitably qualified practitioner to the Certifier that demonstrates that installed lighting associated with the development achieves the objective of minimising light spillage to any adjoining or adjacent sensitive receivers and: (a) complies with the latest version of AS 4282-2019 - Control of the obtrusive effects of outdoor lighting (Standards Australia, 1997); and (b) has been mounted, screened and directed in such a manner that it does not create a nuisance to surrounding properties or the public road network.	Prior to Operation		Contractor	Submission of information for occupation certificate Pre operations compliance report	Lighting strategy Occupation certificate issuance  Submission to Department and Council	Not triggered

Randwick Campus Redevelopment

Signage							
D17	Prior to the commencement of operation, bicycle way-finding signage must be installed within the site to direct cyclists from footpaths to designated bicycle parking areas.	Prior to Operation		Contractor	Lighting design review Submission of information for occupation certificate Pre operations compliance report	Issuance of occupation certificate	Not triggered
Traffic Management Plan							
D18	Prior to commencement of operation, the Applicant must prepare a Traffic Management Plan to the satisfaction of the Planning Secretary in relation to the operation of the Hospital Road/Magill Street intersection. The Plan must: (a) be prepared by a suitably qualified and experienced person(s); (b) be prepared in consultation with Council; (c) detail the measures to ensure road safety and network efficiency, particularly in relation to the entry/exits points to the hospital car park; (d) details of the operation of the boom gate; and (e) contain a Traffic Monitoring Program to monitor the impact of increased traffic using the intersection.	Prior to Operation	satisfaction of Planning Secretary	Contractor	Submission of information for occupation certificate  Record of consultation with Council  Engage qualified person.	Submit Traffic Management Plan to satisfaction of Planning Secretary	Not triggered



Randwick Campus Redevelopment

Operational Waste Management Plan							
D19	Prior to the commencement of operation, the Applicant must prepare a Waste Management Plan for the development and submit it to the Certifier. The Waste Management Plan must: (a) detail the type and quantity of waste to be generated during operation of the development; (b) describe the handling, storage and disposal of all waste streams generated on site, consistent with the Protection of the Environment Operations Act 1997, Protection of the Environment Operations (Waste) Regulation 2014 and the Waste Classification Guideline (Department of Environment, Climate Change and Water, 2009); (c) detail the materials to be reused or recycled, either on or off site; and (d) include the Management and Mitigation Measures included in the EIS and RtS.	Prior to Operation		LHD/UNSW	Submission of information to Certifier	Operational Waste Management Plan Submission to Certifying Authority and Department  Issuance of occupation certificate	Not triggered
Site Audit Report and Site Audit Statement							
D20	Prior to the commencement of operation, the Applicant must obtain from an EPA accredited Site Auditor, a Site Audit Statement and a Site Audit Report which demonstrates that the site is suitable for its intended use(s).	Prior to Operation		Contractor	Evidence of completed SAS & SAR	Provide Site Auditor Statement and Site Audit Report	Not triggered
Landscaping							
D21	Prior to the commencement of operation, the Applicant must prepare an Operational Landscape Management Plan to manage the landscaping on-site, to the satisfaction of the Certifier. The plan must describe the ongoing monitoring and maintenance measures to manage landscaping.	Prior to Operation		LHD/UNSW	Submission of information for occupation certificate. Evidence of submission to Certifier.	Provide Landscape Management Plan to satisfaction of Certifier. Issuance of occupation certificate	Not triggered
Waste Collection							
D22	Prior to the commencement of the operation, the Certifier must be satisfied the waste management and storage areas have been	Prior to Operation		LHD/UNSW	Submission of information for occupation certificate.	Provide Waste and Storage information to satisfaction of Certifier.	Not triggered

Randwick Campus Redevelopment

	completed in accordance with Council Waste management requirements.				Evidence of submission to Certifier.		
<b>Noise Mitigation Measures</b>							
D23	Prior to the commencement of the operation, the Certifier must be satisfied the noise mitigation measures have been completed in accordance with the Noise Mitigation Strategy (condition A30) if required.	Prior to Operation		Contractor/Principal	Submission of information for occupation certificate. Evidence of submission to Certifier.	Provide details of noise mitigation measures to the satisfaction of the Certifier	Not triggered
<b>PART E POST OCCUPATION</b>							
<b>Operation of Plant and Equipment</b>							
E1	All plant and equipment used on site must be maintained in a proper and efficient condition operated in a proper and efficient manner.	Post Occupation		LHD/UNSW	TBD	TBD	Not triggered
<b>Warm Water Systems and Cooling Systems</b>							
E2	The operation and maintenance of warm water systems and water cooling systems (as defined under the Public Health Act 2010) must comply with the Public Health Act 2010, Public Health Regulation 2012 and Part 2 (or Part 3 if a Performance-based water cooling system) of AS/NZS 3666.2:2011 Air handling and water systems of buildings – Microbial control – Operation and maintenance and the NSW Health Code of Practice for the Control of Legionnaires' Disease.	Post Occupation		LHD/UNSW	TBD	TBD	Not triggered
<b>Operational Noise Limits</b>							
E3	The Applicant must ensure that noise generated by operation of the development does not exceed the noise limits in the Noise and Vibration Impact Assessment, Issue 5, dated 5 August 2019, prepared by Acoustic Studio	Post Occupation		Principal/LHD/UNSW	TBD	TBD	Not triggered

**Randwick Campus Redevelopment**

<p><b>E4</b></p>	<p>The Applicant must undertake short term noise monitoring in accordance with the Noise Policy for Industry where valid data is collected following the commencement of use of each stage of the development. The monitoring program must be carried out by an appropriately qualified person and a monitoring report must be submitted to the Planning Secretary within two months of commencement of each stage of the development to verify that operational noise levels do not exceed the recommended noise levels for mechanical plant identified in Noise and Vibration Impact Assessment, Issue 5, dated 5 August 2019, prepared by Acoustic Studio.</p> <p>Should the noise monitoring program identify any exceedance of the recommended noise levels referred to above, the Applicant is required to implement appropriate noise attenuation measures so that operational noise levels do not exceed the recommended noise levels or provide attenuation measures at the affected noise sensitive receivers.</p>	<p>Post Occupation - within 2 months of commencement of each stage</p>	<p>submission of monitoring report to Planning Secretary</p>	<p>Principal/LHD/UNSW</p>	<p>TBD</p>	<p>TBD</p>	<p>Not triggered</p>
------------------	--	--	--	---------------------------	------------	------------	----------------------

Randwick Campus Redevelopment

E5	<p>Within six months of commencement of operation, the Applicant must undertake operational noise monitoring to identify the actual noise performance of the development and prepare an Operational Noise Report to document this monitoring. The Report must include, but not be limited to:</p> <p>(a) noise monitoring to assess compliance with the operational noise levels predicted in the Noise and Vibration Impact Assessment, dated 5 August 2019 and prepared by Acoustic Studio;</p> <p>(b) a review of the noise levels from the opening of Magill Street in terms of the criteria established in the NSW Road Noise Policy (DECCW, 2011);</p> <p>(c) methodology, location and frequency of noise monitoring undertaken, including monitoring sites at which project noise levels are ascertained, with specific reference to locations indicative of impacts on sensitive receivers;</p> <p>(d) details of any complaints and enquiries received in relation to operational noise generated by the development between the date of commencement of operation and the date the report was prepared;</p> <p>(e) any required recalibrations of the noise model taking into consideration factors such as actual traffic numbers;</p> <p>(f) an assessment of the performance and effectiveness of applied noise mitigation measures together with a review and if necessary, reassessment of all mitigation measures; and</p> <p>(g) mitigation measures, if monitoring undertaken in accordance with this condition identifies that the noise criteria determined in accordance with the NSW Road Noise Policy (DECCW, 2011) is exceeded, including architectural treatment. These mitigation measures must be offered to affected residences.</p>	Within 6 months of operation		Principal/LHD/UNSW	TBD	TBD	Not triggered
----	---	------------------------------	--	--------------------	-----	-----	---------------

**Randwick Campus Redevelopment**

E6	The Applicant must provide the Planning Secretary with a copy of the Operational Noise Report referred to in condition E5 and install any additional noise mitigation measures required in accordance with condition E5(g) (where accepted) within one month of completing the operational noise monitoring referred to in condition E5.	Within 1 month of completing noise monitoring	Provide to Planning Secretary	HI/LHD/Contractor	TBD	TBD	Not triggered
<b>Green Travel Plan</b>							
E7	A final/revised Green Travel Plan is to be submitted to the Planning Secretary within 18 months of occupation. The final Green Travel Plan should include consideration of journey to work patterns and behaviours identified by a staff/students/visitor travel survey taken during the first 12 months of opening of the institution.	Post Occupation - 18 months	GTP submitted to Planning Secretary	LDH/UNSW	TBD	TBD	Not triggered
E8	The Green Travel Plan required by condition D9 of this consent must be updated annually and implemented unless otherwise agreed by the Planning Secretary.	Post Occupation		LDH/UNSW	To be updated annually	TBD	Not triggered

Randwick Campus Redevelopment

Traffic Management Plan							
E9	Within six months of commencement of operations, a Road Safety Audit must be undertaken by a suitably qualified and experienced person of the Hospital Road/Magill Street intersection in relation to vehicular, bicycle and pedestrian movements and if required, include mitigation measures to ensure the efficient operation of the intersection and safety for pedestrians and all road users, including cyclists. The Applicant must provide a copy of the Road Safety Audit to the Planning Secretary and implement any mitigation measures within 12 months of commencement of operations, or unless otherwise agreed by the Planning Secretary.	Within 6 month of operation	Copy of Planning Secretary	HI/LHD/Contractor	Provision of Road Safety Audit.	Submission of Road Safety Audit to Planning Secretary.	Not triggered
Ecologically Sustainable Development							
E10	Unless otherwise agreed by the Planning Secretary, within six months of commencement of operation, Green Star certification must be obtained demonstrating the development achieves a minimum 4 star Green Star Design & As Built rating. If required to be obtained, evidence of the certification must be provided to the Certifier and the Planning Secretary. If an alternative certification process has been agreed to by the Planning Secretary under condition B8, evidence of compliance of implementation must be provided to the Planning Secretary and Certifier.	Within 6 month of operation	Copy to Planning Secretary	Contractor		Provide evidence of implementation of alternative HI ESD strategy.	Not triggered
Outdoor Lighting							
E11	Notwithstanding condition B9, should outdoor lighting result in any residual impacts on the amenity of surrounding sensitive receivers, the	Post Occupation		Contractor	Note	TBD	Not triggered

## Randwick Campus Redevelopment

	Applicant must provide mitigation measures in consultation with affected landowners to reduce the impacts to an acceptable level.						
<b>Landscaping</b>							
E12	The Applicant must maintain the landscaping and vegetation on the site in accordance with the approved Landscape Management Plan required by condition B23 for the duration of occupation of the development.	Post Occupation		LHD/UNSW	Note	TBD	Not triggered
<b>Hazards and Risk</b>							
E13	The Applicant must store all chemicals, fuels and oils used on-site in accordance with: (a) the requirements of all relevant Australian Standards; and (b) the EPA's Storing and Handling of Liquids: Environmental Protection – Participants Manual' if the chemicals are liquids.	Post Occupation		LHD/UNSW	Note	TBD	Not triggered
E14	In the event of an inconsistency between the requirements of condition E13(a) and E13(b), the most stringent requirement must prevail to the extent of the inconsistency.	Post Occupation		LHD/UNSW	Note	TBD	Not triggered
<b>Dangerous Goods</b>							
E15	Dangerous goods, as defined by the Australian Dangerous Goods Code, must be stored and handled strictly in accordance with: (a) all relevant Australian Standards; (b) for liquids, a minimum bund volume requirement of 110% of the volume of the largest single stored volume within the bund; and (c) the Environment Protection Manual for Authorised Officers: Bunding and Spill Management – technical bulletin (EPA, 1997). (d) The Applicant must ensure that the dangerous goods quantities at any time within the development and transported to and from the development will not exceed the screening threshold quantities listed in the Department's Hazardous and Offensive Development Guidelines, Applying SEPP 33.	Post Occupation		LHD/UNSW	Note	TBD	Not triggered

**Randwick Campus Redevelopment**

E16	In the event of an inconsistency between the requirements E15 (a) to E15(c), the most stringent requirement must prevail to the extent of the inconsistency.	Post Occupation		LHD/UNSW	Note	TBD	Not triggered
<b>External Signage</b>							
E17	The signage types and locations are to be consistent and integrated with the Acute Services Building and in accordance with the signage examples in the Architectural Design Statement prepared by BVN Terroir dated 23 October 2019 Revision 10.	Post Occupation		LHD/UNSW	Note	TBD	Not triggered



Randwick Campus Redevelopment

**SCHEDULE 3 - MODIFICATION TO SSD 9113**

**Design Modifications**

	<p>Prior to the opening of Magill Street, a boom gate is to be installed at the eastern end of Magill Street to close access to Hospital Road between 10pm and 7am seven days. Details of the bollards boom gate, including its design and operation are to be developed in consultation with Council and submitted to the satisfaction of the Planning Secretary prior to installation.</p>					<p>Submission to Planning Secretary prior to installation outstanding.</p> <p>Randwick City Council – Date 1 Apr 2020 - Meeting Minutes 010 Item – Design 5.2 – Magill Street Boom Gate – <b>RCC confirmed support of the layout and single boom gate option.</b></p> <p>Modification Notification submitted to DPIE 29-6-20 Reference : Letter from Claire Muir of HI Filename: SSD9113 POW ASB Mod Notification Cover Letter. Pdf. Consolidated consent was issued DPIE requested the post approval document from the notification also be submitted against A32 of SSD10339.</p>	
<p><b>A15</b></p>	<p>Signage is to be installed at the entry to Magill Street from Botany Street and the Emergency Department access to notify traffic travelling towards Hospital Road through Magill Street that access to Hospital Road is closed between 10pm and 7am seven days a week except to emergency vehicle. The signage is to be designed in consultation with Council and TfNSW (RMS) and submitted to the satisfaction of the Planning Secretary prior to installation.</p>	<p>Construction</p>	<p>Submitted to Planning Secretary prior to installation</p>	<p>Contractor</p>	<p>Record keeping/ consultation notes with Council</p>	<p>DPIE confirmed receipt by email dated 1//7/20 to HI Filename: Prince of Wales Hospital - Addition to approved Acute Services Building - Post Approval Document Received - (SSD-10339-PA-10).eml</p> <p>Hence documentation was lodged against SSD9113 &amp; subsequently against SSD10339 as per request from DPIE Post Approval Team.</p> <p>Evidence of consultation requested by DPIE below:</p> <p>RCC Coordination Meeting – Date 7 Oct 2020 - Meeting Minutes 016 Item – Previous Actions 2.4 Filename: 200107 - RCC Coord Meeting - Meeting 016 – Minutes also Meeting – Date 4 Nov 2020 - Meeting Minutes 017 Item – Previous Actions 2.4 Filename: 2001103 - RCC Coord Meeting - Meeting 017 - Minutes</p>	<p>Not triggered</p>

Randwick Campus Redevelopment

						DPIE seeking confirmation from RCC.	
--	--	--	--	--	--	-------------------------------------	--

**APPENDIX 2 WRITTEN INCIDENT NOTIFICATION AND REPORTING REQUIREMENTS**

**Written Incident Notification Requirements**

1	<p>A written incident notification addressing the requirements set out below must be emailed to the Planning Secretary at the following address: <a href="mailto:compliance@planning.nsw.gov.au">compliance@planning.nsw.gov.au</a> within seven days after the Applicant becomes aware of an incident. Notification is required to be given under this condition even if the Applicant fails to give the notification required under condition A24 or, having given such notification, subsequently forms the view that an incident has not occurred.</p>	<p>Within 7 days of being aware of incident.</p>	<p>issued to Planning Secretary</p>	<p>Contractor</p>	<p>Record keeping of communications</p>	<p>Provide written incident notification addressing the requirements and email to the Planning Secretary</p>	<p>Not triggered</p>
2	<p>Written notification of an incident must:</p> <ul style="list-style-type: none"> <li>a. identify the development and application number;</li> <li>b. provide details of the incident (date, time, location, a brief description of what occurred and why it is classified as an incident);</li> <li>c. identify how the incident was detected;</li> <li>d. identify when the applicant became aware of the incident;</li> <li>e. identify any actual or potential non-compliance with conditions of consent;</li> <li>f. describe what immediate steps were taken in relation to the incident;</li> <li>g. identify further action(s) that will be taken in relation to the incident; and</li> <li>h. identify a project contact for further communication regarding the incident.</li> </ul>	<p>At any time</p>		<p>Contractor</p>	<p>Note</p>	<p>Note</p>	<p>Not triggered</p>

**Randwick Campus Redevelopment**

3	Within 30 days of the date on which the incident occurred or as otherwise agreed to by the Planning Secretary, the Applicant must provide the Planning Secretary and any relevant public authorities (as determined by the Planning Secretary) with a detailed report on the incident addressing all requirements below, and such further reports as may be requested.	Within 30 days of incident occurring	Issued to Planning Secretary	Contractor	Record keeping of communications	Provide Planning Secretary and any relevant public authorities with a detailed report on the incident addressing all requirements.	Not triggered
4	The Incident Report must include: a. a summary of the incident; b. outcomes of an incident investigation, including identification of the cause of the incident; c. details of the corrective and preventative actions that have been, or will be, implemented to address the incident and prevent recurrence; and d. details of any communication with other stakeholders regarding the incident.	At any time		Contractor	Note	Note	Not triggered

